

Rd #

Rd #59

Report, Survey and Plat of Road from State Line 3
 30
Huston & Summerville Road.

To the Honorable County Court of Wasatch County State of Oregon.
 We the appointed viewers Joseph Hood
 Lewis Bowler and H. B. Stubbell appointed to view a County
 Road commencing at a point on the Oregon State Line 16 rods E. of
 80th mile post and terminating at a certain point on the Summerville
 & Huston Road being disinterested persons in the location
 of said road, met according to appointment at the house of John
 Knight on the 20th day of March A.D. 1878 and after having first
 been duly qualified, have carefully examined and reviewed
 said line as called for in said petition and order of review
 and find said road to be of public utility and on a good prac-
 ticable route and much needed as a public thoroughfare, and
 we recommend the location of said road, and that we have
 each served the term of three days in said employment for
 which we claim the lawful fee } Joseph Hood
 Done this 22nd day of March A.D. 1878 } Lewis Bowler
 Wasatch Co. Oreg. } H. B. Stubbell

The viewers met according to appointment having procured a
 marker and two chain-carriers and a man and team to haul,
 stakes proceeded to locate a road as follows Initial point set
 post 18 rods East of 30th mile post on State Line run South
 200 rods, angle East 80 rods, angle South 7 East 40 Set first
 mile post same course 200 rods, angle East 40 rods, Set second
 mile post same course 40 rods, angle South 3 East 200 rods
 set third mile post, same course 120 rods, angle South 2 West
 200 rods, Set fourth mile post, same course 42 rods angle
 South 3 East 46 rods, angle South 2 West 160 rods angle South
 72 rods Set fifth mile post, same course 320 rods Set sixth
 mile post same 120 rods angle South 1 West 58 rods, angle
 South 35 West 62 rods angle South 49 West 20 rods angle South
 14 West 44 rods, angle South 31 East 16 rods Set seventh mile
 post same course 34 rods, angle South 5 West 52 rods, angle
 South 54 East 28 rods angle South 64 East 20 rods here cross
 Hulla Hulla River angle South 15 East 60 rods angle South

RD # 59

70 East 40 rods angle South 87 rods 72 rods angle South 87 East
 6 rods set eighth mile post same course 40 rods angle South 87
 East 74 rods angle South 79 East 64 rods angle South 51 East
 12 rods angle South 84 East 46 rods angle South 44 East, 34 rods
 angle South 34 East 20 rods set ninth mile post same course 60
 rods angle South 87 East 16 rods, angle South 44 East 88 rods
 angle South 36 East 122 rods angle South 48 East 34 rods set ten
 mile stake same course 80 rods angle South 55 East 168 rods, angle
 South 58 East 72 rods at eleventh mile post same course 60 rods
 angle South 73 East 120 rods angle South 25 East 60 rods angle
 South 76 East 88 rods angle North 57 East 12 rods set 12 mile post
 same course 54 rods angle South 62 East 126 rods angle South 73
 East 140 rods set thirteenth mile post, same course 100 rods, angle
 South 58 East 80 rods angle South 68 East 140 rods fourteenth
 mile post same course 100 rods angle South 54 East 220 rods
 set fifteenth mile post angle South 29 East 150 rods angle South
 55 East 120 rods angle South 40 East 50 rods set sixteenth mile
 post same course 108 rods, angle South 1 East 87 rods angle
 South 42 East 100 rods, set seventeenth mile post angle South
 38 East 106 rods angle South 40 East 144 rods angle South 69
 East 70 rods, set eighteenth mile post same course 80 rods
 angle South 52 East 194 rods angle South 21 East 40 rods set
 nineteenth mile post same course 198 rods angle South 67 East
 102 rods angle South 58 East 20 rods marked pine tree for twen-
 tieth mile post angle South 41 East 40 rods angle South 20
 East 26 rods angle South 49 East 34 rods angle South 26 rods
 80 rods angle North 71 East 40 rods at which point the road ter-
 minates being twenty miles and two hundred and twenty six
 rods in length an angle Post was set at each angle number RA

Wm. M. Hillis

Surveyor.

Rd #59

Plat of Road from State Line
 to
Blue Mountains
 Mrs. M. Hillis
 Surveyor

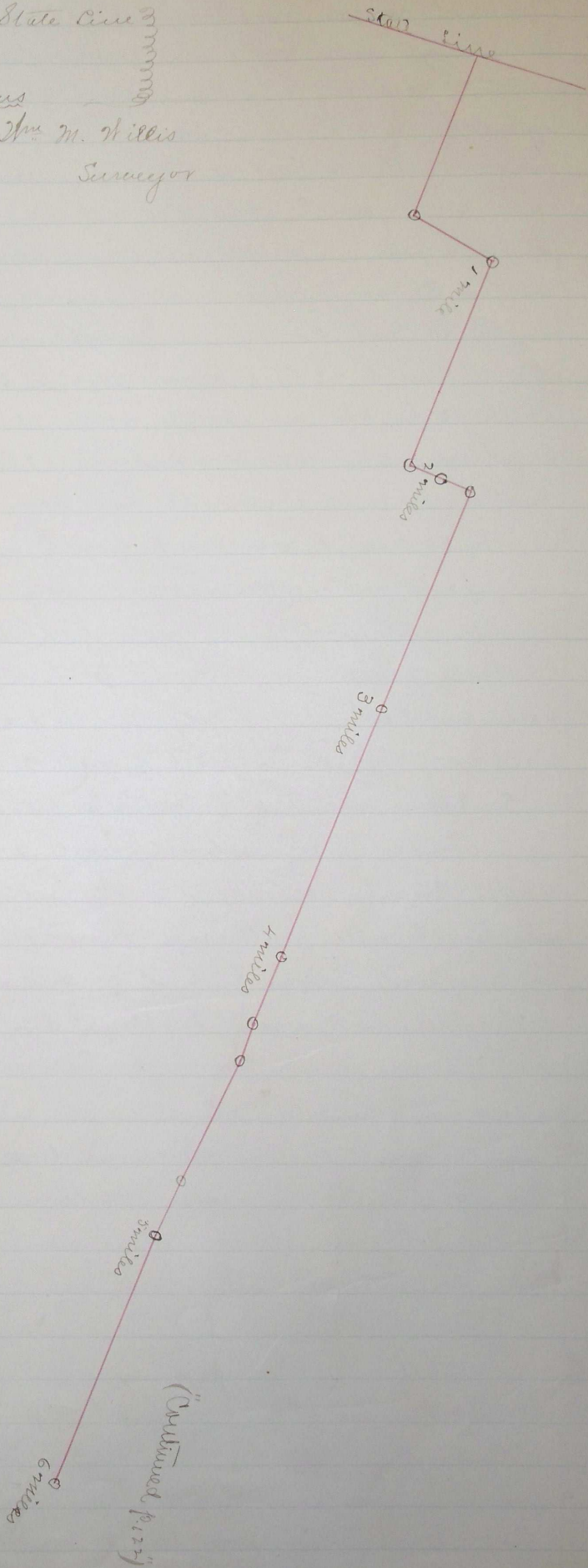

Plot of Road from State Line
to
Blue mountains (Continued)

Ed #59

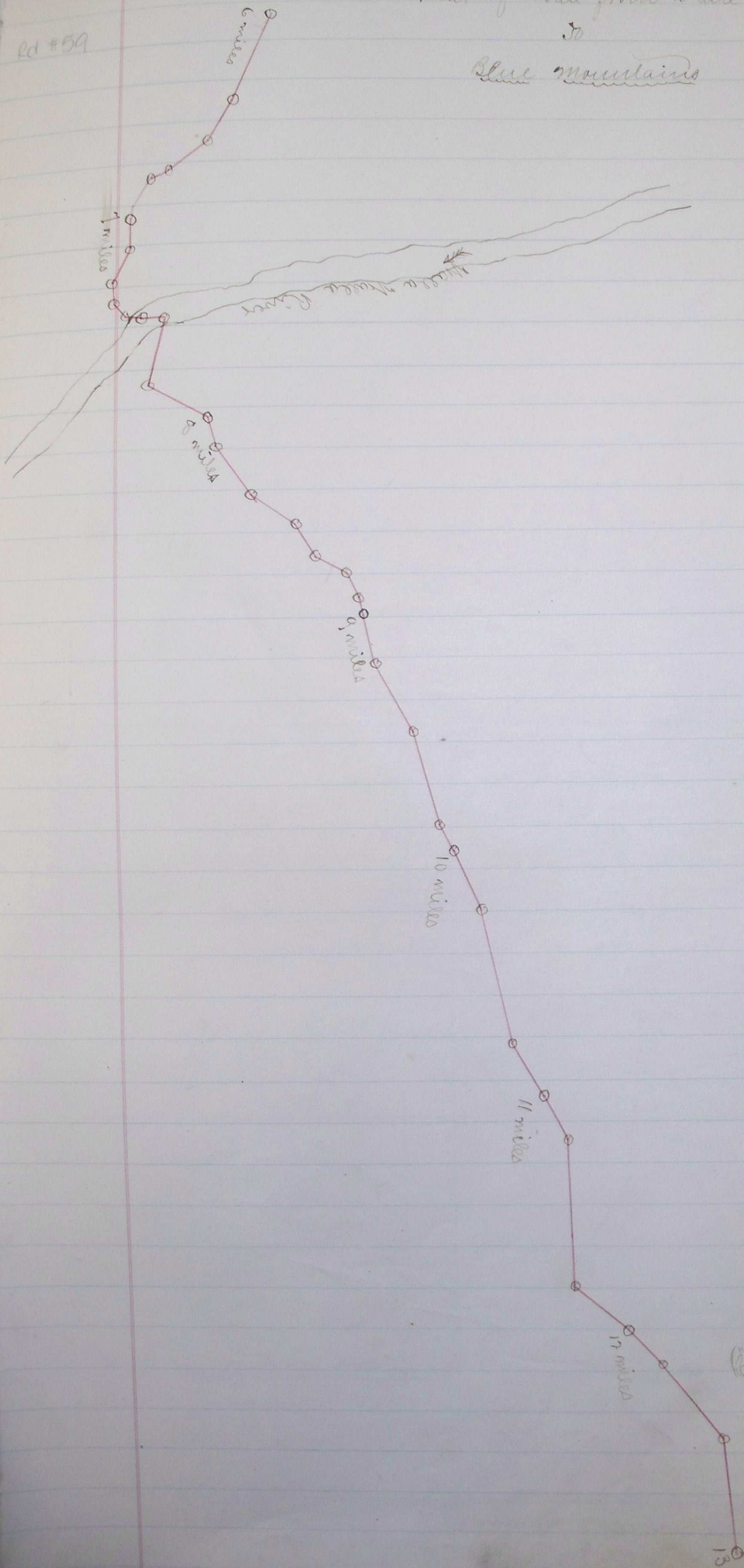

(Continued p. 124)

Part of Road from State Line
to
Blue Mills.

(Continued)

Rd #59

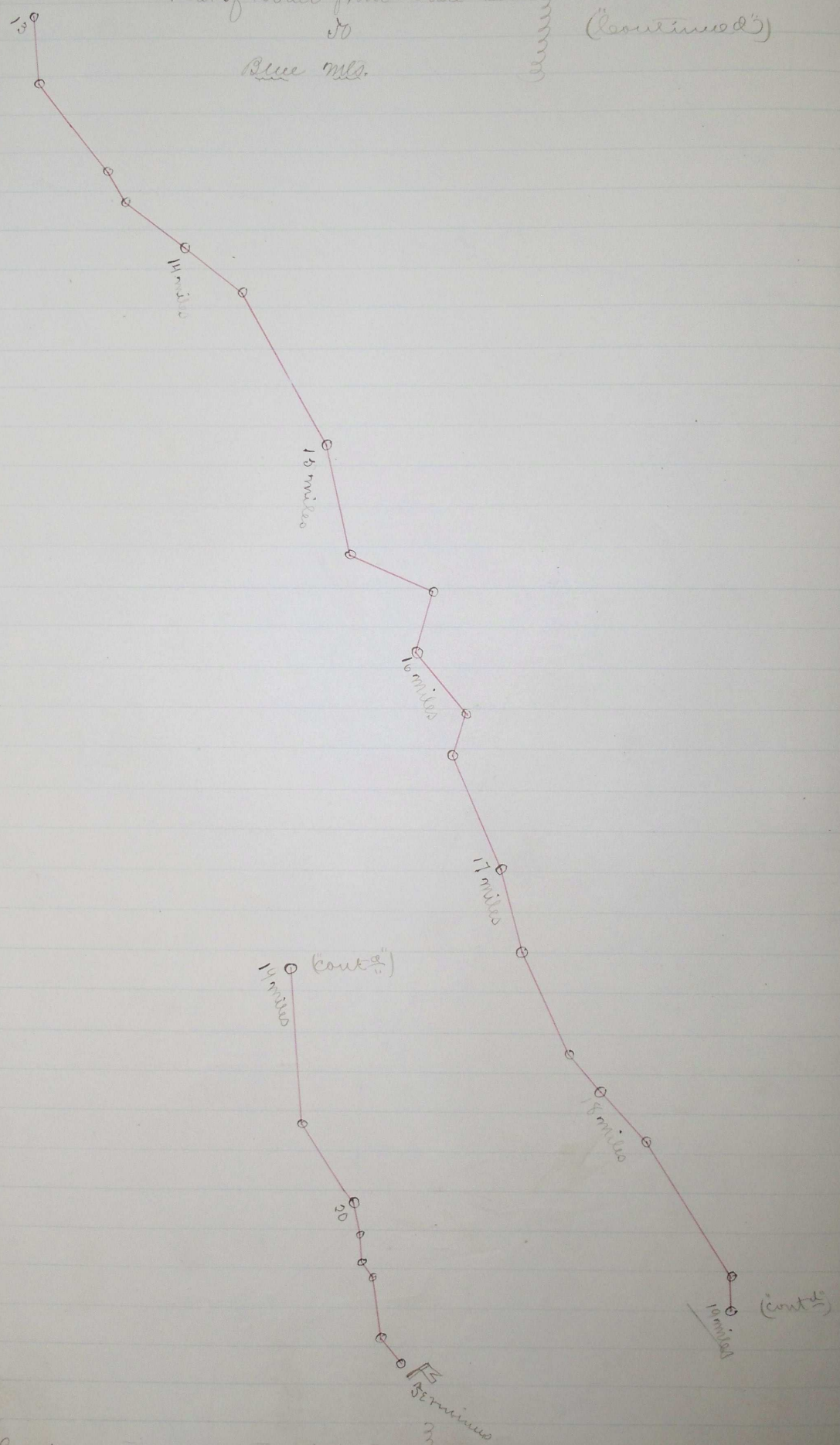

Road granted and located April 7th 1876
See ss. Court Journal "6" page 199