

Road No 299

Report of Viewers. Field Notes^{and} Plat of Survey of a County Road
beg. at the S.W. cor. of Sec. 6. T⁵ N. R 36 E. W. m. ^{and} ending at the N.E. cor.
of Sec 3 in T⁵ N. R 36 E.

Report of Viewers.

To the Hon. County Court for Umatilla County, Oregon.

We the undersigned viewers on road No 299. for the County
of Umatilla^{and} State of Oregon, would respectfully report that we met
with the County Surveyor on the day^{and} at the place specified in
our notices of appointment as viewers above described, ^{and} pro-
ceeded to view out^{and} survey said road as described in said no-
tices; we find the road located on good ground, excepting about
the last one thousand feet which crosses a gulch^{and} ascends
hill; the road is located on section^{and} subdivision lines^{and} is
very much needed, as it ties two roads^{and} furnishes oppor-
tunity to reach prominent points by a route at least five miles
shorter than the one now necessarily traveled. therefore we
would recommend that the Prayer of the petitioners for road No
299 be granted^{and} that said road be declared a public highway.

Witness our signatures this 27th day of August 1887.

W. S. Frazier

A. M. Elam

P. M. Gerking

} Viewers No 299

Field Notes of Road Survey No 299. for Umatilla Co. Or.

I met A. M. Elam, Peter Gerking^{and} W. S. Frazier, viewers on
County road No 299, at Milton, Or. Friday August 26th 1887. Harvest-
ing rendering a scarcity of laborers, A. M. Elam^{and} Peter Gerking,
chose to act as chainmen^{and} W. S. Frazier as marker, I qualified
each for his particular calling, as directed by law, ^{and} set
initial post in mound 28 feet S.W. of corner for Sec. 1. 6. 7 & 12 on
T⁵ N. line bet. Rgs. 35 & 36 E. T⁵ N.

I run thence (Var. by sun N. 20° E.

East	ft.	On true line bet. Secs. 6 & 7 S. T ⁵ N. R 36 E.
	550	Descend
	850	Ravine N & S - 10'
	2510	1/4 S. Cor. bet. Secs 6 & 7
	5202	Int. N & S line at Cor. for Sec. 5. 6. 7 & 8 Set angle stake 20' south of point. Thence North on true line bet. Secs 5 & 6
	5280	Set 1 m. post 20' East of line, ^{and} continue course.
North	150	Descend
	300	Ravine N. W. - 6'; Ascend
	500	Summit.

- 1250 $\frac{1}{4}$ of $\frac{1}{4}$ on $\frac{1}{2}$ of line bet. Secs. 5 & 6.
Turn thence east on sur. section line.
- 3050 Descend
- 3100 Ravine N. W. - 8'; Ascend
- 3350 Summit.
- 4600 Descend
- 4750 Ravine N. W. - 10'
- 5280 Set 2 m. post 20' south of line in N. Pierce's field
- 320 Intersect road in lane about the center of SE $\frac{1}{4}$ Sec. 5.
Thence, in lane, along W. W. road (angle stake against fence 20' E)
- N $32^{\circ} 30' W$ 1850 Descend
- 2000 Ravine N. W. - 6'
- 2150 Set angle stake 15' E. of Pt. at fence on E. side of lane.
Turn along W. W. wagon road
- N $1^{\circ} 45' W$ 4307 Line bet. Tps. 5 & 6 N.
Set angle stake against fence on W side of lane
Thence East on Tp. line, bet. Tps. 5 & 6 N. R 36 E.
- 5280 Set 3 mile post 20' south of line.
ft. Continue course on Tp. line
- East 1650 Mrs. Milkie Gates barn S. of line about 35'
- 5280 Set 4 mile post about 30' south of line.
Continue course on Tp. line
- " 930 Gulch N. W. - 5'
- 1330 Draw do
- 1988 Road in lane N. & S.
- 4850 Descend
- 4890 Gulch N. W.; Ascend abruptly + 20'
- 5280 Set 5 m. post 20' south of line, ascend
- 696 Stone Cor. in mouth of lane N.
- 710 Fence on E. side of lane; Set terminus 20' E of
stone cor.

I hereby certify that the foregoing are the
correct Field Notes of the survey of Road No 299, for
Umatilla County, Oregon.

Jno. C. Arnold,
Surveyor.

Plat of Road No 299
for Umatilla Co. Or.

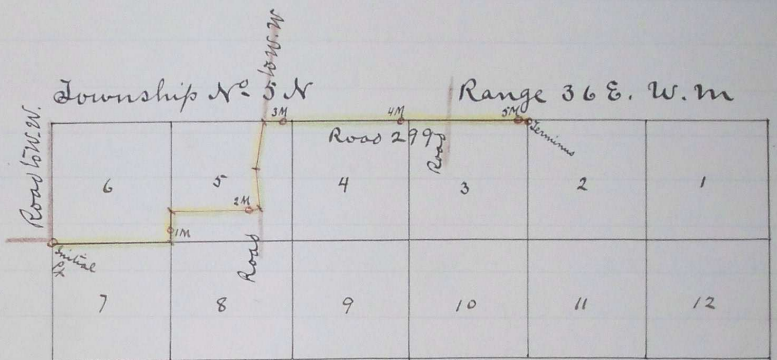

I hereby certify the foregoing to be a
correct plat of County road No 299.
Jno. C. Arnold,
Surv.

Journal G. page 582
" " " 630
Road Granted Sept 26 1887
Recorded Jan 18 1888
L. A. Hartman
Clerk
By J. H. Parker
deputy