

ROAD NO

352.

Road No 352.

Report of Viewers, field notes and plat of survey of Road No 352 in Umatilla County, Oregon, Commencing at the cross West corner of Section 30 in Township 6. NR 35 E 10W, running thence South 8 rods and $3\frac{1}{2}$ ft, thence East $3\frac{1}{2}$ mile, thence South One fourth mile, thence East $\frac{1}{2}$ mile, thence South $\frac{1}{4}$ mile, thence East $3\frac{1}{4}$ mile or l, to intersection of a County Road leading from Milton Oregon to Hudson Bay known as the Hudson Bay Road.

Report of Viewers

To the Honorable County Court of Umatilla County, State of Oregon.

We the undersigned a majority of the viewers appointed by your Honorable body to view survey, locate and report on proposed road No 352 as prayed for by petition of J. C. Hodgson and (18) others beg leave to report to your Honorable body, that we met J. H. Lawrey surveyor at Milton on the 26th day of January 1891 and duly qualified and calling to our aid J. W. Dykes and A. A. Adams as chainmen and markers who were duly qualified.

We proceeded to view, ^{survey and} locate said proposed road as directed by your Honorable Body and we most earnestly recommend that said road be established and opened as a County Road for the following reasons,

- 1st The location is good.
- 2nd There is no County road in the neighborhood the public being compelled to travel by ways through fields gates and bars and therefore said road would be of much public utility and is greatly needed.

"This 26th day of Jan. 1891.

Said by 26-1891
Members

Wm M. Steen
George De Haven

Field Notes of Road Survey No 352 Umatilla County Oregon
I met Wm M. Steen and George De Haven viewers at Milton Monday Jan 26th 1891 and called A. A. Adams and James Dyke to act as chainmen and markers each of whom was duly qualified as directed

at plat
2-1891

by law.
 Initial post at NW cor Sec 30 Tp 6 NR. 35 E. 10m,
 then run 81 rods South and set angle post then
 East three fourth of a mile and setting angle post run
 South one fourth of a mile, set angle post and run
 East one fourth of a mile and setting angle post
 run South one fourth of a mile. set angle
 post and run East five thousand two hundred
 and seventy seven 5277 feet to intersection
 of Hudson Bay road,

Filed July 26 1891
 W. M. Pierce Clerk

J. W. Lawray
 Surveyor

ROAD NO
 354

I hereby certify the following to be a correct plat of the No 352 Road
 survey Tp 6. NR. 35 E. 10m. as made by me Jan 26 1891

J. W. Lawray Surveyor

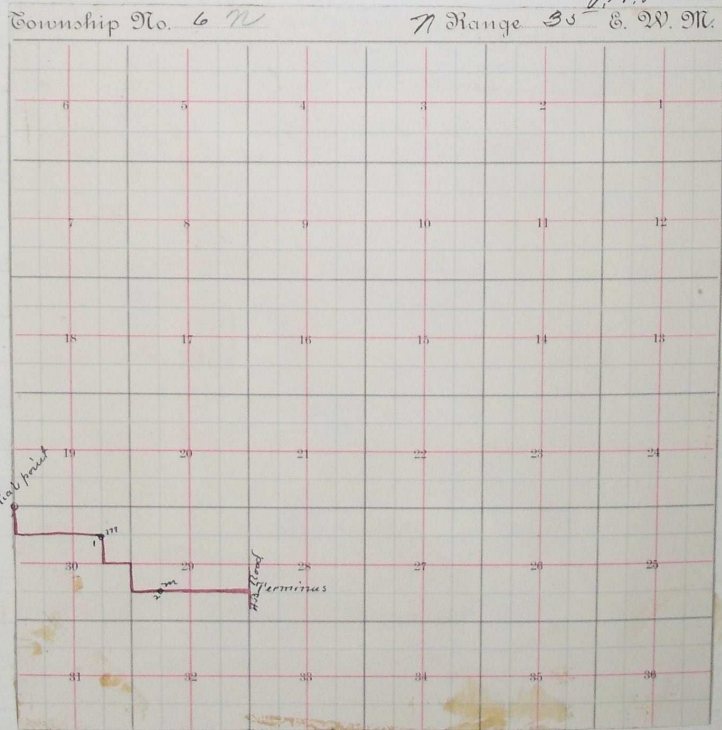

Filed July 26 1891
 W. M. Pierce Clerk

Jan 9 1891 H 653-710