

USDA-FOREST SERVICE

Index

File No. V-25

CORNER RECORD (SEARCH)

(Ref. FSM 7151.4)

Tract or Survey No. _____ Cor. No. NE

T 6 S R. 34 E

R.D. NORTH FORK JOHN DAY County Umatilla

Merid. Willamette

N.F. Umatilla State OREGON

CORNER DIAGRAM

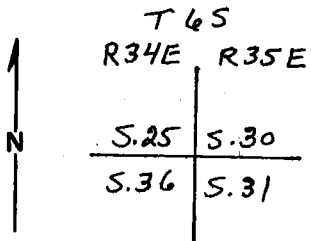

DESCRIBE CORNER MONUMENT FOUND

Stone 18"X12"X3" (20"X13"X5") w/7 fragments, pieced together I find 5 notches on North and 1 notch on South face.

DESCRIBE BEARING TREES OR OTHER OFFICIAL ACCESSORIES FOUND

- ① No trace of N.E. B.T.
- ② 16" D.B.H. (12") Tamarack, S. 52° E., 139 LKS., w/opened face, no marks. Blaze below, grown shut.
- ③ S.W. B.T. only charred wood remains.
- ④ N.W. B.T., Rotten Remains of stump, N. 70° W., 4 LKS.

PHOTO IDENTIFICATION DATA

Photo No. _____

Filed At. _____

Object Ident. _____

Ident. By _____

Signature

DESCRIBE CORNER LOCATION RELATIVE TO NEAR-BY FEATURES, ALSO HOW TO REACH CORNER

Take Road 5226 To Tag on left, go south to corner.

PLANE COORDINATE POSITION DATA

State _____ Zone _____

X _____

Y _____

Estab. By _____

Agency

Signature *Day to J. M. ...* Title Land Surveyor Division _____ Headquarters _____ Date 10/24/86

CORNER RECORD (PERPETUATION)

MONUMENT: DESCRIBE NEW MONUMENT SET, OR WORK DONE TO PRESERVE EXISTING MONUMENT

Set a $2\frac{1}{2}$ " Diam. Alum. Cap on a $2\frac{1}{2}$ " X 30" Alum. Pipe w/f/ared bottom at corners and buried cornerstone and fragments along pipe. Cap MKD. Per sketch. Set steel posts 4"± N. & S. w/Attn. & Mon. signs attached.

T 6 S	
R 34 E	R 35 E
5.25	5.30
5.34	5.31
RPLS 1910 1986	

9

ACCESSORIES: DESCRIBE NEW BT'S WITNESS OBJECTS ETC. ESTABLISHED, OR WORK DONE TO PRESERVE EXISTING EVIDENCE

- ① 5" DBH. White Fir, N. 61° E, 21.3', scribed "X" BT.
- ② 15" DBH. TAMARACK, N. 81° W., 36.5', scribed T6SR34ES25BT.
- ③ 20" DBH. Douglas Fir, S. 14 $\frac{1}{2}$ ° W., 31.7', scribed T6SR34ES36BT
- ④ 16" DBH Douglas Fir, S. 51 $\frac{1}{2}$ ° E., 76.6' scribed T6SR35ES31BT.

Each B.T. has a brass washer mkd. RPLS 1910 set btwn. B.&T. All B.T's. have B.T. Tags, Attn. signs, Bands & Faces painted red.

10

Work Done By C.J. Martin Title Land Surveyor Date 10/25/86 State Registration No. LS 1910
or Agency

Certified Cor. Record Prepared? Yes No Filed At: _____ Date _____

11

REMARKS

12

Index File No. V-25 T. 6S R. 34E M. Willamette Tract or Surv. No. Cor. 25/30
36/31

13

USDA-FOREST SERVICE

Index
File No. V-25

CORNER RECORD (SEARCH)
(Ref. FSM 7151.4)

Tract or
Survey No. _____
Cor. No. _____

T 65 R. 34E

R.D. DALE County ~~Grant~~ UMATILLA

Merid. Will

N.F. UMATILLA State OREGON

CORNER DIAGRAM

T65

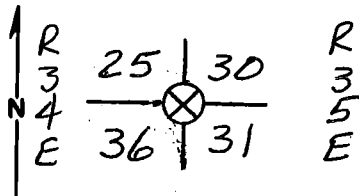

DESCRIBE CORNER MONUMENT FOUND

ORIG. CORNER STONE IS SOLIDLY SET IN AN UPRIGHT POSITION. TOP IS BROKEN. I PIECE THE STONE TOGETHER & FIND 5 GROOVES ON THE NORTH FACE & ONE GROOVE ON THE SOUTH FACE.

DESCRIBE BEARING TREES OR OTHER OFFICIAL ACCESSORIES FOUND

ORIG. 18" FIR IS DOWN & DECAYED. I FIND AXE MARKS & CHARRED FACE. STUMP BEARS N70°W, 2 1/2 FT. A CHARRED & DECAYED LOG IS IN POSITION OF ORIG. S.W. B.T. NO MARKS VISIBLE. I OPEN A TAMARACK AT APPROX. LOCATION OF ORIG. SE BT, BUT FIND NO MARKS. ORIG. DISTANCE HARD TO

DESCRIBE CORNER LOCATION RELATIVE TO NEAR-BY FEATURES, ALSO HOW TO REACH CORNER

READ IN ORIG. NOTES. THERE ARE SEVERAL TREES IN IMMEDIATE VICINITY OF CORNER WHICH ARE BLAZED FACING THE CORNER.

PHOTO IDENTIFICATION DATA

Photo No. _____
Filed At. _____
Object Ident. _____
Ident. By _____
Signature _____

PLANE COORDINATE POSITION DATA

State _____ Zone _____
X _____
Y _____
Estab. By _____
Agency _____

Signature

Title

Division

Headquarters

Date

Dennis T. Layford PLS 1636 SO 8/30/84 7100-52-(3.68)

CORNER RECORD (PERPETUATION)

MONUMENT: DESCRIBE NEW MONUMENT SET, OR WORK DONE TO PRESERVE EXISTING MONUMENT

ACCESSORIES : DESCRIBE NEW BT's WITNESS OBJECTS ETC. ESTABLISHED, OR WORK DONE TO PRESERVE EXISTING EVIDENCE

Work Done By _____ **Title** _____ **Date** _____ **State Registration No. or Agency** _____

Certified Cor. Record Prepared ? Yes No **Filed At:** _____ **Date** _____

REMARKS

Index File No. **T.** **R.** **M.** **Tract or Surv. No.** **Cor.**