

U. S. Department of Agriculture
FOREST SERVICE

NATIONAL FOREST

CORNERS OF THE PUBLIC SURVEY

T. 6 S R. 30 Mer.

Section Corner common to Sections
8, 9, 17, and 18

Corner consists of a Pine post (not) in place
State condition BT is good.

Dimensions above ground _____ inches.

Sketch grooves, letters, figures, or notches, on proper face or edge.

CARDINAL POSITION

DIAGONAL POSITION

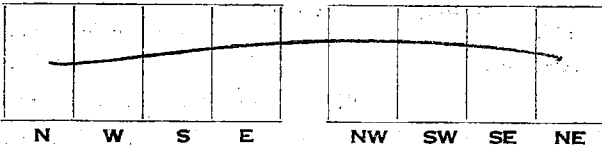

Mound of _____ is located _____

—Pits are located _____

Sketch markings of Bearing Trees (or Rocks) in proper box and fill blanks below, giving bearings from Corner to Trees and Distances in Links.

T65
R30E
Sec 8

X

T65
R30E
Sec 8

T65
R30E
Sec 16

BT

X

BT

BT

Species PP _____ PP _____ PP _____

Diameter 24 _____ 27 _____ 19 _____

Bearing _____ _____ _____

Distance 566.23 _____ _____

Do you believe this to be a genuine Land Office Corner? Yes

If not, why? _____

4/11/52 (Date) [Signature] (Title)

T. 65 R. R 30 N Mer.

(Make sketch of topography near Corner and show section line markers thus "X")

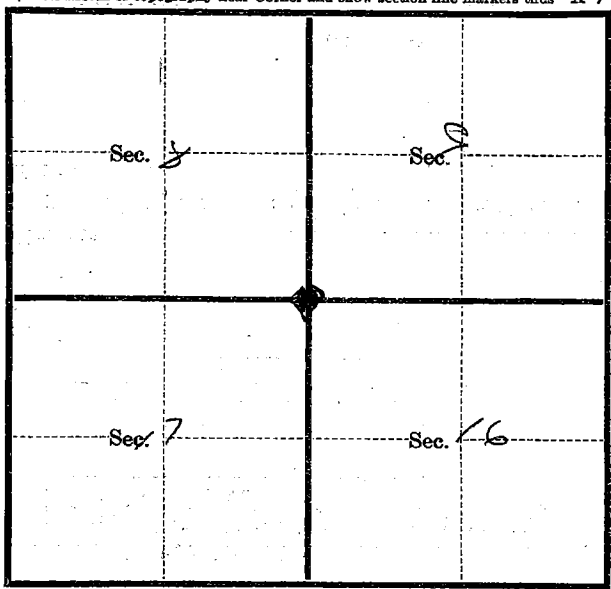

Metal Location Poster is on a Small DF tree
tree 2 inches diameter, on the North Corner

side of _____ from which
this Corner bears _____ Chains.
(Bearing) (Distance)

Section line marker between Secs. _____ and _____ is on
a _____ on the _____
(Tree, post, etc.) (Name of road, trail, etc.)

located _____ chains E, W, N, S, from Sec. Cor.; $\frac{1}{4}$ Cor.; Witness Cor.
(Cross out nonapplicable)

Give any further facts needed to find Corner again:
Corner in open meadow
since

Index File No. J-9

CORNER RECORD (SEARCH)
(Ref. FSM 7151.4)

Tract or Survey No. _____ Cor. No. _____

T 6S R. 30E R.D. _____ County _____

Merid. WILL N.F. _____ State OREGON

CORNER DIAGRAM

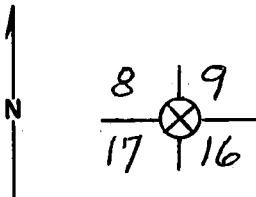

DESCRIBE CORNER MONUMENT FOUND

PINE POST

DESCRIBE BEARING TREES OR OTHER OFFICIAL ACCESSORIES FOUND

24" PONDEROSA PINE W/FULL SCRIBES IN S 8
AT 56 LKS
27" PONDEROSA PINE W/FULL SCRIBES IN S 8
22" PONDEROSA PINE W/FULL SCRIBES IN S 16

PHOTO IDENTIFICATION DATA

Photo No. _____
 Filed At. _____
 Object Ident. _____
 Ident. By _____
Signature

DESCRIBE CORNER LOCATION RELATIVE TO NEAR-BY FEATURES, ALSO HOW TO REACH CORNER

K TAG ON A 2" DOUG-FIR NEAR CORNER.

PLANE COORDINATE POSITION DATA

State _____ Zone _____
 X _____
 Y _____
 Estab. By _____
Agency

A.G. OARD

Title FORESTER

Division _____

Headquarters _____

Date 4/11/52

CORNER RECORD (PERPETUATION)

MONUMENT : DESCRIBE NEW MONUMENT SET, OR WORK DONE TO PRESERVE EXISTING MONUMENT

ACCESSORIES : DESCRIBE NEW BT'S WITNESS OBJECTS ETC. ESTABLISHED, OR WORK DONE TO PRESERVE EXISTING EVIDENCE

Work Done By _____ **Title** _____ **Date** _____ **State Registration No.**
or Agency _____

Certified Cor. Record Prepared ? Yes No **Filed At:** _____ **Date** _____

REMARKS

Index File No. **T.** **R.** **M.** **Tract or Surv. No.**

Cor.

13