

USDA-FOREST SERVICE

Index File No. A-5

CORNER RECORD (SEARCH)

(Ref. FSM 7151.4)

Tract or Survey No. _____ No. _____

T 05 R. 30E

R.D. UKIAH County _____

County UMATILLA

Merid. WILLAMETTE

N.F. UMATILLA State _____

State OREGON

CORNER DIAGRAM

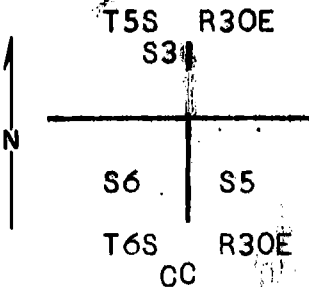

DESCRIBE CORNER MONUMENT FOUND

NONE

2

DESCRIBE BEARING TREES OR OTHER OFFICIAL ACCESSORIES FOUND

34th SNAG N25E SCRIBING CLEARLY VISIBLE
 STUMP S5³W SCRIBING VISIBLE
 STUMP S5⁰E SCRIBING VISIBLE

3

PHOTO IDENTIFICATION DATA

Photo No. _____

Filed At. _____

Object Ident. _____

Ident. By _____

Signature

7

PLANE COORDINATE POSITION DATA

State _____ Zone _____

X _____

Y _____

Estab. By _____

Agency

8

DESCRIBE CORNER LOCATION RELATIVE TO NEAR-BY FEATURES, ALSO HOW TO REACH CORNER

CORNER IS ON NORTH SIDE OF ROAD WHICH RUNS ON TOWNSHIP LINE.

4

Signature Wayne O Harris

Title PhS # 346

Division _____

Headquarters _____

Date _____

7100-52-(3/68)

5

CORNER RECORD (PERPETUATION)

MONUMENT: DESCRIBE NEW MONUMENT SET, OR WORK DONE TO PRESERVE EXISTING MONUMENT

SET A 2"x30" IRON PIPE WITH A BRASS-CAP MARKED:

CORNER MONUMENT IS SET IN MOUND OF STONES.

T5S R30E

S31

S6 S5

1978

T6S R30E

PLS 346

T6C

9

ACCESSORIES : DESCRIBE NEW BT'S WITNESS OBJECTS ETC. ESTABLISHED, OR WORK DONE TO PRESERVE EXISTING EVIDENCE

8" FIR S60E 49.5' MARKED: T6S R30E S5 CC BT

14" PINE S19W 137.4 MARKED T6S R30E S6 CC BT

ALL OLD BT'S HAVE A BEARING TREE TAG. THE NEW BT'S AND THE STANDING SNAG HAVE A RED PAINTED STRIPE, A BEARING TREE SIGN, AND AN ATTENTION SIGN. THE NEW BT'S ALSO HAVE BRASS WASHER STAMPED PLS 346 NAILED TO THE LOWER BLAZE. THERE ARE STEEL FENCE POSTS SET ON LINE NEAR THE CORNER.

10

Work Done By W.O. HARRIS Title _____ Date 9-7-78 State Registration No. PLS 346
or Agency _____

Certified Cor. Record Prepared? Yes No Filed At: _____ Date _____

11

REMARKS

THE ORIGINAL BEARING AND DISTANCES DO NOT MATCH UP WITH THE CURRENT ONES FOR THE CORNER SET:

18" PINE S59E 130Lks (85.8') BECOMES S59E 67.8

30" PINE S53W 61Lks (40.3') BECOMES S53W 42.0

30" PINE N25E 92Lks (60.7') BECOMES N25E 15.2'

12

Index File No.

T.

R.

M.

Tract or Surv. No.

Cor.

13

USDA-FOREST SERVICE

Index
File No. A-5

CORNER RECORD (SEARCH)
(Ref. FSM 7151.4)

Tract or
Survey No. _____
Cor. No. A-5

T 6S R. 30E

R.D. Ukiah County _____

Merid. Willamette

N.F. Umatilla State Oregon

CORNER DIAGRAM

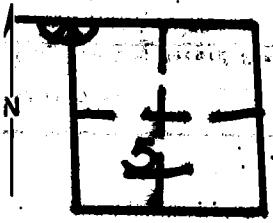

DESCRIBE CORNER MONUMENT FOUND

Material: none Size: none
Height Above Ground: None Condition: none
Markings: none

DESCRIBE BEARING TREES OR OTHER OFFICIAL ACCESSORIES FOUND

NE Quadrant - 24" P. pine snag 15' high with SW blaze, scribed: R30E T5S
5' SW of bearing tree is 8" P. pine with location poster on South side: Heppner Lumber Co, dated: 2/17/36 KMH
27' South of BT is East-West fence and primary East-West road.

PHOTO IDENTIFICATION DATA

Photo No. _____
Filed At. _____
Object Ident. _____
Ident. By _____
Signature

DESCRIBE CORNER LOCATION RELATIVE TO NEAR-BY FEATURES, ALSO HOW TO REACH CORNER

PLANE COORDINATE POSITION DATA

State _____ Zone _____
X _____
Y _____
Estab. By _____
Agency

Signature
Anna

Title _____ Division _____ Headquarters _____
Eng. Tech.

Date
10/76

7100-52 (3/68)

CORNER RECORD (PERPETUATION)

 MONUMENT: DESCRIBE NEW MONUMENT SET, OR WORK DONE TO PRESERVE EXISTING MONUMENT

9

 ACCESSORIES : DESCRIBE NEW BT'S WITNESS OBJECTS ETC. ESTABLISHED, OR WORK DONE TO PRESERVE EXISTING EVIDENCE

1 placed blank FS bearing tree poster on the BT. Priority one.

10

 Work Done By _____ Title _____ Date _____ State Registration No. _____
 or Agency _____

 Certified Cor. Record Prepared ? Yes No Filed At: _____ Date _____ 11

REMARKS

12

 Index File No. T. R. M. Tract or Surv. No. Cor. 13
