

LAND CORNER RECORD

5680-2

1. T. 6S R. 29E No. A-25 Cor. Sec. Mer. W. State Oregon (Rectangular) N. F. Umatilla Dist. Ukiah 2

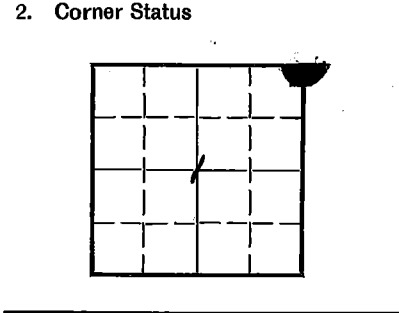

3. Original Description yes Vol. Page 145 Where Recorded

4. Description of Corners: Corner is a post from which a:
 Pine 18" Brs. N. 18°E. 132 lks.
 Pine 10" Brs. S. 18°W. 21 lks
 Pine 12" Brs. S. 77°E. 132 lks

see mon. file, Brass Cup

7. Photo Identification
 Photo No. EBI 7-54
 Ident. By: KJ

5. Investigation Notes: Cor. post gone, Sec. 6 B.T. 18½" vigorous.
 Painted red ring placed form 54-23
 Sec. 36 B.T. 20" vigorous painted red ring and placed form 54-3.
 Sec. 1 B.T. down-scribing visible on all trees. Fence attached to Sec. 6 and Sec 1 B.T. to reach corner from Divided Well Drive. 1½ mile south on S. 415 thence west on road adjacent to fence for one mile to corner. Road bows away from fence at corner.

8. Plane Coordinate Position Data
 State Zone
 X
 Y
 Estab. By
 Field Book No.
 Where Filed

9. Evaluation
 Authentic
 Needs Verif. Monument No
 Re-estab. X Survey
 Land Status

6. Signed L.B. Brunkow Title Survey Tech. Date 6-1-65

PERPETUATION RECORD

10. Monument:

11. Accessories

Field Book _____ Page _____

12. Set By _____ Title _____
License _____ Agency _____ Date _____

13. Recorded By _____ Volume _____ Page _____
(Agency)
(Date) (City) (County) (State)

14. Remarks:

A-25

Index
File No. A-1

CORNER RECORD (SEARCH)
(Ref. FSM 7151.4)

Tract or
Survey No. _____ Cor. No. A-1

T 6S R. 30E
Merid. W11

R.D. VK19h County Morrow-Umatilla Co.
N.F. Umatilla State Oregon Line

CORNER DIAGRAM

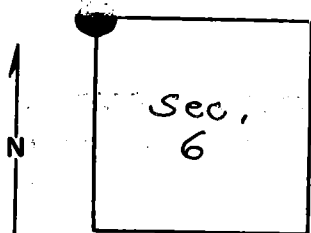

DESCRIBE CORNER MONUMENT FOUND

Brass Cap monument.
see A-25, T6S, R29E, monumentation file.

DESCRIBE BEARING TREES OR OTHER OFFICIAL ACCESSORIES FOUND

PHOTO IDENTIFICATION DATA

Photo No. _____
Filed At. _____
Object Ident. _____
Ident. By _____
Signature

DESCRIBE CORNER LOCATION RELATIVE TO NEAR-BY FEATURES, ALSO HOW TO REACH CORNER

PLANE COORDINATE POSITION DATA

State _____ Zone _____
X _____
Y _____
Estab. By _____
Agency

Signature
T. Hollamon

Title _____ Division _____ Headquarters _____

Date
1/75

CORNER RECORD (PERPETUATION)

MONUMENT: DESCRIBE NEW MONUMENT SET, OR WORK DONE TO PRESERVE EXISTING MONUMENT

ACCESSORIES: DESCRIBE NEW BT'S WITNESS OBJECTS ETC. ESTABLISHED, OR WORK DONE TO PRESERVE EXISTING EVIDENCE

Work Done By _____ Title _____ Date _____ State Registration No. or Agency _____

Certified Cor. Record Prepared? Yes No Filed At: _____ Date _____

REMARKS

Index File No. T. R. M. Tract or Surv. No. Cor.