

USDA-FOREST SERVICE

Index  
File No. A 7

**CORNER RECORD (SEARCH)**  
(Ref. FSM 7151.4)

Tract or  
Survey No. \_\_\_\_\_ Cor.  
No. \_\_\_\_\_

T 5N R. 38E R.D. Walla Walla County Umatilla

Merid. Willamette N.F. Umatilla State Oregon

CORNER DIAGRAM

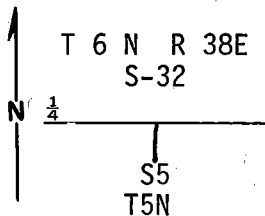

DESCRIBE CORNER MONUMENT FOUND

Found 3" Crown Zellerbach brass cap stamped LS 1294 and set 1980.

DESCRIBE BEARING TREES OR OTHER OFFICIAL ACCESSORIES FOUND

- 1) Found 10" pine with 54-3 sign which reads T5N R38 E Sec. 5 N 29°W 55 ft. GDW 10-10-80
- 2) Found 15" fir with 54-3 sign which reads T5N R38E Sec. 5 N 64°E 62.9' GDW 10-10-80

PHOTO IDENTIFICATION DATA

Photo No. \_\_\_\_\_

Filed At. \_\_\_\_\_

Object Ident. \_\_\_\_\_

Ident. By \_\_\_\_\_

*Signature*

6

Note: Both scribes poor

DESCRIBE CORNER LOCATION RELATIVE TO NEAR-BY FEATURES, ALSO HOW TO REACH CORNER

From intersection of Government Mountain Road (6511) and Road 400 travel north to Road 440 then east and north  $\frac{1}{4}$  mile to wood post with location poster then west 700' to corner.

PLANE COORDINATE POSITION DATA

State \_\_\_\_\_ Zone \_\_\_\_\_

X \_\_\_\_\_

Y \_\_\_\_\_

Estab. By \_\_\_\_\_

*Agency*

8

Signature  
**PAUL TOMPKINS**

Title  
**PLS 2360**

Division

Headquarters

Date  
**7/92**

FS-7100-52 (3/68)

4

5

**CORNER RECORD (PERPETUATION)**

**MONUMENT: DESCRIBE NEW MONUMENT SET, OR WORK DONE TO PRESERVE EXISTING MONUMENT**

**ACCESSORIES : DESCRIBE NEW BT'S WITNESS OBJECTS ETC. ESTABLISHED, OR WORK DONE TO PRESERVE EXISTING EVIDENCE**

Work Done By \_\_\_\_\_ Title \_\_\_\_\_ Date \_\_\_\_\_ State Registration No. \_\_\_\_\_  
or Agency \_\_\_\_\_  
Certified Cor. Record Prepared ? Yes ( No ) Filed At: \_\_\_\_\_ Date \_\_\_\_\_

**REMARKS**

Index File No. A7 T. 5N R. 38E M. W.M. Tract or Surv. No. Cor. \_\_\_\_\_

USDA-FOREST SERVICE

Index File No. A-7

CORNER RECORD (SEARCH)

(Ref. FSM 7151.4)

Tract or Survey No. \_\_\_\_\_ Cor. No. \_\_\_\_\_

T 5N R. 38E

R.D. W2 County UMATILLA

Merid. WILL

N.F. UMATILLA State OREGON

CORNER DIAGRAM

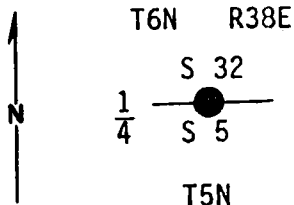

DESCRIBE CORNER MONUMENT FOUND

A diligent search was made and no evidence of stone could be found.

DESCRIBE BEARING TREES OR OTHER OFFICIAL ACCESSORIES FOUND

PHOTO IDENTIFICATION DATA

Photo No. \_\_\_\_\_

Filed At. \_\_\_\_\_

Object Ident. \_\_\_\_\_

Ident. By \_\_\_\_\_

*Signature*

PLANE COORDINATE POSITION DATA

State \_\_\_\_\_ Zone \_\_\_\_\_

X \_\_\_\_\_

Y \_\_\_\_\_

Estab. By \_\_\_\_\_

*Agency*

DESCRIBE CORNER LOCATION RELATIVE TO NEAR-BY FEATURES, ALSO HOW TO REACH CORNER

Signature

57 HOWARD PERRY

Title

PLS 1294

Division

Headquarters

Date

10/80

7100-52-(3, 6)

**CORNER RECORD (PERPETUATION)**

Description of monument and accessories I established to perpetuate the original location of this corner:

Set at proportioned point a 1"x30" Galvanized Pipe with 3" brass cap stamped:

Set pipe 24" in ground with mound of stone to cap.

Bearing Trees:

A Ponderosa Pine 6" dia. bears S29<sup>0</sup>E 55.0 ft., scribed: 1/4 S5 BT.

A Douglas Fir 15" dia. bears S64<sup>0</sup>W 62.9 ft., scribed: 1/4 S5 BT.

Attached 54-3 and 54-4 signs to both BTs. Attached brass washers to foot blaze of both BTs. Stamped LS 1294. Painted blazes and 6" band around both BTs red.

CROWN ZELLERBACH

T6N R38E  
 $\frac{1}{4}$  S32  
 S5  
 T5N  
 1980  
 OR PLS 1294

10

11

12

Index File No.

T.

R.

M.

Tract or Surv. No.

Cor.

A-7

5N

38E



USDA-FOREST SERVICE

Index  
File No. Z-7

CORNER RECORD (SEARCH)

(Ref. FSM 7151.4)

Tract or  
Survey No. \_\_\_\_\_

Cor.  
No. \_\_\_\_\_

T 6N R. 38E

R.D. WALLA WALLA County UMATILLA

Merid. WILLAMETTE

N.F. UMATILLA State OREGON

CORNER DIAGRAM

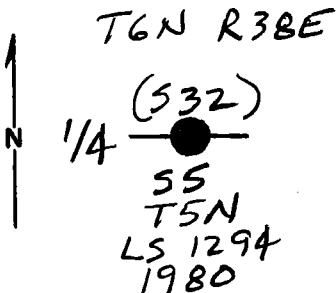

DESCRIBE CORNER MONUMENT FOUND

BRASS CAPPED IRON PIPE SET BY SURVEY BY PERRY IN 1980 & ACCEPTED BY BLM

DESCRIBE BEARING TREES OR OTHER OFFICIAL ACCESSORIES FOUND

PHOTO IDENTIFICATION DATA

Photo No. \_\_\_\_\_  
 Filed At. \_\_\_\_\_  
 Object Ident. \_\_\_\_\_  
 Ident. By \_\_\_\_\_

*Signature*

PLANE COORDINATE POSITION DATA

State \_\_\_\_\_ Zone \_\_\_\_\_  
 X \_\_\_\_\_  
 Y \_\_\_\_\_  
 Estab. By \_\_\_\_\_

*Agency*

Signature

Title

Division

Headquarters

Date

1990

FS-7100-52 (3/68)

**CORNER RECORD (PERPETUATION)**

**MONUMENT: DESCRIBE NEW MONUMENT SET, OR WORK DONE TO PRESERVE EXISTING MONUMENT**

**ACCESSORIES : DESCRIBE NEW BT's WITNESS OBJECTS ETC. ESTABLISHED, OR WORK DONE TO PRESERVE EXISTING EVIDENCE**

Work Done By \_\_\_\_\_ Title \_\_\_\_\_ Date \_\_\_\_\_ State Registration No. \_\_\_\_\_  
or Agency \_\_\_\_\_

Certified Cor. Record Prepared ? Yes No Filed At: \_\_\_\_\_ Date \_\_\_\_\_

**REMARKS**

Index File No. T. R. M. Tract or Surv. No. Cor.