

OREGON CORNER RESTORATION FORM

Section: 32, 5
Township: 6 North
Range: 35 East of the Willamette Meridian
County: Umatilla
Date: June 28, 2002

Corner Indexing Information: Township 6N Range 35E Corner Code Z 7 (Willamette Meridian)

Additional Identifier: (e.g. BLM designation for the corner, street intersection, plat name, block, lot, etc.)

This quarter corner is common to: Township 6N - Section 32 & 5 N Range 35E Section 5

Oregon Plane Coordinates: N: 838022.379 E: 8719589.997

Zone: North Order: second Datum: NAD83-91 Convergence: 1°26'34.3" Scale Factor: .99994565

Previous Renewals/Surveys, etc.: Originally surveyed by U.S. Deputy Surveyor William Odell under his contract No. 110, dated 8-23-1865. The Surveyor General's notes state, "set quarter section post, drove charred stake, dug pits, and raised mounds as per instructions." Umatilla County Survey No. I-89-AX, dated April 25, 1973, Streamer set a 1/2" iron pin at the surveyed position.

Monument(s) & Accessories Found (Condition & Source):

At the south quarter corner of section 32, T6N R35E, we found 1/2" rebar 10.5' of the south edge of gravel road.

Monument Set (Procedures & Description):

Set 1" x 30" flared end galvanized iron pipe with 2 1/2" brass cap at the surface stamped (see example below)
T6N R35E
LS 2360
S32
S5
2001
T5N R35E

Monument Detail:

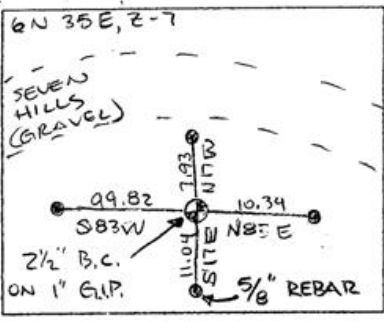

New Accessories: WE SET:

A 5/8 rebar with yellow plastic cap stamped 'Tomkins Surveying' which bears N 83°E ~ 10.34 from the corner. Attached a Umatilla County Bearing object sign to a t-post. A 5/8 rebar with yellow plastic cap stamped 'Tomkins Surveying' which bears S 17°E ~ 11.04 feet from the corner. Attached a Umatilla County Bearing object sign to a t-post. A 5/8 rebar with yellow plastic cap stamped 'Tomkins Surveying' which bears S 83°W ~ 99.82 feet from the corner. Attached a Umatilla County Bearing object sign to the east face of railroad timber guardrail post. A 5/8 rebar with yellow plastic cap stamped 'Tomkins Surveying' which bears N 17°W ~ 7.93 feet from the corner. Attached a Umatilla County Bearing object sign to the south face of power pole.

Location & Comments:

Compass Declination: 19° East

Surveyor's Seal

Firm/Agency: Tomkins Land Surveying, Inc.
20 E. Poplar, Suite 204
Walla Walla, WA 99362



Handwritten signature of Paul W. P. Tomkins.

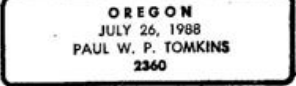

Party Chief: Bryan Martin
Notes: Bryan Martin
Witness: Eric Flowers

renews 6/30/04
6/30/02