

OREGON CORNER RESTORATION FORM

Section: 25 & 26
Township: 6 North
Range: 35 East of the Willamette Meridian
County: Umatilla
Date: June 28, 2002

Corner Indexing Information: Township 6N Range 35E Corner Code T 21 (Willamette Meridian)

Additional Identifier: (e.g. BLM designation for the corner, street intersection, plat name, block, lot, etc.)

This quarter corner is common to sections 25 & 26.

Oregon Plane Coordinates: N: 846471.296 E: 8737963.375

Zone: North **Order:** second **Datum:** NAD83-91 **Convergence:** 1°29'40.8" **Scale Factor:** .99994894

Previous Renewals/Surveys, etc.: Originally surveyed by U.S. Deputy Surveyor William Odell under his contract No. 110, dated 8-23-1875. The Surveyor General's notes state, "set quarter section corner post, drove a charred stake, dug pits and raised mounds as per instructions." County Survey No. 61, Book 1, Page 273, dated September 5, 1893, Arnold found a river boulder 20" long and 10" in the ground marked ¼ on west face and "+" on the top. Survey P-28-A dated June 1978, McLind found a stone 6"x7"x20" high with "1/4" chisled on the south face 18" below the surface and set a ¾" rod over the stone flush with the pavement.

Monument(s) & Accessories Found (Condition & Source):

At the west quarter corner of section 25, T6N R35E, we found ¾" rebar 1 ½" below the surface pavement.

Monument Set (Procedures & Description):

Drove ¾" rebar to 3" deep. Drove 1 ½" x 15 ½" galvanized iron pipe around ¾" rebar and placed 10" of concrete around pipe and filled with concrete and set 2" brass disc on top of the pipe at ½" below surface pavement stamped (see example below)

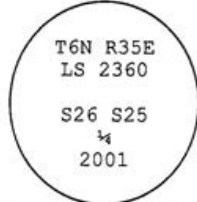

Monument Detail:

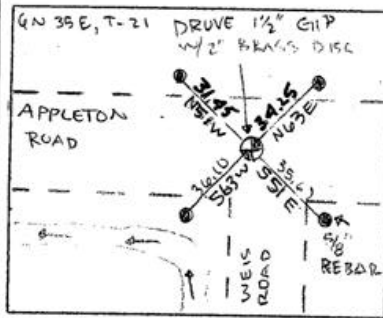

New Accessories: WE SET:

A 5/8 rebar with yellow plastic cap stamped 'Tomkins Surveying' which bears N 63°E ~ 34.25 from the corner. Attached a Umatilla County Bearing object to the Southwest face of power pole. A 5/8 rebar with yellow plastic cap stamped 'Tomkins Surveying' which bears S 51°E ~ 35.67 feet from the corner. Attached a Umatilla County Bearing object to the Northwest face of power pole. A 5/8 rebar with yellow plastic cap stamped 'Tomkins Surveying' which bears S 63°W ~ 36.10 feet from the corner. Attached a Umatilla County Bearing object to a t-post. A 5/8 rebar with yellow plastic cap stamped 'Tomkins Surveying' which bears N 51°W ~ 31.47 feet from the corner. No Umatilla County Bearing object or t-post set.

Location & Comments:

Compass Declination:

19° East

Firm/Agency: Tomkins Land Surveying, Inc.
 20 E. Poplar, Suite 204
 Walla Walla, WA 99362

Party Chief: Bryan Martin
Notes: Bryan Martin
Witness: Eric Flowers

Surveyor's Seal

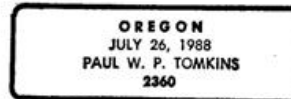
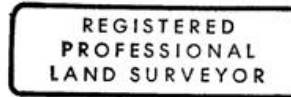

*renewed 6/30/09
 6/30/02*