

**OREGON CORNER RESTORATION FORM**

Section 32 Township 6N Range 34E  
 County Umatilla Date: December 10, 2002

Corner Designation: 6N34Z7

Common quarter corner to section 32, T6N, R34E, and Section 5, T5N, R34E, W.M., Umatilla County, Oregon.

State Plane Coordinates, Oregon North, 83(1991)  
 N = 837041.11 E = 8687788.01

Condition Report Only  
 Not found  
 Remonumented  
 Unrecorded  
 Surveyed in  
 Referenced out

Previous Renewals / Surveys, etc.

Corner originally set by Deputy Surveyors Odell & Lewis under contract 110 dated February 7, 1865. Their record reads: Set 1/4 Sec. post; drove charred stake, dug pits and raised mound as per instructions. John Kimbrell measured from this corner in his survey recorded in the record of private surveys Book 2, Page 36. He does not state what the monument was.

Monument and Accessories found: ( condition and source )

A fence corner with fences running East and South. The position agrees very well with measurements from the Kimbrell survey to the 1/4 corner on the south side of Section 31.

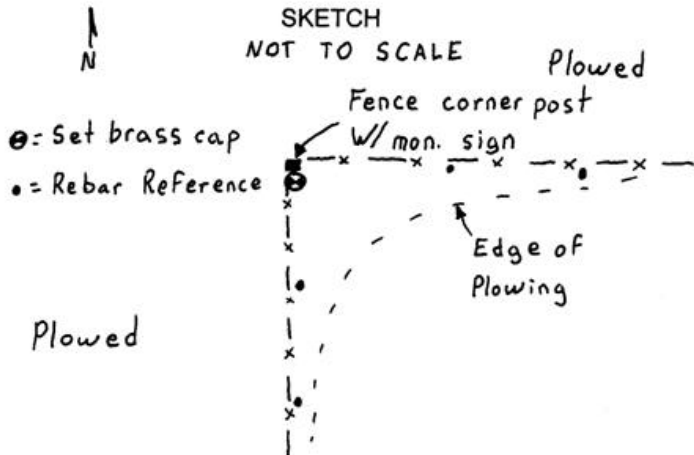
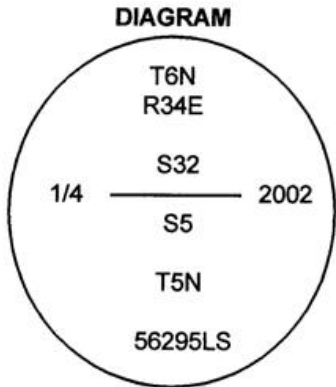

**MONUMENT (S) AND ACCESSORIES SET (Procedures and Description)**

I set a 2 1/4" brass cap on a 1 1/2" x 30" galvanized iron pipe 30" in the ground. I attached a County monument sign to the fence corner post and stamped the cap as shown in the diagram above.

For references, I set four 5/8" by 24" green coated iron rebars with 1 1/8" orange plastic caps stamped WTS and 56295LS as described below:

- an iron rebar bears N84°14'35"E, 14.94 feet on the south side of the existing fence;
- an iron rebar bears N86°39'50"E, 28.48 feet on the south side of the existing fence;
- an iron rebar bears S3°04'25"E, 25.17 feet on the east side of the existing fence;
- an iron rebar bears S1°58'11"E, 48.60 feet on the east side of the existing fence;

The monument and references were tied using a LIECA system 300 RTK GPS.

Location and comments

Compass Declination

Surveyors Seal

RECEIVED BY:  
Umatilla County Surveyor  
 Date: 2-03  
 Rec'd By: KK  
 No. 03-21-C

Firm / Agency  
 Witness Tree Surveying  
 Address  
 P.O. Box G  
 Pilot Rock, Or. 97868  
 Party Chief  
 Stephen K, Haddock

REGISTERED  
 PROFESSIONAL  
 LAND SURVEYOR

*Stephen K. Haddock*

OREGON  
 JULY 9, 2001  
 STEPHEN K. HADDOCK  
 56295LS

RENEWAL DATE 6-30-03