

## LAND CORNER RECORD

5680-2

33 1/2 E

1. T. 55 R. 33E No. 1825 Cor. SEC. Mer. Will State OREGON (Rectangular) N. F. WALLOWA-WHITMAN Dist. LA-GRANDE

2. Corner Status

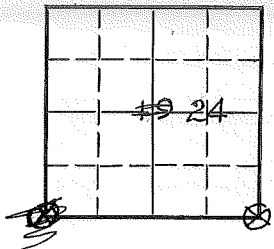

7. Photo Identification

Photo No. \_\_\_\_\_

Ident. By: \_\_\_\_\_

8. Plane Coordinate Position Data

State \_\_\_\_\_ Zone \_\_\_\_\_

X \_\_\_\_\_

Y \_\_\_\_\_

Etab. By \_\_\_\_\_

Field Book No. \_\_\_\_\_

Where Filed \_\_\_\_\_

9. Evaluation

Authentic \_\_\_\_\_ X \_\_\_\_\_

Needs Verif. \_\_\_\_\_ Monument NORe-estab. X Survey \_\_\_\_\_

Land Status \_\_\_\_\_

3. Original Description \_\_\_\_\_ Vol. \_\_\_\_\_ Page \_\_\_\_\_ Where Recorded \_\_\_\_\_

4. Description of Corners: 80.52 POST 4" Sq. FOR SEC. COR.  
 FROM WHICH: A PINE 4" DIAM. BEARS S80°E, 7 LK. DIST.  
A TAMARACK 13" DIAM. BEARS N62°E 30 LKS  
A PINE 4" DIAM BEARS S36°W 18 LKS DIST.  
A PINE 4" DIAM BEARS N45°W 29 LKS. DIST

5. Investigation Notes: COR. NOT FOUND  
10" DEAD W.L. W/SCRIBING IN SEC. 19

PLACED LOCATION POSTER ON B.T.  
PAINTED LINE RED N. AND E. OF COR.  
PAINTED B.T. WITH RED PAINT.  
PLACED LOCATION POSTER & BOARD ON RD. EAST  
AND NORTH OF CORNER.

6. Signed WAYNE HYDE Title CIVIL ENG TECH Date 6-16-66

PERPETUATION RECORD

10. Monument:

11. Accessories

Field Book \_\_\_\_\_ Page \_\_\_\_\_

12. Set By \_\_\_\_\_ Title \_\_\_\_\_

License \_\_\_\_\_ Agency \_\_\_\_\_ Date \_\_\_\_\_

13. Recorded By \_\_\_\_\_ Volume \_\_\_\_\_ Page \_\_\_\_\_

(Agency)

(Date) \_\_\_\_\_ (City) \_\_\_\_\_ (County) \_\_\_\_\_ (State) \_\_\_\_\_

14. Remarks:

LAND CORNER RECORD

33 1/2 E

(Rectangular)

1. T. 55 R. 33 1/2 E No. 1825 Cor. SEC. Mer. Will State OREGON N. F. WALLOWA-WHITMAN Dist. LA-GRANDE

2. Corner Status

3. Original Description \_\_\_\_\_ Vol. \_\_\_\_\_ Page \_\_\_\_\_ Where Recorded \_\_\_\_\_

4. Description of Corners: 80.52 POST 4" Sq. FOR SEC. COR.  
 FROM WHICH: A PINE 4" DIAM. BEARS S80°E, 7 LK. DIST.  
A TAMARACK 13" DIAM. BEARS N62°E 30 LKS  
A PINE 4" DIAM BEARS S36°W 18 LKS DIST.  
A PINE 4" DIAM BEARS N45°W 29 LKS. DIST

5. Investigation Notes: COR. NOT FOUND  
10" DEAD W.L. W/SCRIBING IN SEC. 19

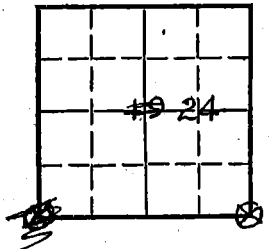

7. Photo Identification

Photo No. \_\_\_\_\_  
 Ident. By: \_\_\_\_\_

8. Plane Coordinate Position Data

State \_\_\_\_\_ Zone \_\_\_\_\_  
 X \_\_\_\_\_  
 Y \_\_\_\_\_  
 Etab. By \_\_\_\_\_  
 Field Book No. \_\_\_\_\_  
 Where Filed \_\_\_\_\_

9. Evaluation

Authentic X  
 Needs Verif. \_\_\_\_\_ Monument NO  
 Re-estab. X Survey \_\_\_\_\_  
 Land Status \_\_\_\_\_

PLACED LOCATION POSTER ON BT.  
PAINTED LINE RED N. AND E. OF COR.  
PAINTED B.T. WITH RED PAINT.  
PLACED LOCATION POSTER & BOARD ON RD. EAST  
AND NORTH OF CORNER.

I visited this corner on 5-13-87 & found the  
larch to be a 8' high snag with full scribers  
visible. The 3 pine BTs are gone. I placed a  
location poster on a 24" larch N56°E, 60 feet  
from the corner.

Dennis L. Gaylord L.S. 1636

6. Signed WAYNE HYDE Title CIVIL ENG. TECH Date 6-16-66

Index File No. R 1

CORNER RECORD (SEARCH)

Tract or Survey No. \_\_\_\_\_ Cor. No. \_\_\_\_\_

T 5S R. 34E

R.D. LA GRANDE County WAGON

Merid. WILLAMETTE

N.F. WALLOWA-WHITMAN State OREGON

CORNER DIAGRAM

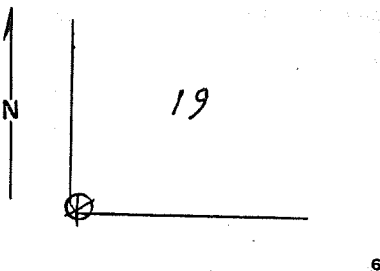

DESCRIBE CORNER MONUMENT FOUND

NONE

DESCRIBE BEARING TREES OR OTHER OFFICIAL ACCESSORIES FOUND

10" DEAD WL W/SCRIBING IN SEC 19

PHOTO IDENTIFICATION DATA

Photo No. \_\_\_\_\_  
 Filed At. \_\_\_\_\_  
 Object Ident. \_\_\_\_\_  
 Ident. By \_\_\_\_\_  
*Signature*

DESCRIBE CORNER LOCATION RELATIVE TO NEAR-BY FEATURES, ALSO HOW TO REACH CORNER

PLACED LOCATION POSTER ON B.T. PAINTED LINE W ANGLE OF CORNER. PAINTED BT WITH RED PAINT. PLACED LOCATION POSTER AND BOARD ON ROAD EAST AND NORTH OF CORNER.

PLANE COORDINATE POSITION DATA

State \_\_\_\_\_ Zone \_\_\_\_\_  
 X \_\_\_\_\_  
 Y \_\_\_\_\_  
 Estab. By \_\_\_\_\_  
*Agency*

Signature	Title	Division	Headquarters	Date	7100-52
<u>T WILLIAMS</u>	<u>C.E.T</u>		<u>LA GRANDE</u>	<u>6-16-66</u>	REV. '65 5