

CERTIFIED RECORD OF LAND CORNER MONUMENTATION

Y-18

History of original corner establishment:

Established by Survey between 1967 and 1980 by Bureau of Land Management:

Point for the SW 1/16 Sec. Cor. of Sec. 35 at intersection with the E-W centerline of the SW 1/4 Set an iron post, 28 ins. long, 2 1/2 ins. dia., 24 ins. in the ground, with brass cap marked:

SW 1/16 S35
1968

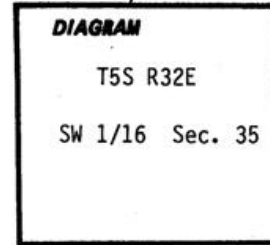

from which:

- A Fir, 15 ins. dia. bears S46°E 27 1/2 lks. dist., marked SW 1/16 S35 BT.
- A Fir, 12 ins. dia. bears N 80 1/2°W 56 1/2 lks. dist., marked SW 1/16 S35 BT

Description of corner evidence found:

Found 2 1/2" diameter iron pipe, firmly set, with brass cap marked as described, from which:

- A White Fir, 17 ins. dia., dead, with well healed single blaze, bears S46°E 18.2 feet.
- And A 14" White Fir, alive with well healed single blaze, bears N80 1/2°W 37.3 feet.

Description of monument and accessories established to perpetuate the original location of this corner:

We mark a new bearing tree:

A 14" Engleman Spruce, scribed "SW 1/16 S35 BT" on a double blaze bears S13°W 19.2 feet, with brass washer marked "LS 1099" attached to lower blaze.

Compass Declination: 20° East
Steel Tape

August 17, 1984

Witnesses:

- Gary Langlitz, LS 1099
- Ray Crapo
- Greg Orton

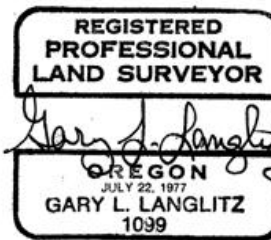

Office of Surveyor County of Umatilla
State of Oregon I hereby certify that the within instrument was filed in this office
for record on the 17 day of October 1984
Daniel Greenberry (COUNTY OFFICIAL) Billy Packman (DEPUTY)