

OREGON CORNER RESTORATION FORM

COUNTY: Umatilla DATE: 08/01/02

CORNER DESIGNATION: N-17, The Southwest Corner of Section 14, T5S., R31E., W.M.

PREVIOUS RENEWALS/SURVEYS ETC.: Corner originally set by George S. Pershin, under Contract No. 373, dated Sept. 17, 1880. Notes state: Corner near middle of creek bed of Camas Creek, course N. W. I offset South 50 lks. and set basalt stone 18 x 8 x 8 on South bank of creek in mound of stone for corner. A willow 7 ins. diam., brs. N 70° W., 127 lks. dist. A willow 8 ins. diam., brs. S 54° W., 173 lks. dist.

MONUMENT AND ACCESSORIES FOUND: None. The corner and accessories have washed out. Camas Creek is hundreds of feet South of it's location in 1880.

MONUMENT MARKING DETAIL:

T5S R31E
S15 | S14
S22 | S23
2002
PLS 1106

MONUMENT SET:

At position determined by double proportion measurement between the recovered East 1/4 Corner of Section 22, recovered NW Corner of Section 14, recovered SW Corner of Section 15 and recovered South 1/4 Corner of Section 14, set a 2 1/2" brass cap on a 1 1/4" x 30" galvanized iron pipe 26" in the ground and surrounded with a small mound of earth and stone. Monument marked as shown in "Monument Marking Detail".

New Accessories:

A 5/8" x 30" iron rebar with a yellow plastic cap marked "OR PLS 1106, WA PLS 17372" bears N 38 1/2° E, 50.8 feet.

A 5/8" x 30" iron rebar with a yellow plastic cap marked "OR PLS 1106, WA PLS 17372" in a old rock jack mound bears S 69° E, 39.0 feet.

A 3/4" brass washer stamped "PLS 1106" nailed to a wood fence post rock jack 2 feet above ground bears S 82° W, 73.8 feet.

A 18" diameter hawthorn tree scribed "T5S R31E S15 BT" with a 3/4" brass washer stamped "PLS 1106" nailed to the "B" of "BT" bears N 45° W, 84.4 feet.

Attached bearing object signs to all accessories. Set a steel fence post with a witness sign wired to it 1 foot North of the corner.

LOCATION AND COMMENTS:

Corner monument falls 15 feet North of a old fence running East - West.

STATE PLANE COORDINATE, OREGON NORTH ZONE, NAD 83/91, INT. FOOT:

N = 536180.00
E = 8604204.08

FIRM: William R. Wells, PLS
P.O. Box 1696
Pendleton, OR 97801

COMPASS DECLINATION: 18° East

Witnesses: Jason Wells, LSIT
Mark Hammersla
5S31N17

Surveyor's Seal

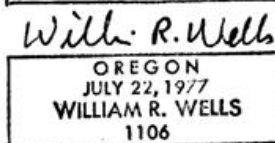
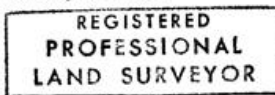

RENEWS 6-30-04

RECEIVED BY

Umatilla County Surveyor
Date 10-02
Rec'd By KR
No. 02-218-B