

Index File No. N-25  
 T 5 S. R. 30 E.  
 Merid. Willamette

**CORNER RECORD (SEARCH)**

(Ref. FSM 7151.4)

Tract or Survey No. \_\_\_\_\_  
 Cor. No. \_\_\_\_\_

R.D. Ukiah County Umatilla  
 N.F. Umatilla State Oregon

**CORNER DIAGRAM**

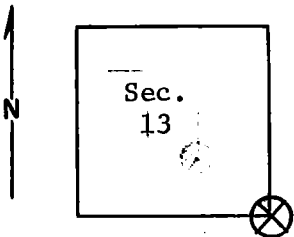

**DESCRIBE CORNER MONUMENT FOUND**

Stone rock-jack, 4' diam., 20" deep; 20" above ground, in good condition.  
 No evidence of corner stone. Rock-jack is in fence corner.  
 Fence runs north and east.

**DESCRIBE BEARING TREES OR OTHER OFFICIAL ACCESSORIES FOUND**

The stump of the original B.T. remains in the NE quadrant. All other B.T.'s are gone. NE B.T. has been logged. Stump will soon be rotted. (Stump has B.T. tag.)  
 A 15" ponderosa pine bears N,60°W. It has a brand 7" wide, 14" high on side facing corner. Brand *R*  
 (cont. in block 12)

**DESCRIBE CORNER LOCATION RELATIVE TO NEAR-BY FEATURES, ALSO HOW TO REACH CORNER**

*monumented by Bill Wells  
 1979*

**PHOTO IDENTIFICATION DATA**

Photo No. \_\_\_\_\_  
 Filed At. \_\_\_\_\_  
 Object Ident. \_\_\_\_\_  
 Ident. By \_\_\_\_\_  
*Signature*

**PLANE COORDINATE POSITION DATA**

State \_\_\_\_\_ Zone \_\_\_\_\_  
 X \_\_\_\_\_  
 Y \_\_\_\_\_  
 Estab. By \_\_\_\_\_  
*Agency*

Signature  
 T. Hollamon

Title  
 Eng. Tech.

Division

Headquarters  
 S.O.

Date  
 4/19/74

7100-52-(3/68)

CORNER RECORD (PERPETUATION)

MONUMENT: DESCRIBE NEW MONUMENT SET, OR WORK DONE TO PRESERVE EXISTING MONUMENT

ACCESSORIES : DESCRIBE NEW BT'S WITNESS OBJECTS ETC. ESTABLISHED, OR WORK DONE TO PRESERVE EXISTING EVIDENCE

Work Done By \_\_\_\_\_ Title \_\_\_\_\_ Date \_\_\_\_\_ State Registration No. \_\_\_\_\_  
or Agency \_\_\_\_\_

Certified Cor. Record Prepared ? Yes No Filed At: \_\_\_\_\_ Date \_\_\_\_\_

REMARKS

(Block #3 - cont.)

There is a location poster on a 14" ponderosa pine approx. 1,140 ft. west.  
*Tree* ~~There~~ is line blazed (X) on east and west sides. Tree grows at south  
edge of primitive road. (See Sugarbowl Creek Quadrangle Map.)

Index File No. T. R. M. Tract or Surv. No. Cor.

USDA-FOREST SERVICE

Index File No. N-1  
 T 5S R. 31E  
 Merid. Willamette

CORNER RECORD (SEARCH)

(Ref. FSM 7151.4)

Tract or Survey No. Sec 19 Cor. No. NW Cor  
 R.D. Ukiah County Umatilla  
 N.F. Umatilla State Oregon

CORNER DIAGRAM

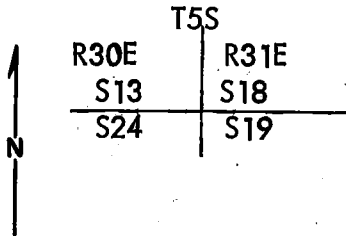

DESCRIBE CORNER MONUMENT FOUND

Found a basalt stone 24" x 12" x 7" with no marks. The area has been logged and the stone appears to have been moved (reset from BT)

DESCRIBE BEARING TREES OR OTHER OFFICIAL ACCESSORIES FOUND

A 24" pine stump (rotted) with blaze visible but no scribing visible bears N34°E 51.5 ft. to center.

PHOTO IDENTIFICATION DATA

Photo No. \_\_\_\_\_  
 Filed At. \_\_\_\_\_  
 Object Ident. \_\_\_\_\_  
 Ident. By \_\_\_\_\_  
 Signature \_\_\_\_\_

PLANE COORDINATE POSITION DATA

State \_\_\_\_\_ Zone \_\_\_\_\_  
 X \_\_\_\_\_  
 Y \_\_\_\_\_  
 Estab. By \_\_\_\_\_  
 Agency \_\_\_\_\_

DESCRIBE CORNER LOCATION RELATIVE TO NEAR-BY FEATURES, ALSO HOW TO REACH CORNER

Drive along the road that goes up the bottom of Wilkens Creek to the location poster on tree, on the North side of the road from the location poster walk North 800' to corner which is on S.W. Slope 200' - from the bottom of canyon.

Signature

*William R. Wells*

Title PLS 1106

Division

Headquarters

Date

7 29 79

7100-52-(3/68)

**CORNER RECORD (PERPETUATION)**

**MONUMENT: DESCRIBE NEW MONUMENT SET, OR WORK DONE TO PRESERVE EXISTING MONUMENT**

Set a 2" x 30" galvanized iron pipe with a brass cap 20" in ground with a mound of stones to the cap marked:  
Set steel fence post North of corner and attached sign 54-4

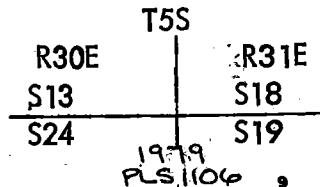

**ACCESSORIES : DESCRIBE NEW BT'S WITNESS OBJECTS ETC. ESTABLISHED, OR WORK DONE TO PRESERVE EXISTING EVIDENCE**

A 13" bull pine bears N73 $\frac{1}{2}$ °W 71.2 ft. to center, scribed T5S R30E S13 BT  
 A 12 $\frac{1}{2}$ " bullpine bears N61 $\frac{1}{2}$ °E 43.2 ft. to center, scribed T5S R31E S18 BT  
 A 9 $\frac{1}{2}$ " bullpine bears S60 $\frac{1}{2}$ °E 44.0 ft. to center, scribed T5S R31E S 19 BT  
 A 12" red fir bears S56 $\frac{1}{2}$ °W 80.4 ft. to center. scribed T5S R30E S24 BT  
 New BT's have a lower blaze scribed BT with a brass washer stamped PLS 1106 nailed flush  
 Attached signs 54-3 & 54-4 and painted red ring around all BT's

10

Work Done By William R. Wells Title PLS Date 7 29 79 State Registration No. 1106  
 or Agency

Certified Cor. Record Prepared ? Yes  No  Filed At: Umatilla County Surveyor's office Date \_\_\_\_\_

11

Witnesses: Greg Flowers L.S.I.T. REMARKS  
Brent Reynolds

12