

Index File No. N-25
 T 5 S. R. 30 E.
 Merid. Willamette

CORNER RECORD (SEARCH)
 (Ref. FSM 7151.4)
 R.D. Ukiah County Umatilla
 N.F. Umatilla State Oregon

Tract or Survey No. _____
 Cor. No. _____

CORNER DIAGRAM

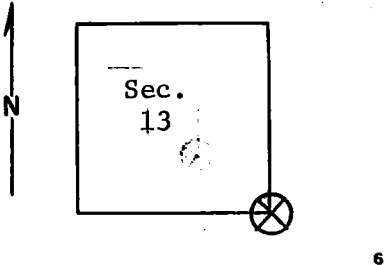

DESCRIBE CORNER MONUMENT FOUND

Stone rock-jack, 4' diam., 20" deep; 20" above ground, in good condition.
 No evidence of corner stone. Rock-jack is in fence corner.
 Fence runs north and east.

DESCRIBE BEARING TREES OR OTHER OFFICIAL ACCESSORIES FOUND

The stump of the original B.T. remains in the NE quadrant. All other B.T.'s are gone. NE B.T. has been logged. Stump will soon be rotted. (Stump has B.T. tag.)
 A 15" ponderosa pine bears N,60°W. It has a brand 7" wide, 14" high on side facing corner. Brand *R*
 (cont. in block 12)

DESCRIBE CORNER LOCATION RELATIVE TO NEAR-BY FEATURES, ALSO HOW TO REACH CORNER

*monumented by Bill Wells
 1979*

PHOTO IDENTIFICATION DATA
 Photo No. _____
 Filed At. _____
 Object Ident. _____
 Ident. By _____
Signature

PLANE COORDINATE POSITION DATA
 State _____ Zone _____
 X _____
 Y _____
 Estab. By _____
Agency

Signature T. Hollamon Title Eng. Tech. Division _____ Headquarters S.O. Date 4/19/74 7100-52-(3/68)

CORNER RECORD (PERPETUATION)

MONUMENT: DESCRIBE NEW MONUMENT SET, OR WORK DONE TO PRESERVE EXISTING MONUMENT

ACCESSORIES : DESCRIBE NEW BT'S WITNESS OBJECTS ETC. ESTABLISHED, OR WORK DONE TO PRESERVE EXISTING EVIDENCE

Work Done By _____ Title _____ Date _____ State Registration No. _____
or Agency _____

Certified Cor. Record Prepared ? Yes No Filed At: _____ Date _____

REMARKS

(Block #3 - cont.)

There is a location poster on a 14" ponderosa pine approx. 1,140 ft. west.
Tree ~~There~~ is line blazed (X) on east and west sides. Tree grows at south
edge of primitive road. (See Sugarbowl Creek Quadrangle Map.)

Index File No. T. R. M. Tract or Surv. No. Cor.

USDA-FOREST SERVICE

Index File No. N-1
 T 5S R. 31E
 Merid. Willamette

CORNER RECORD (SEARCH)

(Ref. FSM 7151.4)

Tract or Survey No. Sec 19 Cor. No. NW Cor
 R.D. Ukiah County Umatilla
 N.F. Umatilla State Oregon

CORNER DIAGRAM

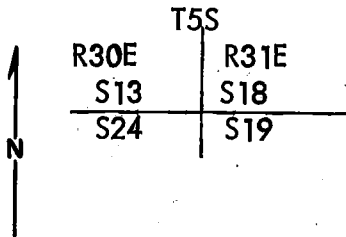

DESCRIBE CORNER MONUMENT FOUND

Found a basalt stone 24" x 12" x 7" with no marks. The area has been logged and the stone appears to have been moved (reset from BT)

DESCRIBE BEARING TREES OR OTHER OFFICIAL ACCESSORIES FOUND

A 24" pine stump (rotted) with blaze visible but no scribing visible bears N34°E 51.5 ft. to center.

PHOTO IDENTIFICATION DATA

Photo No. _____
 Filed At. _____
 Object Ident. _____
 Ident. By _____
Signature

PLANE COORDINATE POSITION DATA

State _____ Zone _____
 X _____
 Y _____
 Estab. By _____
Agency

DESCRIBE CORNER LOCATION RELATIVE TO NEAR-BY FEATURES, ALSO HOW TO REACH CORNER

Drive along the road that goes up the bottom of Wilkens Creek to the location poster on tree, on the North side of the road from the location poster walk North 800' to corner which is on S.W. Slope 200' - from the bottom of canyon.

Signature

William R. Wells

Title PLS 1106

Division

Headquarters

Date

7 29 79

7100-52-(3/68)

CORNER RECORD (PERPETUATION)

MONUMENT: DESCRIBE NEW MONUMENT SET, OR WORK DONE TO PRESERVE EXISTING MONUMENT

Set a 2" x 30" galvanized iron pipe with a brass cap 20" in ground with a mound of stones to the cap marked:
Set steel fence post North of corner and attached sign 54-4

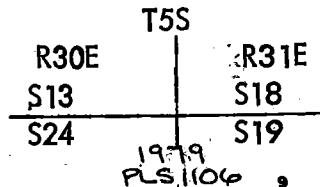

ACCESSORIES : DESCRIBE NEW BT'S WITNESS OBJECTS ETC. ESTABLISHED, OR WORK DONE TO PRESERVE EXISTING EVIDENCE

A 13" bull pine bears N73 $\frac{1}{2}$ °W 71.2 ft. to center, scribed T5S R30E S13 BT
 A 12 $\frac{1}{2}$ " bullpine bears N61 $\frac{1}{2}$ °E 43.2 ft. to center, scribed T5S R31E S18 BT
 A 9 $\frac{1}{2}$ " bullpine bears S60 $\frac{1}{2}$ °E 44.0 ft. to center, scribed T5S R31E S 19 BT
 A 12" red fir bears S56 $\frac{1}{2}$ °W 80.4 ft. to center. scribed T5S R30E S24 BT
 New BT's have a lower blaze scribed BT with a brass washer stamped PLS 1106 nailed flush
 Attached signs 54-3 & 54-4 and painted red ring around all BT's

10

Work Done By William R. Wells Title PLS Date 7 29 79 State Registration No. or Agency 1106

Certified Cor. Record Prepared ? Yes No Filed At: Umatilla County Surveyor's office Date _____

11

Witnesses: Greg Flowers L.S.I.T. REMARKS
Brent Reynolds

Index File No.
N-1

T.
S5

R.
31E

M.
Willamette

Tract or. Surv. No.
Sec. 19

Cor. N.W. COR 13
U.S. G.P.O. 1977-725-576/586

12