

Index J-11  
 File No. \_\_\_\_\_

**CORNER RECORD (SEARCH)**  
 (Ref. FSM 7151.4)

Tract or Survey No. \_\_\_\_\_  
 Cor. No. J-11

T 5 S R. 30 E  
 Merid. Willamette

R.D. Ukiah County Umatilla  
 N.F. Umatilla State Oregon

**CORNER DIAGRAM**

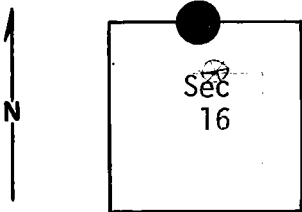

**DESCRIBE CORNER MONUMENT FOUND**

Basalt stone, generally fits GLO description, 4" above ground, good condition, markings not legible.

*Brass Cap: see Monumentation File* 2

**DESCRIBE BEARING TREES OR OTHER OFFICIAL ACCESSORIES FOUND**

Stone surrounded by general circle of smaller stones. Fallen and rotted 10" LP pine bears S90°W, 48 links. Some evidence of old blaze and marks that may be scribing. Several fallen and badly rotted LP pine bear N79°W ~~70~~ 70 to 80 lks. No evidence of scribing.

**PHOTO IDENTIFICATION DATA**

Photo No. \_\_\_\_\_  
 Filed At. \_\_\_\_\_  
 Object Ident. \_\_\_\_\_  
 Ident. By \_\_\_\_\_  
*Signature* 7

**DESCRIBE CORNER LOCATION RELATIVE TO NEAR-BY FEATURES, ALSO HOW TO REACH CORNER**

From New Western Route Road go southerly on Road S-420 about 1.9 mi. to a point approx. 1000' N. of sec. line between Sec. 9 and 16. Thence westerly on a logging road for about .6 mile to sharp right turn across the N (lower) end of a 100' to 200' wide opening (small drainage). Thence southerly (off road) about 450'. Stone is in W edge of opening, about 10' from edge of LP pine stand and about 50' below stock pond. Some apparent line blazing nearby. 4

**PLANE COORDINATE POSITION DATA**

State \_\_\_\_\_ Zone \_\_\_\_\_  
 X \_\_\_\_\_  
 Y \_\_\_\_\_  
 Estob. By \_\_\_\_\_  
*Agency* 8

|                                 |                           |                             |                             |                        |   |
|---------------------------------|---------------------------|-----------------------------|-----------------------------|------------------------|---|
| Signature<br><u>T. Hollamon</u> | Title<br><u>Eng Tech,</u> | Division<br><u>Umatilla</u> | Headquarters<br><u>S,O,</u> | Date<br><u>9/18/73</u> | 7100-52-(3/68) <span style="float: right;">5</span> |
|---------------------------------|---------------------------|-----------------------------|-----------------------------|------------------------|---|

CORNER RECORD (PERPETUATION)

MONUMENT: DESCRIBE NEW MONUMENT SET, OR WORK DONE TO PRESERVE EXISTING MONUMENT

9

ACCESSORIES : DESCRIBE NEW BT'S WITNESS OBJECTS ETC. ESTABLISHED, OR WORK DONE TO PRESERVE EXISTING EVIDENCE

10

Work Done By \_\_\_\_\_ Title \_\_\_\_\_ Date \_\_\_\_\_ State Registration No. or Agency \_\_\_\_\_

Certified Cor. Record Prepared ? Yes No Filed At: \_\_\_\_\_ Date \_\_\_\_\_

11

REMARKS

Probably sufficient evidence for monumentation.

12

Index File No. J-11 T. R. M. Tract or Surv. No. Cor. 13