

PAUL W.P. TOMKINS, LAND SURVEYOR
 LAND CORNER RECORD

UMATILLA County

T 05N, R 36E., W.M.

Corner Code No. L-1

Segregated Surveys:

Name: WEST 1/4 CORNER SECTION 18

Corner No.:

DLC, HES, Tract, Mining Claim, Indian Allotment, Federal Reserve, Townsite

1. History of Corner Establishment and Subsequent Restoration:

CORNER ORIGINALLY ESTABLISHED BY ODELL & LEWIS IN 1865 UNDER CONTRACT NO. 110, AS "A POST FOR 1/4 CORNER". CRIGER, IN 1953, SHOWS CORNER AS A "PIPE". (SEE SURVEY Q-1039, UMATILLA CO. SURVEYOR). MELTON, IN 1951, DOES NOT DESCRIBE THE CORNER, BUT DOES SHOW THE NORTH LINE OF THE SOUTHWEST 1/4 AS BEING ALONG A FENCELINE, THE NORTHEAST CORNER OF SAID SOUTHWEST 1/4 BEING AN "OLD FENCE CORNER"

2. Description of Evidence Found:

NO DIRECT EVIDENCE FOUND. CORNER FALLS IN A PLOWED FIELD. AT FENCE CORNER 1/2 MILE TO EAST I FOUND A 5/8" IRON BAR, AND AT FENCE CORNER 1/2 MILE SOUTH I FOUND A BRASS CAP ON A PIPE WITH BASALT STONE ALONGSIDE. FROM THESE TWO CORNERS I RE-ESTABLISHED THE WEST 1/4 CORNER AT THE RECORD DISTANCES SHOWN ON THE AFOREMENTIONED CRIGER SURVEY.

3. Describe Monument, Accessories, and Corollary Data to Perpetuate this Corner Location. Diagram corner, indicate meridian and reference to map of Record. Surveyor's Field Book No. Page No. Date of Work 11/21/90

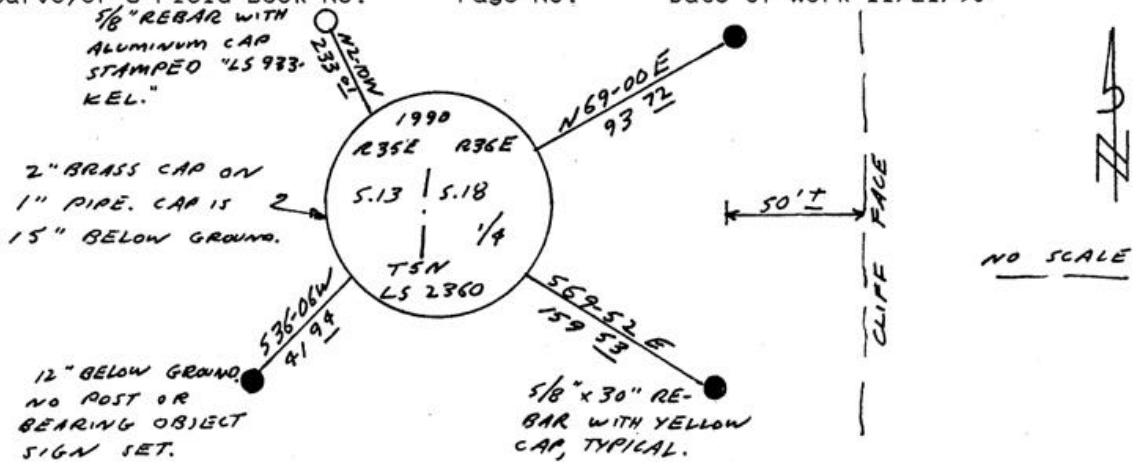

Oregon Plane Coordinates: North Zone, Y X
 Order Accuracy. Derived From:

Pin Pointed on Photo No. Date Located at

SURVEYOR'S CERTIFICATE

This corner record correctly represents work performed by me or under my direction in compliance with the provisions of the laws of the State of Oregon.

Date ..12-2-90.....

Paul W.P. Tomkins
 Signature

Certificate No. 2360

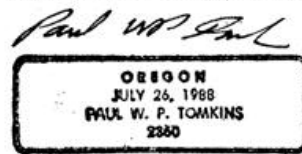
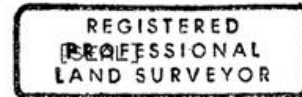

AUDITOR'S CERTIFICATE

Filed for record this day of, 19... at M. in Book of at Page at the request of

RECEIVED BY
 Umatilla County Surveyor
 Date 10-91
 Rec'd By KE
 No. 71-65-B

County Auditor