

OREGON CORNER RESTORATION FORM

Section 1 Township 5N Range 36E
 County Umatilla Date: May 14, 2012

Corner Designation: 5N36E21

Corner common to sections 1, 2, 11, and 12,
 T5N, R36E, W.M., Umatilla County, Oregon.

Condition Report Only
 Not found
 Remonumented
 Unrecorded
 Surveyed in
 Referenced out

Previous Renewals / Surveys, etc.

Corner was originally set by Odell and Lewis under contract No. 110 dated February 7, 1865. Their record reads: Set post corner for secs. 1, 2, 11 and 12. Drove charred stake, dug pits, raised mound, as per instructions.

Monument and Accessories found: (condition and source)
 None. The point falls in a plowed field.

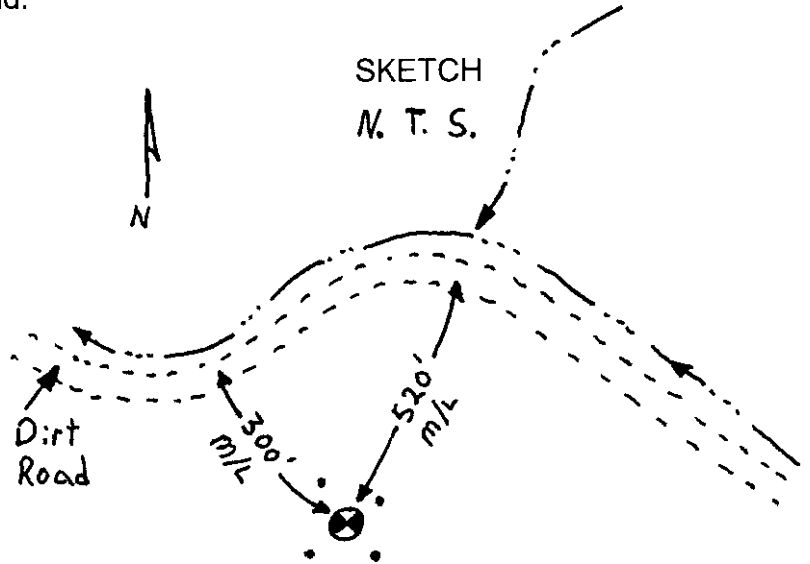
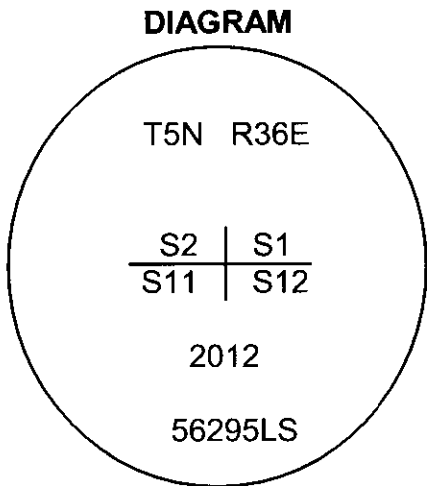

- ⊗ = Brass cap
- = Rebar reference

MONUMENT (S) AND ACCESSORIES SET (Procedures and Description)

I set a 2 3/8" brass cap on a 1 1/2"x30" galvanized iron pipe with a brass cap stamped as shown in the diagram above 2 feet below the surface of the field at the proportionate point.

For references: I set 4, 5/8"x24" iron rebars with orange plastic caps stamped WTS and 56295LS as described below 2 feet below the surface of the ground:

- An iron rebar bears N49°16'59"E, 24.43 feet;
- An iron rebar bears S33°54'39"E, 25.21 feet;
- An iron rebar bears S52°28'06"W, 25.60 feet;
- An iron rebar bears N32°30'48"W, 25.72 feet;

The monument and references were tied using a Trimble R7/R8 RTK GPS system.

Location and comments
 NAD 83/1991 State Plane Coordinate
 Oregon North Zone
 N = 834276.45 ift
 E = 8769969.55 ift

Compass Declination

Surveyors Seal

RECEIVED BY:
 Umatilla County Surveyor
 Date: 6/5/2012
 Rec'd By: A. Res
 No. 12-088-C

Firm / Agency
 Witness Tree Surveying
 Address
 P.O. Box G
 Pilot Rock, Or. 97868
 Party Chief
 Stephen K, Haddock

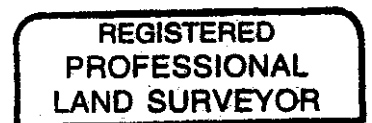

Stephen K. Haddock

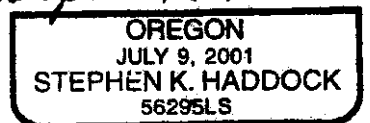

RENEWAL DATE 6-30-13