

**OREGON CORNER RESTORATION FORM**

Section 4 Township 5N Range 36E  
 County Umatilla Date: June 22, 2012

Corner Designation: 5N36E11

Condition Report Only  
 Not found  
 Remonumented  
 Unrecorded  
 Surveyed in  
 Referenced out

Quarter corner common to sections 4 and 9,  
 T5N, R36E, W.M., Umatilla County, Oregon.

Previous Renewals / Surveys, etc.

Corner originally set by Odell and Lewis under contract No. 110 dated February 7, 1865. Their record reads: Set 1/4 Sec. post, drove charred stake, dug pits and raised mound, as per instructions. John Kimbrell, in the record of private surveys Book 1, Page 393, reports finding the point of the charred stake which he left in place. He placed particles of the stake in a colored glass bottle and burried with one quart of stone coal 1 foot south of the original stake. Over the bottle and coal he set a stone 21x10x7 marked 1/4 on the south face and "X" on top.

Monument and Accessories found: ( condition and source )  
 The intersection of field lines to the east, west, and south.

**DIAGRAM**

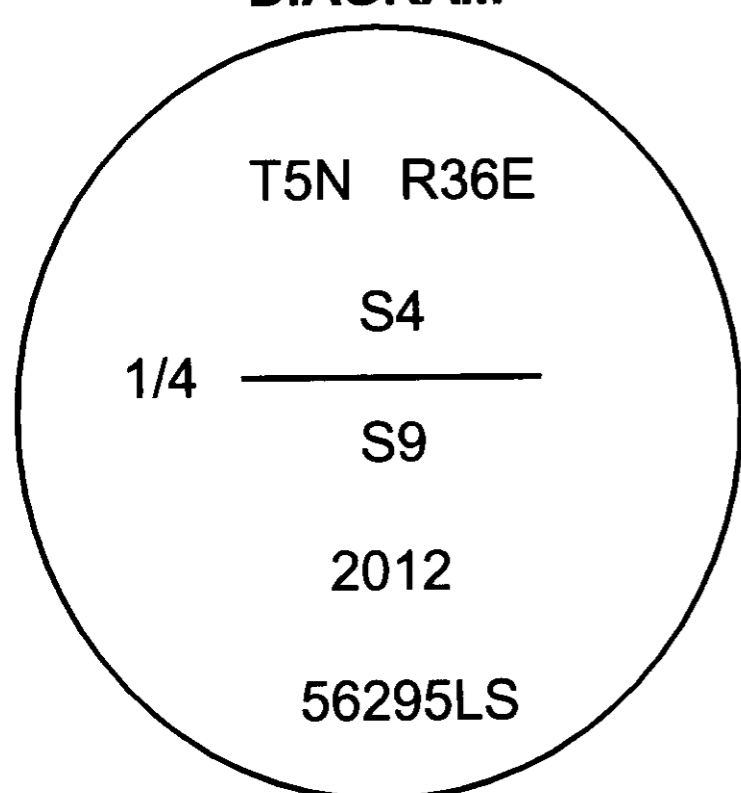

⊙ = Brass Cap  
 ● = Rebar Reference

**SKETCH**

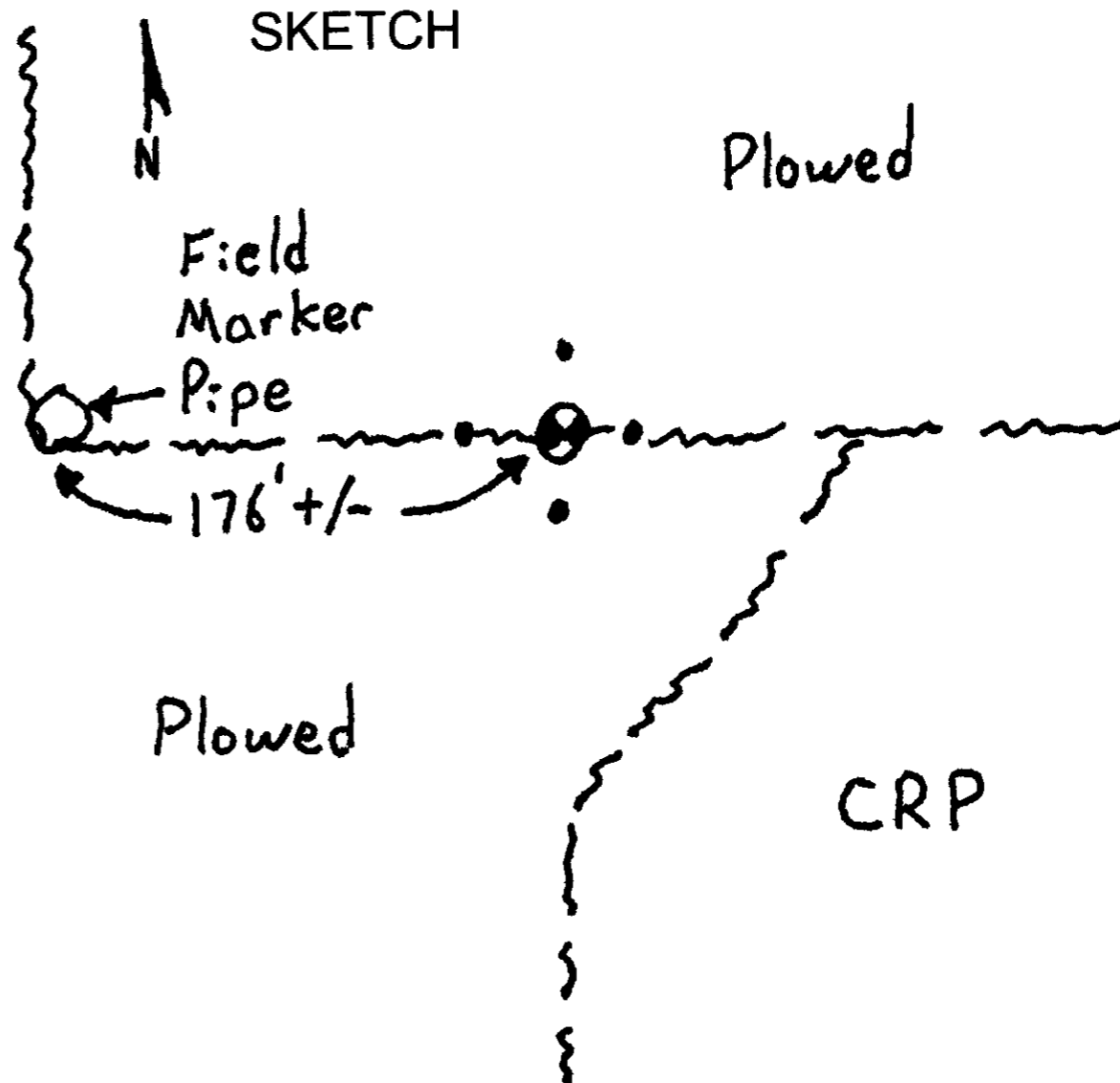

**MONUMENT (S) AND ACCESSORIES SET (Procedures and Description)**

At the intersection described above, I set a 2 3/8" brass cap on a 1 1/2" x 30" galvanized iron pipe stamped as shown in the diagram above 24" below the surface of the farmed field.

For references, I set four 5/8" by 24" iron rebars with 1 1/4" orange plastic caps stamped WTS and 56295LS as described below 20" below the surface:

- an iron rebar bears S88°37'20"W, 25.03 feet;
- an iron rebar bears N3°07'49"E, 23.17 feet;
- an iron rebar bears S84°14'35"E, 24.98 feet;
- an iron rebar bears S5°00'01"W, 25.99 feet;

The monument and references were tied using a Trimble R7/R8 RTK GPS system.

Location and comments  
 NAD 83/1991 State Plane Coordinate  
 Oregon North Zone  
 N = 833725.28 ift  
 E = 8757139.41 ift

Compass Declination

Surveyors Seal

RECEIVED BY:  
 Umatilla County Surveyor  
 Date: 12/6/2012  
 Rec'd By: S. Haddock  
 No. 12-155-B

Firm / Agency  
 Witness Tree Surveying  
 Address  
 P.O. Box G  
 Pilot Rock, Or. 97868  
 Party Chief  
 Stephen K, Haddock

REGISTERED  
 PROFESSIONAL  
 LAND SURVEYOR

*Stephen K. Haddock*

OREGON  
 JULY 9, 2001  
 STEPHEN K. HADDOCK  
 56295LS

RENEWAL DATE 6-30-13