

OREGON CORNER RESTORATION FORM

COUNTY: Umatilla. DATE: 04/17/08

CORNER DESIGNATION: Z-3, The South One-Quarter Corner of Section 31, Township 6 North, Range 36 East, W.M..

PREVIOUS RENEWALS/SURVEYS ETC.: Corner originally established by Odell & Lewis under GLO Contract No. 110, dated February 7, 1865. Notes state: Set 1/4 Sec. post on level. Drove charred stake; dug pits & raised mound, as per instructions. John Kimbrell recovered this corner in his survey recorded at Book 1, Page 402, Record of Private Surveys. Kimbrell did not survey East or West of this corner, and does not state what was found. Kimbrell surveyed South from the North 1/4 corner of Section 31, but his bearing cannot be accurately determined, and we are not able to recover the Center 1/4 Corner established by him. Kimbrell did tie the railroad track, (which still exists), but the bearing of the track relative to the N-S centerline of the section does not allow for an accurate bearing determination of the N-S centerline of section.

MONUMENT AND ACCESSORIES FOUND: None. Corner falls in center pivot circle with no features. The 1956 ASCS photos clearly shows a North-South fence line running through this corner, but the farming pattern has changed and the field line has been gone for years.

MONUMENT MARKING DETAIL:

T6N R36E
1 S31
4 S6
T5N
2008
PLS 1106

MONUMENT SET: Proportioning this corner between the Southeast and Southwest Corners of Section 31 would result in the wrong corner location, based on field lines shown on the 1956 photos. The record closing dimension from the original Odell and Lewis survey cannot be trusted because Odell and Lewis seldom, (if ever), "closed" on controlling lines. Scaling from the old photos, indicates the old North-South field line running through the corner area is approximately 7950 feet West of the recovered Southeast Corner of Section 32. I reestablished this corner point on the parallel of latitude, 2649.77 feet from the Southeast Corner of Section 31. 2649.77 feet is the identical distance for "half miles" measured on the South line of Section 32. At the reestablished corner point, set a 2 3/8" brass cap on a 1 1/4" x 30" galvanized iron pipe, with cap buried 18" below ground level, marked as shown on "Monument Marking Detail".

New accessories:

- A silver deep-1 magnet bears North 37° East, 25.6 feet.
 - A purple deep-1 magnet bears South 64° East, 31.3 feet.
 - A blue deep-1 magnet bears South 35 1/2° West, 29.0 feet.
 - An orange deep-1 magnet bears North 28 1/2° West, 26.4 feet.
- Magnets are buried 20" below ground level with bearing object signs.

LOCATION AND COMMENTS: Corner in located in a irrigated circle. No nearby features.
OREGON STATE PLANE COORDINATE, North Zone, NAD 83(91), International Feet:

N = 838749.59
E = 8746144.24

FIRM: Wells Surveying
P.O. Box 1696
Pendleton, OR 97801

COMPASS DECLINATION: 18° East

Surveyor's Seal

Witnesses: Jason Wells, LSIT

\6N36Z3

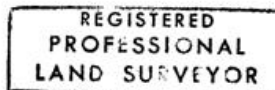

Will. R. Wells

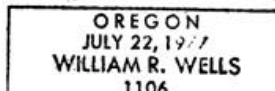

09-10-C