

OREGON CORNER RESTORATION FORM

COUNTY: Umatilla DATE: 01/27/05

CORNER DESIGNATION: 5N35, Z-13, The Southeast Corner of Section 33.

PREVIOUS RENEWALS/SURVEYS ETC.:

Corner originally established by Odell & Lewis, under GLO Contract No. 110, dated February 7, 1865. Notes state: Set post Cor. for Secs. 33 & 34 on level; drove charred stake; dug pits; and made mound, as per instructions.

MONUMENT AND ACCESSORIES FOUND: None.

MONUMENT MARKING DETAIL:

SC
T5N R35E
S33 | S34
2005
PLS 1106

MONUMENT SET:

I held the intersection of the centerline of East-West Watts road with a field line extending North as best remaining evidence of the original location of this corner. See Survey No. 02-021-C for additional information. At the re-established corner point, set a 2 1/2" brass cap on a 1 1/4 by 30" galvanized iron pipe with cap 12" below road surface, marked as shown in Monument Marking Detail.

New accessories:

A silver deep-1 magnet buried 20" in ground bears North 58° East, 48.8 feet.

A 5/8" x 30" iron rebar with 1 1/4" yellow plastic cap stamped "OR PLS 1106, WA PLS 17372", set flush with the ground bears South 81° East, 60.1 feet.

A 5/8" x 30" iron rebar with 1 1/4" yellow plastic cap stamped "OR PLS 1106, WA PLS 17372", set flush with the ground, bears South 83° West, 71.9 feet.

A 3/4" brass washer stamped "PLS 1106", 1.0 foot above ground level in power pole #340000 bears North 20° West, 17.3 feet.

Wired bearing object signs to rebar accessories. Attached bearing object sign and "witness" sign to PP&L pole.

LOCATION AND COMMENTS: Corner is center line of Watts Road, in line with a field line running north.

OREGON STATE PLANE COORDINATE, North Zone, NAD 83(91), International Feet:

N = 806475.13
E = 8728537.94

FIRM: William R. Wells, PLS
P.O. Box 1696
Pendleton, OR 97801

COMPASS DECLINATION: 18° East

Surveyor's Seal

Witnesses: Jason Wells, LSIT
Brian Cole

/5N35Z13

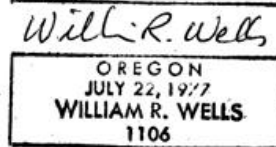
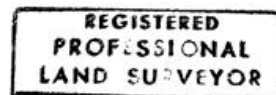

RENEWS 6/30/06

05-112-C