

OREGON CORNER RESTORATION FORM

COUNTY: Umatilla DATE: 02/08/05

CORNER DESIGNATION: 5N35, V-21, The Northeast Corner of Section 35.

PREVIOUS RENEWALS/SURVEYS ETC.:

Corner originally established by Odell & Lewis, under GLO Contract No. 110, dated February 7, 1865. Notes state: Set post Cor. for Secs. 25, 26, 35 & 36. Drove charred stake; dug pits, raised mound, as per instructions.

State Highway Map No. 88-11-21, circa 1958, show a "fence corner" with state plane coordinate, on the South side of Blue Mountain Station road. This map also shows a "iron pipe", with coordinate at the Northwest corner of Section 25 and a "fence corner" with coordinate, at the West one-quarter corner of Section 36.

MONUMENT AND ACCESSORIES FOUND: None.

MONUMENT MARKING DETAIL:

T5N R35E
S26 | S25
S35 | S36
2005
PLS 1106

MONUMENT SET:

I re-established this corner by holding the existing centerline of Blue Mountain Station Road, running East-West, for latitude and the calculated position of the "fence corner" per State Highway Map No. 88-11-21, for departure. At the re-established corner position, set a 2 1/2" brass cap on a 1 1/4" by 30" galvanized iron pipe, with cap 12" below road surface, marked as shown in Monument Marking Detail. There are no remains of fences in this area at this time.

New accessories:

A silver deep-1 magnet, buried 2 feet, bears North 38° East, 26.8 feet.

A 5/8" x 24" rebar with yellow plastic cap marked "OR PLS 1106, WA PLS 17372" bears South 65° East, 44.5 feet.

A 5/8" x 30" rebar with yellow plastic cap marked "OR PLS 1106, WA PLS 17372" bears South 70 1/2° West, 52.0 feet. Set a steel fence post 1.0 feet Southwest of this accessory with "witness" sign attached.

An orange deep-1 magnet, buried 2.3 feet, bears North 37° West, 26.2 feet.

Buried bearing object signs with deep-1 magnets. Wired bearing object signs to the rebar accessories.

LOCATION AND COMMENTS: Corner is at the centerline of East-West Blue Mountain Station Road.

OREGON STATE PLANE COORDINATE, North Zone, NAD 83-91, International Feet:

N = 811763.37
E = 8739100.94

FIRM: William R. Wells, PLS
P.O. Box 1696
Pendleton, OR 97801

COMPASS DECLINATION: 18° East

Witnesses: Jason Wells, LSIT
Brian Cole

/5N35V21

Surveyor's Seal

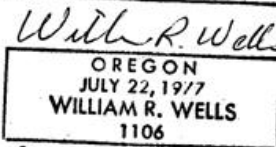
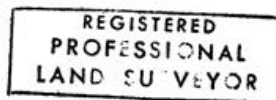

Renews 6/30/06

05-112-C