

**OREGON CORNER RESTORATION FORM**

COUNTY: Umatilla DATE: 02/15/05

CORNER DESIGNATION: 5N35, R-11, The South Quarter Corner of Section 21.

**PREVIOUS RENEWALS/SURVEYS ETC.:**

Corner originally established by Odell & Lewis, under GLO Contract No. 110, dated February 7, 1865. Notes state: Set 1/4 Sec. post; drove charred stake; dug pits & raised mound, as per instructions.

In Record of Private Surveys, Survey No. 106, the corner was not found and was re-established by Survey. A 20 x 20 x 5 inch stone, marked "1/4" was set for the re-established corner. Survey No. 182, recovered this stone.

**MONUMENT AND ACCESSORIES FOUND:**

Railroad tie fence corner with fence and field berms running East, West, and South, and a field berm running North.

**MONUMENT MARKING DETAIL:**

T5N R35E  
1 S21  
4 S28  
2005  
PLS 1106

**MONUMENT SET:**

I accepted a railroad tie fence corner with fence and field lines running East, West and South and a field berm running North as best remaining evidence of original corner location. At the north side of the railroad tie fence corner, set a 2 1/2" brass cap on 2 1/2" x 30" galvanized iron pipe, 30" in the ground with cap marked as shown in Monument Marking Detail.

**New accessories:**

A 5/8" x 24" rebar with yellow plastic cap marked "OR PLS 1106, WA PLS 17372" bears South 86° East, 55.2 feet.

A 5/8" x 24" rebar with yellow plastic cap marked "OR PLS 1106, WA PLS 17372" bears South 86° East, 28.8 feet.

A 5/8" x 24" rebar with yellow plastic cap marked "OR PLS 1106, WA PLS 17372" bears South 03° West, 38.4 feet.

A 5/8" x 24" rebar with yellow plastic cap marked "OR PLS 1106, WA PLS 17372" bears North 87° West, 37.2 feet.

Wired bearing object signs to the rebar accessories. Nailed "witness" sign to the railroad tie post near the corner.

**LOCATION AND COMMENTS:** Survey No. 106 calls for a 20" x 20" x 5" stone. We probed and dug around railroad tie fence corner without finding a stone this size. There are several piled stones around the railroad tie post.

**OREGON STATE PLANE COORDINATE, North Zone, NAD 83(91), International Feet:**

N = 817195.90  
E = 8725708.45

**FIRM:** William R. Wells, PLS

P.O. Box 1696

Pendleton, OR 97801

**COMPASS DECLINATION:** 18° East

**Witness:** Brian Cole

/5N35R11

Surveyor's Seal

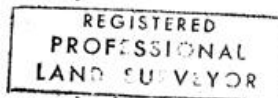

*William R. Wells*  
OREGON  
JULY 22, 1977  
WILLIAM R. WELLS  
1106

Renews 6/30/06

05-112-C