

OREGON CORNER RESTORATION FORM

COUNTY: Umatilla DATE: 03/03/05

CORNER DESIGNATION: 5N35, P-25, The East Quarter Corner of Section 24.

PREVIOUS RENEWALS/SURVEYS ETC.:

Corner originally established by Odell & Lewis, under GLO Contract No. 110, dated February 7, 1865. Notes state: Set post Cor. for 1/4 Sec. Land gently dipping to the E. Drove charred stake; dug pits & raised mound, as per instructions.

MONUMENT AND ACCESSORIES FOUND: None.

MONUMENT MARKING DETAIL:

T5N
R35E R36E
1/4
S24|S19
PLS 1106

MONUMENT SET:

Corner position as re-established by single proportion measure between the Northeast Corner of Section 24 and the calculated position of the Southeast corner of Section 24, per this survey. At re-established corner position, set 2 1/2" brass cap on a 1 1/4 x 30" galvanized iron pipe with cap 20" below ground surface, marked as shown in Monument Marking Detail.

New accessories:

- A 5/8" x 24" iron rebar with a 1 1/4" yellow plastic cap marked "OR PLS 1106, WA PLS 17372", with cap 1" above ground level, bears South 13° West, 41.8 feet.
 - A 5/8" x 24" iron rebar with a 1 1/4" yellow plastic cap marked "OR PLS 1106, WA PLS 17372", with cap 1" above ground level, bears South 39° West, 12.85 feet.
 - A 5/8" x 24" iron rebar with a 1 1/4" yellow plastic cap marked "OR PLS 1106, WA PLS 17372", with cap 1" above ground level, bears North 14 1/2° West, 33.7 feet.
 - A 5/8" x 24" iron rebar with a 1 1/4" yellow plastic cap marked "OR PLS 1106, WA PLS 17372", with cap 1" above ground level, bears North 09° West, 60.4 feet.
- Attached bearing object signs to all rebar accessories.

LOCATION AND COMMENTS: Corner is located 10 feet East of a North-South fence and edge of a farmed field.

OREGON STATE PLANE COORDINATE, North Zone, NAD 83(91), International Feet:

N = 819728.77
E = 8743874.56

FIRM: William R. Wells, PLS
P.O. Box 1696
Pendleton, OR 97801

COMPASS DECLINATION: 18° East

Surveyor's Seal

Witnesses: Jason Wells, LSIT
Brian Cole

/5N35P25

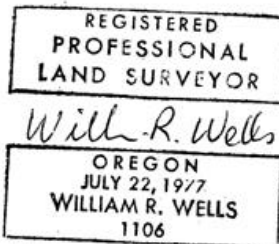

Renews 6/30/06

05-112-C