

OREGON CORNER RESTORATION FORM

COUNTY: Umatilla DATE: 02/22/05

CORNER DESIGNATION: 5N35, J-19, The South Quarter Corner of Section 11.

PREVIOUS RENEWALS/SURVEYS ETC.:

Corner originally established by Odell & Lewis, under GLO Contract No. 110, dated February 7, 1865. Notes state: Set 1/4 Sec. post; drove charred stake; dug pits & raised mound, as per instructions. Record of Private Surveys, Survey No. 5, calls for the government corner being recovered and Survey No. 36 calls for establishing a 14 x 12 x 7 inch stone at the corner point.

MONUMENT AND ACCESSORIES FOUND: None.

MONUMENT MARKING DETAIL:

T5N R35E
1 S11
4 S14
2005
PLS 1106

MONUMENT SET:

Corner position was re-established by single proportion measurement, midway between the Southwest and Southeast corners of Section 11. At the re-established corner point, set a 2 1/2" brass cap on a 1 1/4" x 30" iron pipe with cap 20" below ground level, marked as shown on Monument Marking Detail.

New accessories:

A silver deep-1 magnet buried 20" below ground level, bears North 36° East, 49.3 feet.
A purple deep-1 magnet buried 20" below ground level, bears South 59° East, 38.6 feet.
A blue deep-1 magnet buried 20" below ground level, bears South 65° West, 36.6 feet.
An orange deep-1 magnet buried 20" below ground level, bears North 51° West, 44.9 feet.
Buried bearing object signs with deep-1 magnets.

LOCATION AND COMMENTS: Corner is located about 15 feet South of an East-West field berm. There are no other features.

OREGON STATE PLANE COORDINATE, North Zone, NAD 83(91), International Feet:

N = 827805.98
E = 8736094.48

FIRM: William R. Wells, PLS
P.O. Box 1696
Pendleton, OR 97801

COMPASS DECLINATION: 18° East

Surveyor's Seal

Witnesses: Jason Wells, LSIT
Brian Cole

/5N35J19

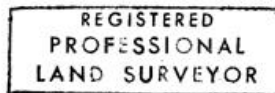

William R. Wells

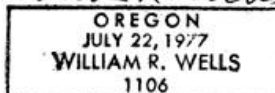

Renews 6/30/06

05-112-C