

History of original corner establishment:

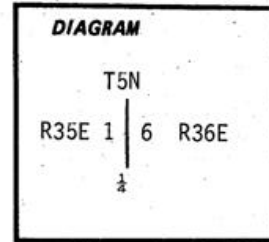

Description of corner evidence found:

None.

Description of monument and accessories established to perpetuate the original location of this corner:

At the proportionate point between the NE and SE corner of Sec. 1, T5N R35E, as determined by survey, we set a 2"x30" galvanized iron pipe, buried 10" in a gravel roadway, with brass cap attached, marked:

Placed steel fence post with location poster attached approximately 20 feet west of corner location.

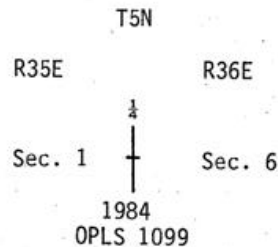

Witnesses: Gary L. Langlitz  
A. Ray Crapo  
June 6, 1984

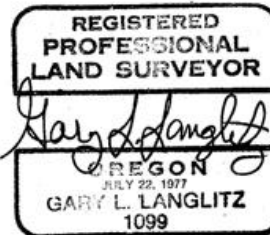

Office of Surveyor County of Umatilla  
State of Ore. I hereby certify that the within instrument was filed in this office  
for record on the 19<sup>th</sup> day of July 1984  
Dave Krumbein by Betty Cochran  
(COUNTY OFFICIAL) (DEPUTY)