

OREGON CORNER RESTORATION FORM

SECTION 16 TOWNSHIP 5N RANGE 28E L-9

COUNTY: UMATILLA DATE 1/90

CORNER DESIGNATION

W 1/4 Corner

CONDITION REPORT ONLY

- NOT FOUND
- RENEWED
- UNRECORDED
- SURVEYED IN
- REFERENCED OUT

PREVIOUS RENEWALS/SURVEYS, ETC.

Original survey by Davenport in 1861 under Contract #101.
DEPENDENT RESURVEY TUERS 1975

MONUMENTS & ACCESSORIES FOUND: Condition and Source

Found 1 1/2" l. pipe 0.90 ft. below surface of ground.
Found Brass Cap Witness Corner. S 83° 55' 31" W 41.9 ft.
SET BY TUERS 1975 DEPENDENT RESURVEY

MONUMENT DETAIL



SKETCH

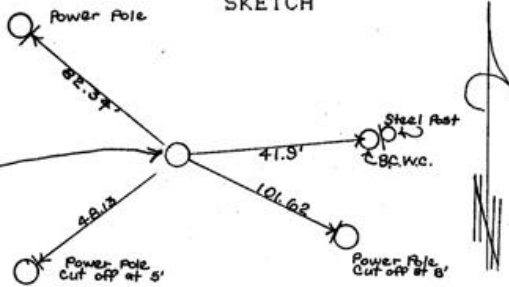

MONUMENT SET (PROCEDURES AND DESCRIPTION)

Over found 1 1/2" l. Pipe, set a 2 1/2" Brass Cap in conc. at 0.3 ft. below ground level, stamped as shown.

NEW ACCESSORIES

From which
Set a steel post behind found WC, attached Bearing Object and Witness Cor. signs, N 83 55 31 E 41.9 ft.
A power pole cut off at 8' high S 64° 21' 20" E 101.62 ft. w/Alum. Tag #951 & Bearing Object sign attached.
A power pole cut off at 5' high S 52° 00' 00" W 48.13 ft. w/ Alum. Tag #951, Bearing Object & Witness Cor. signs attached.
A power pole w/Alum. Tag #951, Bearing Object sign attached, N 51 47 30 W 82.34 ft.

LOCATION & COMMENTS

From the intersection of River Rd and unknown gravel rd. go along gravel rd. abt. 0.1 mi. to corner, in driveway to left.

SURVEYOR'S SEAL

COMPASS DEC.
FIRM EDWARDS SURVEYING
P.O. BOX 763, HERMISTON,
OREGON, 97838
PARTY CHIEF D. EDWARDS
NOTES
WITNESS J. COPPOCK

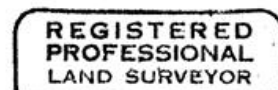

D. Dennis Edwards

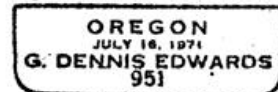

RECEIVED BY

Umatilla County Surveyor
Date 1-91
Rec'd By JA
No. 91-01-B