

OREGON CORNER RESTORATION FORM

SECTION 17 TOWNSHIP 5N RANGE 28E L-5

COUNTY: UMATILLA DATE 1/90

CORNER DESIGNATION

W 1/4 Corner

- CONDITION REPORT ONLY
- NOT FOUND
- RENEWED
- UNRECORDED
- SURVEYED IN
- REFERENCED OUT

PREVIOUS RENEWALS/SURVEYS, ETC.

Original survey by Davenport in 1861, under Contract #101.

MONUMENTS & ACCESSORIES FOUND: Condition and Source

Found a splintered 3/4" ID galvanized pipe approximately 30" long with a metal (steel) plug driven into the top with a punch mark at the center. Pipe was bent. Also found a steel post with a USACE witness sign attached. N 71° 50' E 1.74 ft from galv. pipe.

MONUMENT DETAIL



SKETCH

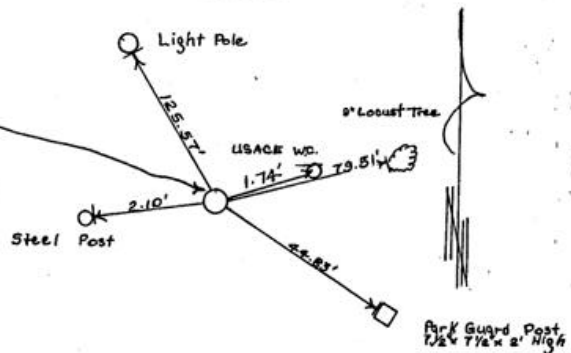

MONUMENT SET (PROCEDURES AND DESCRIPTION)

At the location of the found 3/4" I. pipe, set a 2 3/8" Brass Cap attached to the top of a 1"x30" galv. pipe marked as shown and 0.4 ft. above the surface of ground. Placed found 3/4" alongside and raised a mound of soil around cap.

NEW ACCESSORIES

- from which
- A light pole N 30° 47' 27" W 125.57 ft. w/Alum. Tag #951, Bearing Object & Witness Cor. signs attached.
- A 9" Locust tree; N 74° 19' 13" E 79.51 ft. w/Bearing Object sign & Alum. Tag #951 attached. Distance to Alum. Tag.
- A Park Guard post S 57° 27' 17" E 44.83 ft. Bearing Object & Witness Cor. signs w/Alum. Tag #951 attached.
- A steel post S 81° 52' W 2.10 ft. w/ Bearing Object, Witness Corner signs attached. (All distances to Alum. Tags).

LOCATION & COMMENTS

On 7th St between "B" & "C" St., City of Umatilla, OR., go SSW approx. 130 ft. to the corner.

SURVEYOR'S SEAL

COMPASS DEC.  
 FIRM EDWARDS SURVEYING  
 P.O. BOX 763, HERMISTON,  
 OREGON, 97838  
 PARTY CHIEF D. EDWARDS  
 NOTES  
 WITNESS J. COPPOCK

REGISTERED  
 PROFESSIONAL  
 LAND SURVEYOR

*J. Dennis Edwards*

OREGON  
 JULY 16, 1871  
 G. DENNIS EDWARDS  
 951

RECEIVED BY

Umatilla County Surveyor  
 Date 1-91  
 Rec'd By KA  
 No. 91-01-B