

OREGON CORNER RESTORATION FORM

COUNTY: Umatilla DATE: February 1998

CORNER DESIGNATION: J-21, Northeast corner Section 14, T5N., R28E., W.M.

PREVIOUS RENEWALS/SURVEYS ETC.: Original GLO Survey by Timothy W. Davenport, under Contract No. 101, dated August 5, 1861. Notes state: Set post Cor. to Secs. 11, 12, 13 & 14; made mound; drove charred stake, as per instructions. Umatilla County Survey #89-36-A, G. Dennis Edward states: Found brass cap in conc. U.S. no date, could be 1959. Remonumented by Harmon E. McLendon, Umatilla County Survey records #97-130-R, dated May 12, 1997. Record states: An 8-inch diameter concrete cylinder with top broken off was found at the corner position. Two 1/2" rebars without caps on either side of Beach Access Road as set by Dennis Edwards, Umatilla County Survey #88-45-C. A hole was drilled in existing concrete and a 3-inch brass disk with a 2-inch stem was epoxied into hole. Marked as shown in "Monument Marking Detail".

MONUMENT AND ACCESSORIES FOUND:

Found a 3" brass cap in concrete post 4" below ground surface stamped as shown in "Monument Marking Detail", from which:

A 1/2" iron pin bears S89°44'40"W, 11.50 feet.

A 1/2" iron pin bears S89°44'40"W, 69.25 feet.

MONUMENT MARKING DETAIL:

T5N R28E

S11 | S12

S14 | S13

1997

OPLS 2537

MONUMENT SET:

New Accessories:

A brass washer stamped "PLS 1106" in West side of UECA pole #120000, 1.0 foot above ground bears N 15° W, 15.72 feet.

A 4" diameter gas pipeline identifier pipe bears N 90° W, 17.92 feet.

A brass washer stamped "PLS 1106" on South side of UECA pole #119000, 1.0 foot above ground bears N 80° W, 69.0 feet.

A brass washer stamped "PLS 1106" in West side of UECA pole #120001, 1.0 foot above ground bears N 79° E, 63.95 feet.

All accessories have bearing object tags attached.

Corner has a steel fence post with witness sign attached 1.0 foot North.

LOCATION AND COMMENTS: On Beach Access P.D. by new Corrections Institute Access Road.

COMPASS DECLINATION: 18° East

Surveyor's Seal

Witnesses: John Linder, LSIT

Jason Wells

Oregon State Plane Coordinates, North Zone, NAD 83(91), Int. Feet:

North: 824989.02

East: 8516238.06

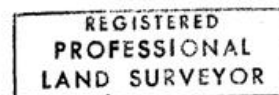

William R. Wells

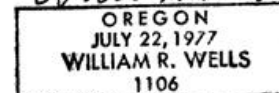

98-101-c

Renews 6-30-98