

Index
File No. V-25
T 4S R. 33KE
Merid. WM

CORNER RECORD (SEARCH)

(Ref. FSM 7151.4)

Tract or
Survey No. _____
Cor. No. V-25

R.D. UKIAH County UMATILLA
N.F. UMATILLA State ORE.

CORNER DIAGRAM

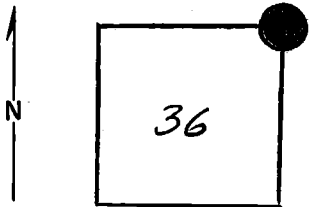

DESCRIBE CORNER MONUMENT FOUND

MOUND OF STONE

DESCRIBE BEARING TREES OR OTHER OFFICIAL ACCESSORIES FOUND

FOUND NE AND SW BT

A 9" PINE, S33W, 13.2 FT. SCRIBES VISIBLE
A 14" PINE SWAG N66E, 39.6 FT

PHOTO IDENTIFICATION DATA

Photo No. _____
Filed At. _____
Object Ident. _____
Ident. By _____
Signature

PLANE COORDINATE POSITION DATA

State _____ Zone _____
X _____
Y _____
Estab. By _____
Agency

DESCRIBE CORNER LOCATION RELATIVE TO NEAR-BY FEATURES, ALSO HOW TO REACH CORNER

Signature

Title

Division

Headquarters

Date

7100-52 (3/68)

(20)

D.D. Smith

SURVEYOR

12/75

4
5

CORNER RECORD (PERPETUATION) ✓

MONUMENT: DESCRIBE NEW MONUMENT SET, OR WORK DONE TO PRESERVE EXISTING MONUMENT

SET 2 1/2" X 30" IRON PIPE WITH BRASS CAP AT RECORD
DISTANCES FROM THE NE AND SW B.Ts.

ACCESSORIES: DESCRIBE NEW B.T.'s WITNESS OBJECTS ETC. ESTABLISHED, OR WORK DONE TO PRESERVE EXISTING EVIDENCE 9

NEW B.Ts

A 20" PINE N47E, 54.8 FT

A 9" PINE S46E, 50.4 FT

A 18" PINE N65W, 29.4 FT

Work Done By D.I. GRIFFITH Title SURVEYOR Date 12/75 State Registration No. or Agency ORE PLS 642 10

Certified Cor. Record Prepared? Yes No Filed At: WATKINS CO. CT. HO. Date 12/75 11

REMARKS

SEE MAP OF SURVEY DATED DEC. 1975

Index File No. V-25 T. 4S R. 33E W. M.

Tract or Surv. No.

Cor. V-25 12
13

Index
File No. V-1

CORNER RECORD (SEARCH)
(Ref. FSM 7151.4)

Tract or
Survey No. _____
Cor.
No. V-1

T 45 R. 34E R.D. Ukiah County Umatilla
Merid. W11 N.F. Umatilla State Ore.

CORNER DIAGRAM

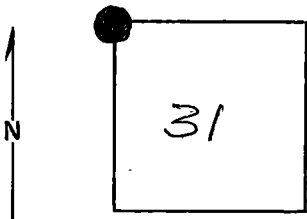

DESCRIBE CORNER MONUMENT FOUND

See T45, R33 1/2 E, V-25
Brass Cap!

DESCRIBE BEARING TREES OR OTHER OFFICIAL ACCESSORIES FOUND

PHOTO IDENTIFICATION DATA

Photo No. _____
Filed At. _____
Object Ident. _____
Ident. By _____

Signature

PLANE COORDINATE POSITION DATA

State _____ Zone _____
X _____
Y _____
Estab. By _____

Agency

DESCRIBE CORNER LOCATION RELATIVE TO NEAR-BY FEATURES, ALSO HOW TO REACH CORNER

Signature

J. Hollamon

Title

Division

Headquarters

Date

12/75

7100-52 (3/68)

CORNER RECORD (PERPETUATION)

MONUMENT : DESCRIBE NEW MONUMENT SET, OR WORK DONE TO PRESERVE EXISTING MONUMENT

9

ACCESSORIES : DESCRIBE NEW BT's WITNESS OBJECTS ETC. ESTABLISHED, OR WORK DONE TO PRESERVE EXISTING EVIDENCE

10

Work Done By _____ Title _____ Date _____ State Registration No. or Agency _____

Certified Cor. Record Prepared ? Yes No Filed At: _____ Date _____

11

REMARKS

12

Index File No. T. R. M. Tract or Surv. No. Cor. 13