

Index  
File No. N-19

CORNER RECORD (SEARCH)

(Ref. FSM 7151.4)

Tract or Survey No. \_\_\_\_\_ Cor. No. \_\_\_\_\_

T 4S R. 33 1/2 E

R.D. LaGrande County Union

Merid. Willamette

N.F. W-W State OREGON

CORNER DIAGRAM

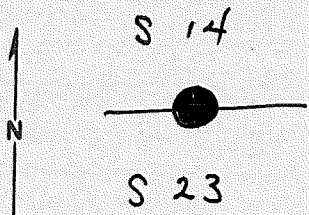

DESCRIBE CORNER MONUMENT FOUND

Original basalt stone, 16 x 12 x 6" loosely set in a mound of stone.

DESCRIBE BEARING TREES OR OTHER OFFICIAL ACCESSORIES FOUND

Ponderosa pine, 22" dia, hrs S56 E, 152 lks, w/ frag. Scribe marks visible on open blaze.

PHOTO IDENTIFICATION DATA

Photo No. \_\_\_\_\_

Filed At. \_\_\_\_\_

Object Ident. \_\_\_\_\_

Ident. By \_\_\_\_\_

Signature

PLANE COORDINATE POSITION DATA

State \_\_\_\_\_ Zone \_\_\_\_\_

X \_\_\_\_\_

Y \_\_\_\_\_

Estab. By \_\_\_\_\_

Agency

Signature

Title

Division

Headquarters

Date

7100-52 (3, 68)

**CORNER RECORD (PERPETUATION)**

**MONUMENT: DESCRIBE NEW MONUMENT SET, OR WORK DONE TO PRESERVE EXISTING MONUMENT**

Set Brass Cap mkd:

T4S R33 1/2E  
 1/4 S14  
 S23  
 1977

**ACCESSORIES: DESCRIBE NEW BT'S WITNESS OBJECTS ETC. ESTABLISHED, OR WORK DONE TO PRESERVE EXISTING EVIDENCE**

Ponderosa pine, 13" dia, brs N48W, 121 Pks, mkd 1/4 S14 BT.

Deposit Corner stone and set a 5' steel fence post alongside  
 Iron post.

Work Done By BCM Title \_\_\_\_\_ Date 9/77 State Registration No. \_\_\_\_\_  
 or Agency \_\_\_\_\_

Certified Cor. Record Prepared? Yes  No  Filed At: \_\_\_\_\_ Date \_\_\_\_\_

**REMARKS**

Index  
File No. N-19

CORNER RECORD (SEARCH)

(Ref. FSM 7151.4)

Tract or  
Survey No. \_\_\_\_\_

Cor.  
No. N-19

T 45 R. 33 1/2 E

R.D. Uria County Umatilla

Merid. Will.

N.F. Umatilla State Oregon

CORNER DIAGRAM

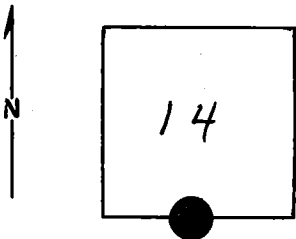

DESCRIBE CORNER MONUMENT ~~FOUND~~

SET

Brass Cap! 1977

DESCRIBE BEARING TREES OR OTHER OFFICIAL ACCESSORIES FOUND

Notes on file! see Monumentation File.

PHOTO IDENTIFICATION DATA

Photo No. \_\_\_\_\_

Filed At. \_\_\_\_\_

Object Ident. \_\_\_\_\_

Ident. By \_\_\_\_\_

*Signature*

PLANE COORDINATE POSITION DATA

State \_\_\_\_\_ Zone \_\_\_\_\_

X \_\_\_\_\_

Y \_\_\_\_\_

Estab. By \_\_\_\_\_

*Agency*

Signature

Title

Division

Headquarters

Date

7100-52-(3/68)

6

7

8

2

3

4

5

CORNER RECORD (PERPETUATION)

GPO 902-673

MONUMENT: DESCRIBE NEW MONUMENT SET, OR WORK DONE TO PRESERVE EXISTING MONUMENT

9

ACCESSORIES: DESCRIBE NEW BT'S WITNESS OBJECTS ETC. ESTABLISHED, OR WORK DONE TO PRESERVE EXISTING EVIDENCE

10

Work Done By \_\_\_\_\_ Title \_\_\_\_\_ Date \_\_\_\_\_ State Registration No. or Agency \_\_\_\_\_

Certified Cor. Record Prepared? Yes No Filed At: \_\_\_\_\_ Date \_\_\_\_\_

11

REMARKS

12

Index File No. T. R. M. Tract or Surv. No. Cor.

13