

Index

File No. X-17

CORNER RECORD (SEARCH)

(Ref. FSM 7151.4)

Tract or

Survey No. _____

Cor.

No. 1/4

T 45 R. 33E

R.D. UKiah

County Umatilla

Merid. Willamette

N.F. Umatilla

State Oregon

CORNER DIAGRAM

T45 R33E



1/4 S 34 | S 35

DESCRIBE CORNER MONUMENT FOUND

NONE

DESCRIBE BEARING TREES OR OTHER OFFICIAL ACCESSORIES FOUND

Numerous stones but none with visible markings. Possible BT Stump well rotted. Corner was set off the possible BT stump as this matches Pershiu's call to the Fresh water spring at 48.5 ch. North.

PHOTO IDENTIFICATION DATA

Photo No. _____

Filed At. _____

Object Ident. _____

Ident. By _____

Signature

PLANE COORDINATE POSITION DATA

State _____ Zone _____

X _____

Y _____

Estab. By _____

Agency

DESCRIBE CORNER LOCATION RELATIVE TO NEAR-BY FEATURES, ALSO HOW TO REACH CORNER

From Junction of UKiah - Hilgard Highway and Forest Road 54 GO North on Road 54 3.4 mi to Junction on right, turn right and drive 2.9 mile, corner uphill on left 75 feet.

Signature

David H. Kline

Title AS 933 Division

Headquarters

Date 10/83 7100-52-(3/68)

CORNER RECORD (PERPETUATION)

MONUMENT: DESCRIBE NEW MONUMENT SET, OR WORK DONE TO PRESERVE EXISTING MONUMENT

Set a 2 1/2" dia. Brass Cap on a 2 1/2" x 30" Galvanized Pipe
Set 6" in the Ground, Built Stone Mound around
Cap 4' dia. Marked!

745 R33E
1/4 S34 1/2 S35
1983
PLS 933

ACCESSORIES: DESCRIBE NEW BY'S WITNESS OBJECTS ETC. ESTABLISHED, OR WORK DONE TO PRESERVE EXISTING EVIDENCE

A 8" dia. Pond. Pine bears N 90° E 45.8 Feet scribed 1/4 S 35 BT
A 12" dia. Pond. Pine bears S 73° 30' W 22.0 Feet scribed 1/4 S 34 BT
Blazes are Painted Red and have Red bands painted around
them. Trees have signs Numbers 54-3, 54-4 & Brass washers
stamped PLS 933 nailed to them.

Work Done By D. Krumbin Title Surveyor Date 7/83 State Registration No. PLS 933
or Agency

Certified Cor. Record Prepared? Yes No Filed At: Umatilla County Date 10-1983

REMARKS

Fence runs NW - SE 45' West of corner.

USDA-FOREST SERVICE

Index

File No. X-17

CORNER RECORD (SEARCH)

(Ref. FSM 7151.4)

Tract or

Survey No. _____

Cor.

No. _____

T 4S R. 33E

R.D. UKIAH

County UMATILLA

Merid. WILL

N.F. UMATILLA

State OREGON

CORNER DIAGRAM

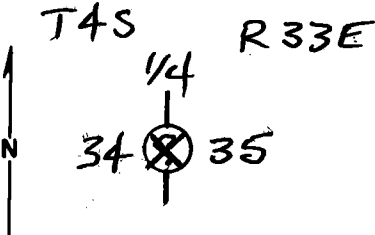

DESCRIBE CORNER MONUMENT FOUND

1 MOUND OF STONES AROUND METAL FENCE POST AT APPROX. CORNER POINT - NONE WITH VISIBLE MARKS.

(THIS COR FOUND IN 1944 - SEE ATTACHED)

DESCRIBE BEARING TREES OR OTHER OFFICIAL ACCESSORIES FOUND

2 LOW CUT POND. PINE STUMP W/NO VISIBLE MARKS BEARS N60°E, 46± FT. A BLAZED & POSTED (METAL FENCE POSTS W/OLD STYLE PROP. BDRY SIGNS) RUNS SOUTH & WEST OF THIS POINT. I CHAINED NORTH FROM ~~31.25~~ ^{34.35} ~~31.2~~ ^{31.2} &

DESCRIBE CORNER LOCATION RELATIVE TO NEAR-BY FEATURES, ALSO HOW TO REACH CORNER

3 FOUND TOPOGRAPHY OF RECORD TO FIT VERY WELL AT 40.00 CHAINS I FOUND THE ABOVE CORNER EVIDENCE, AND AT 48.50 CHAINS I FIND A FLOWING SPRING (JUST ABOVE ROAD CUT SLOPE). WHAT APPEARS TO BE AN OLD ATTENTION SIGN (FADED LETTERING - CAN'T READ) IS LYING ALONGSIDE STUMP.

THERE IS ALSO AN OLD K TAG ON A SMALL PINE 3 W OF CORNER

PHOTO IDENTIFICATION DATA
 Photo No. _____
 Filed At. _____
 Object Ident. _____
 Ident. By _____
 Signature _____

PLANE COORDINATE POSITION DATA

State _____ Zone _____
 X _____
 Y _____
 Estab. By _____
 Agency _____

Signature

Title

Division

Headquarters

Date

7100-52 (3. 68)

Dennis L. Hayward

PLS 1636

8-31-82

CORNER RECORD (PERPETUATION)

MONUMENT: DESCRIBE NEW MONUMENT SET, OR WORK DONE TO PRESERVE EXISTING MONUMENT

ACCESSORIES : DESCRIBE NEW BT'S WITNESS OBJECTS ETC. ESTABLISHED, OR WORK DONE TO PRESERVE EXISTING EVIDENCE

Work Done By _____ Title _____ Date _____ State Registration No. _____
or Agency _____

Certified Cor. Record Prepared ? Yes No Filed At: _____ Date _____

REMARKS

Index File No. T. R. M. Tract or Surv. No. Cor.

U. S. Department of Agriculture
FOREST SERVICE

X-17

UMBRELLA NATIONAL FOREST

CORNERS OF THE PUBLIC SURVEY

T. 4S R. 33E W.M. Mer.

1/4 Corner common to Sections
34, _____, and 35

Corner consists of a MOUND of Rock (dot) in place
State condition FAIR

Dimensions above ground _____ inches
Sketch grooves, letters, figures, or notches, on proper face or edge.

CARDINAL POSITION

DIAGONAL POSITION

N	W	S	E

NW	SW	SE	NE

Mound of _____ is located _____

_____ Pits are located _____

Sketch markings of Bearing Trees (or Rocks) in proper box and fill blanks below, giving bearings from Corner to Trees and Distances in Links.

<u>1/4S</u>			
<u>B.T.</u>			

Sp
Di
Be
Dis
Do
If n

Species PP
Diameter 16"
Bearing E
Distance 1 ch

Do you believe this to be a genuine Land Office Corner? YES
If not, why? _____

M

5/2/44
(Date)

Glenn B. Parsons
(Signature)
Senior scaler
(Title)

755

x-17

T. 45 R. 33E W^m Mer.

(Make sketch of topography near Corner and show section line markers thus "X")

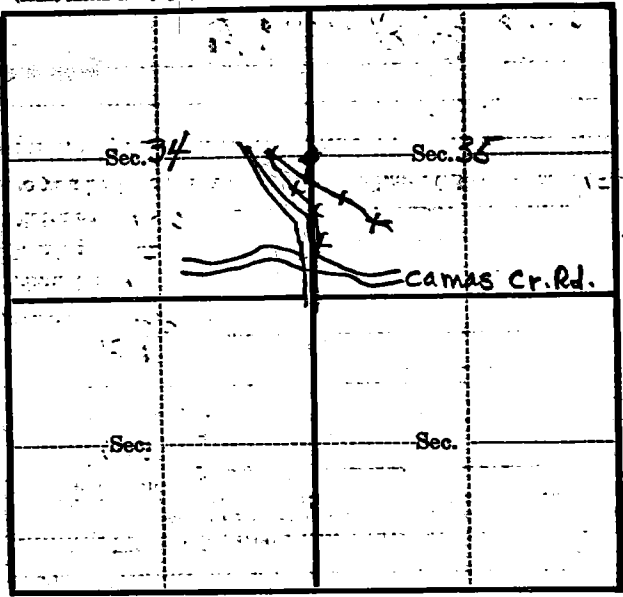

Metal Location Poster is on a PP
 tree 1 1/2 inches diameter, on the West
 side of the tree from which
 this Corner bears N 1/2 West, 1 Chains.
 (Bearing) (Distance)

Section line marker between Secs. 34 and 35 is on
 a 1 A Tree on the Bear Waller Road
 (Tree, post, etc.) (Name of road, trail, etc.)

located 7 1/2 chains E. 1/4 Sec. 34, from South; 1/4 Cor.; 1/2 corner
 (Cross out nonapplicable)

Give any further facts needed to find Corner again:
The corner is at the edge of
apple Reed Thicket, on the edge
of flat sloping down to Bayman Cr.
It is about 3 ch. North of a
wire fence.

Index
File No. X-17

CORNER RECORD (SEARCH)
(Ref. FSM 7151.4)

Tract or
Survey No. _____ Cor.
No. _____

T 4S R. 33E
Merid. Willamette

R.D. Ukiah County Umatilla
N.F. Umatilla State Oregon

CORNER DIAGRAM

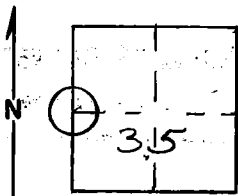

DESCRIBE CORNER MONUMENT FOUND
MATERIAL: Stone mound SIZE: 18" diameter
HEIGHT ABOVE GROUND: 1" high CONDITION: Poor
MARKINGS: None. Has been erected recently. Red-top stake
in mound marked $\frac{1}{4}$ corner. Does not fit topography very well.

DESCRIBE BEARING TREES OR OTHER OFFICIAL ACCESSORIES FOUND
No trace (there was only one original B.T.)
Mound bears N 26° W. approximately 130 feet, from center
of cattle guard on road S412.

PHOTO IDENTIFICATION DATA
Photo No. _____
Filed At. _____
Object Ident. _____
Ident. By _____
Signature

DESCRIBE CORNER LOCATION RELATIVE TO NEAR-BY FEATURES, ALSO HOW TO REACH CORNER

PLANE COORDINATE POSITION DATA
State _____ Zone _____
X _____
Y _____
Estab. By _____
Agency

Signature
T. Hollamon

Title Engineering Technician Division 660 Headquarters OW

Date
4-29-76

CORNER RECORD (PERPETUATION)

MONUMENT : DESCRIBE NEW MONUMENT SET, OR WORK DONE TO PRESERVE EXISTING MONUMENT

9

ACCESSORIES : DESCRIBE NEW BT'S WITNESS OBJECTS ETC. ESTABLISHED, OR WORK DONE TO PRESERVE EXISTING EVIDENCE

10

Work Done By _____ **Title** _____ **Date** _____ **State Registration No.** _____
or Agency _____

Certified Cor. Record Prepared ? Yes No **Filed At:** _____ **Date** _____

11

REMARKS

12

Index File No. **T.** **R.** **M.** **Tract or Surv. No.** **Cor.**

13