

Index

File No. Z-15

T 3S R. 33E

Merid. WILLAMETTE

CORNER RECORD (SEARCH)

(Ref. FSM 7151.4)

R.D. LA GRANDE Count: _____

N.F. WALLOWA-WHITMAN State OREGON

Tract or

Survey No. UMATILLA

Cor.

No. 1575

CORNER DIAGRAM

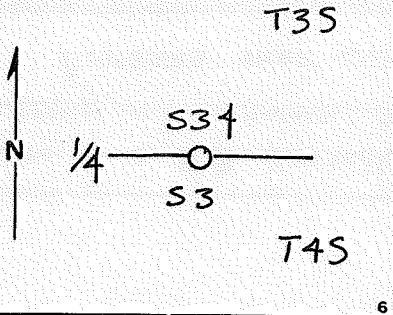

DESCRIBE CORNER MONUMENT FOUND

FND ORIGINAL STONE 14x8x6 WITH "1/4" ON NORTH FACE, FIRMLY IN PLACE.

DESCRIBE BEARING TREES OR OTHER OFFICIAL ACCESSORIES FOUND

18 1/2" FIR BEARS N60°E, 5.6 FT. TO MIDDLE OF TREE, BLAZE HEALED
13 1/2" P. PINE BEARS S8°W, 25.2 FT. TO MIDDLE OF TREE, BLS VISIBLE "1/4S"

PHOTO IDENTIFICATION DATA

Photo No. _____

Filed At. _____

Object Ident. _____

Ident. By _____

Signature _____

PLANE COORDINATE POSITION DATA

State _____ Zone _____

X _____

Y _____

Estab. By _____

Agency _____

DESCRIBE CORNER LOCATION RELATIVE TO NEAR-BY FEATURES, ALSO HOW TO REACH CORNER

FROM 2110-220 NORTHWESTERLY FROM 2110-048 .6 OF A MILE TO A 54-5 LOCATION POSTER ON A 6" FIR ON THE SOUTH SIDE OF THE ROAD, CORNER IS 350 FT. SOUTH.

Signature

B. Bullock

Title

LS 1848

Division

Headquarters

Date

6-84

FS-7100-52 (3/68)

CORNER RECORD (PERPETUATION)

MONUMENT: DESCRIBE NEW MONUMENT SET, OR WORK DONE TO PRESERVE EXISTING MONUMENT

SET 2 1/2" x 30" ALUMINUM CAPPED ALUMINUM PIPE RISING 12"
IN MOUND WITH ORIGINAL STONE IN HOLE ON NORTH SIDE. BRASS CAP
STAMPED:

T35 R33E
1/4 S34
S3
T45
R1S 1848
1984

ACCESSORIES : DESCRIBE NEW BT'S WITNESS OBJECTS ETC. ESTABLISHED, OR WORK DONE TO PRESERVE EXISTING EVIDENCE

Work Done By B.A. SUTTON Title SURVEYOR Date 6-84 State Registration No. LS 1848
or Agency

Certified Cor. Record Prepared ? Yes No Filed At ANNVILLE Co. SURVEYOR'S OFFICE Date

REMARKS

APPEARS THAT DISTANCES TO BT'S ARE REVERSED IN ORIGINAL NOTES.

Index File No. Z-15 T.35 R.33E W.M. Tract or Surv. No. Cor. 1575

Index
File No. Z-15

CORNER RECORD (SEARCH)

(Ref. FSM 7151.4)

Tract or
Survey No.

Cor. S. 1/4 COR.
No. SEC. 34

T 3S R. 33 E

R.D. LA GRANDE

County UNION

Merid. WILLAMETTE

N.F. WALLOWA WHITMAN

State OREGON

CORNER DIAGRAM

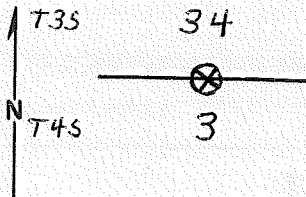

DESCRIBE CORNER MONUMENT FOUND

DESCRIBE BEARING TREES OR OTHER OFFICIAL ACCESSORIES FOUND

2 B.T.'s
16" douglas fir, live, old tags (1947)
12" ponderosa pine, live, hung yellow ribbon.

PHOTO IDENTIFICATION DATA

Photo No. ENW 1-323
Filed At.
Object Ident.
Ident. By
Signature

DESCRIBE CORNER LOCATION RELATIVE TO NEAR-BY FEATURES, ALSO HOW TO REACH CORNER

PLANE COORDINATE POSITION DATA

State Zone
X
Y
Estab. By
Agency

Signature
D. WYLAND

Title

Division

Headquarters

Date
5/73

7100-52-(3/68)

CORNER RECORD (PERPETUATION)

MONUMENT: DESCRIBE NEW MONUMENT SET, OR WORK DONE TO PRESERVE EXISTING MONUMENT

ACCESSORIES : DESCRIBE NEW BT'S WITNESS OBJECTS ETC. ESTABLISHED, OR WORK DONE TO PRESERVE EXISTING EVIDENCE

Work Done By _____ Title _____ Date _____ State Registration No. _____
or Agency _____

Certified Cor. Record Prepared ? Yes No Filed At: _____ Date _____

REMARKS

Index File No. T. R. M. Tract or Surv. No. Cor.

USDA-FOREST SERVICE

Index File No. Z-15

CORNER RECORD (SEARCH)

(Ref. FSM 7151.4)

Tract or Survey No. _____ Cor. No. _____

T 3S R. 33E

R.D. H.F. John Day County Umatilla

Merid. West

N.F. Umatilla State Orego

CORNER DIAGRAM

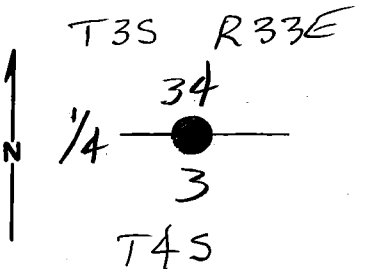

DESCRIBE CORNER MONUMENT FOUND

Orig stone marked 1/4

DESCRIBE BEARING TREES OR OTHER OFFICIAL ACCESSORIES FOUND

18" FIR N60°E, 5.6 ft w/heads by
13" Pond Pine S8°W, 25.2 ft w/sides visible

DESCRIBE CORNER LOCATION RELATIVE TO NEAR-BY FEATURES, ALSO HOW TO REACH CORNER

PHOTO IDENTIFICATION DATA

Photo No. _____
Filed At. _____
Object Ident. _____
Ident. By _____
Signature

PLANE COORDINATE POSITION DATA

State _____ Zone _____
X _____
Y _____
Estab. By _____
Agency

Signature

Title

Division

Headquarters

Date

7100-52-(3,68)

CORNER RECORD (PERPETUATION)

MONUMENT: DESCRIBE NEW MONUMENT SET, OR WORK DONE TO PRESERVE EXISTING MONUMENT

set Alum. Cap & Guard post

ACCESSORIES: DESCRIBE NEW BT'S WITNESS OBJECTS ETC. ESTABLISHED, OR WORK DONE TO PRESERVE EXISTING EVIDENCE

Work Done By Sutton Title LS Date 6-84 State Registration No. 1348
or Agency

Certified Cor. Record Prepared? Yes No. Filed At: Umatilla Co Date 6-84

REMARKS

Index File No. T. R. M. Tract or Surv. No. Cor.

2-15

35

33E