

CERTIFIED RECORD OF LAND CORNER MONUMENTATION

History of original corner establishment:

Corner established in 1882 by George S. Pershin, under General Land Office Contract No. 430. Surveyor General's records state:  
Set a basalt stone 12x10x8 ins. on slight south slope in open glade in mound of stone for 1/4 sec. cor. marked 1/4 on N face.

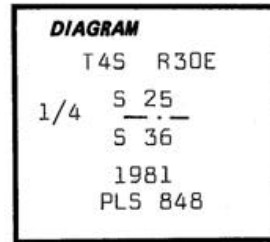

V-23

Description of corner evidence found:

The only mound of stone found is the remnants of an old fence line. Fence construction and maintenance over the years has destroyed all evidence.

No bearing trees originally established; therefore, set corner position by proportion.

Description of monument and accessories established to perpetuate the original location of this corner:

Set 3"x30" galv iron pipe with 3" brass cap stamped as shown on the diagram; set 12 inches in the ground and raised a mound of stone around the pipe.  
From which:  
A pine 20 inches base, forked at 30 inches, bears N22°W, 192.8 ft. scribed 1/4 S 25 BT.  
No tree available in Sec. 36.  
Set steel posts with warning and boundary signs 6 ft. North and 6 ft. East from corner.  
Nailed bearing tree sign and brass washer stamped PLS 848 to tree.  
Painted a red band around tree.

I hereby certify that the above corner was established as herein described on 7/30/81.

Witnesses: D. Mitchell Ferguson

Mike Woodward

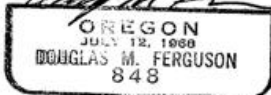
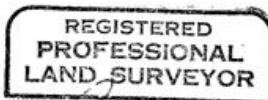

Office of Co. Surveyor..... County of Umatilla  
Oregon  
State of....., I hereby certify that the within instrument was filed in this office for record on the <sup>24th</sup> day of January, 1981  
David Kraum Klein by Betty Shatto  
(COUNTY OFFICIAL) (DEPUTY)

82-01B

T-2