

USDA-FOREST SERVICE

Index

File No. V-17

CORNER RECORD (SEARCH)

(Ref. FSM 7151.4)

Tract or

Survey No. _____

Cor.

No. _____

T 4S

R. 30E

R.D. Ukiah

County Umatilla

Merid. W.M.

N.F. Umatilla

State Or.

CORNER DIAGRAM



T4S R30E
S27 | S26
S34 | S35

DESCRIBE CORNER MONUMENT FOUND

2 1/2" I.P. with B.C. mkd:

T4S R30E
S27 | S26
S34 | S35
1978

DESCRIBE BEARING TREES OR OTHER OFFICIAL ACCESSORIES FOUND

- P. pine, 8", N80°E, 7.6 ft.
- P. pine, 27", S7°E, 25.5 ft.
- P. pine, 22", S55°W, 94.2 ft.
- D. fir stump, approx. 3' dia., S70-3/4°W, 35.0 ft.
- P. pine, 18", N9°W, 26.8 ft.

PHOTO IDENTIFICATION DATA

Photo No. _____

Filed At. _____

Object Ident. _____

Ident. By _____

Signature

PLANE COORDINATE POSITION DATA

State _____ Zone _____

X _____

Y _____

Estob. By _____

Agency

DESCRIBE CORNER LOCATION RELATIVE TO NEAR-BY FEATURES, ALSO HOW TO REACH CORNER

Cor. falls on S.E. slope. From K tag on 036 rd. go E. approx. 230'.

Signature

F.S. Munro

Title

L.S.

Division

Headquarters

Date

9/26/84

7100-52 (3/68)

CORNER RECORD (PERPETUATION)

MONUMENT: DESCRIBE NEW MONUMENT SET, OR WORK DONE TO PRESERVE EXISTING MONUMENT

ACCESSORIES : DESCRIBE NEW BT'S WITNESS OBJECTS ETC. ESTABLISHED, OR WORK DONE TO PRESERVE EXISTING EVIDENCE

BTs have reqd. paint, signs & tags.

Work Done By F.S. Munro Title L.S. Date 9/18/82 State Registration No. 1832
or Agency

Certified Cor. Record Prepared ? Yes No Filed At: _____ Date _____

REMARKS

Index File No. V-17 T. 4S R. 30E M. W.M. Tract or Surv. No. _____ Cor. _____

Index
File No. V-17

CORNER RECORD (SEARCH)

(Ref. FSM 7151.4)

Tract or
Survey No. _____Cor.
No. _____

4-109

T 4 S. R. 30 E.

R.D. Ukiah County Umatilla

Merid. Willamette

N.F. Umatilla State Oregon

CORNER DIAGRAM

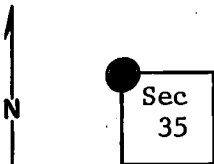

DESCRIBE CORNER MONUMENT FOUND

Basalt stone, 17"x8"x6" (Similar to GLO Notes), good condition (loose), 8" above ground.

2 notches on east, 1 notch on south (fits GLO) (in circle of smaller stones)

Monumented By BLM, 1978

DESCRIBE BEARING TREES OR OTHER OFFICIAL ACCESSORIES FOUND

A badly rotted stump (which I believe to be fir) bears N. 30°E., approx. 25' (fits GLO).

A 28" p. pine bears S. 50°E., approx. 25'. Scribing visible. (Dist. fits GLO notes. GLO notes state bearing is S. 50°E. Original bearing appears erroneous.) Tree stands in jog in fence line. (cont. in block 12)

DESCRIBE CORNER LOCATION RELATIVE TO NEAR-BY FEATURES, ALSO HOW TO REACH CORNER

Stone mound sets in north-south fence (forest boundary) about 100 ft. north of small ravine.

PHOTO IDENTIFICATION DATA

Photo No. _____

Filed At. _____

Object Ident. _____

Ident. By _____

Signature

PLANE COORDINATE POSITION DATA

State _____ Zone _____

X _____

Y _____

Estab. By _____

Agency

Signature

T. Hollamon

Title

Eng. Tech.

Division

Headquarters

S.O.

Date

5/8/74

7100-52-(3/68)

5

CORNER RECORD (PERPETUATION)

MONUMENT: DESCRIBE NEW MONUMENT SET, OR WORK DONE TO PRESERVE EXISTING MONUMENT

9

ACCESSORIES : DESCRIBE NEW BT'S WITNESS OBJECTS ETC. ESTABLISHED, OR WORK DONE TO PRESERVE EXISTING EVIDENCE

Placed a blank B.T. tag on each of the apparent B.T. stumps and also on the 2 B.T.'s.

10

Work Done By _____ Title _____ Date _____ State Registration No. or Agency _____

Certified Cor. Record Prepared ? Yes No Filed At: _____ Date _____ 11

REMARKS

(3 cont) A fire stump, 31" top diam., bears S. 66°W., approx. 36 ft. (fits GLO). Tree recently cut and removed. A 17" p.pine bears N. 14°W., approx. 27 ft. (fits GLO) scribed T4S., R30E., S27. Location poster on 4" p.pine approx. 20 ft. NW of stone mound. The 2 standing B.T.'s have "Attention" (Warning against destruction) metal tags. Also same tag on a 20" p. pine in fence line 10 ft. north.

12

Index File No. T. R. M. Tract or Surv. No. Cor. 13