

Index
 File No. T-25
 T 45 R. 30&31E
 Merid. Willamette

CORNER RECORD (SEARCH)
 (Ref. FSM 7151.4)

Tract or Survey No. _____ Cor. No. _____
 R.D. Ukiah County Umatilla
 N.F. Umatilla State Oregon

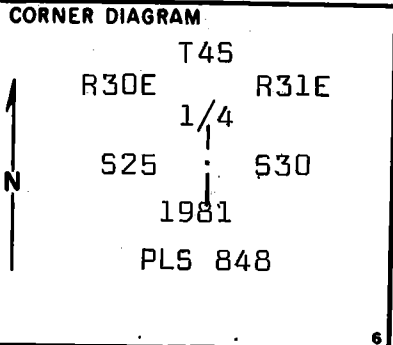

DESCRIBE CORNER MONUMENT FOUND

Corner has been destroyed by fence construction.

DESCRIBE BEARING TREES OR OTHER OFFICIAL ACCESSORIES FOUND

No bearing trees previously established. Positioned corner by proportion from found corners 1/2 mile North and 1/2 mile South.

PHOTO IDENTIFICATION DATA

Photo No. _____
 Filed At. _____
 Object Ident. _____
 Ident. By _____
 Signature _____

DESCRIBE CORNER LOCATION RELATIVE TO NEAR-BY FEATURES, ALSO HOW TO REACH CORNER

Corner is on NE side of gentle open SE draw, approx. 250 ft. from draw bottom Ridge road approx. 250 ft. North from corner. Corner is visible from road.

PLANE COORDINATE POSITION DATA

State _____ Zone _____
 X _____
 Y _____
 Estab. By _____
 Agency _____

Signature Douglas M. Ferguson

Title PLS 848 Division _____ Headquarters Mt. Vernon, OR Date 7/29/81
 7100-52-(3,68)

CORNER RECORD (PERPETUATION)

MONUMENT: DESCRIBE NEW MONUMENT SET, OR WORK DONE TO PRESERVE EXISTING MONUMENT

Set 3"x30" galv. iron pipe with 3" brass cap stamped as shown on the diagram; set 10 inches in the ground and raised a mound of stone around the pipe.

ACCESSORIES : DESCRIBE NEW BT's WITNESS OBJECTS ETC. ESTABLISHED, OR WORK DONE TO PRESERVE EXISTING EVIDENCE

No bearing trees available.
Set steel posts with warning and boundary signs 7.0 ft. North and 6.2 ft. West from corner.

Work Done By D.M. Ferguson Title Surveyor Date 7/29/81 State Registration No. OR PLS 848
or Agency

Certified REGISTERED Deposed? Yes No Filed At: Umatilla Co. Surveyor Off. Date

PROFESSIONAL
LAND SURVEYOR

REMARKS

Witnesses to above corner:

D. Mitchell Ferguson
Mike Woodward

OREGON
JULY 12, 1968
DOUGLAS M. FERGUSON
848

Index

File No. T-25

CORNER RECORD (SEARCH)

(Ref. FSM 7151.4)

Tract or
Survey No. _____Cor.
No. _____

4-113

T 4 S. R. 30 E. R.D. Ukiah County UmatillaMerid. Willamette N.F. Umatilla State Oregon

CORNER DIAGRAM



DESCRIBE CORNER MONUMENT FOUND

Stone mound.

No marking visible. Mound sets 2 ft. east of fence corner.

DESCRIBE BEARING TREES OR OTHER OFFICIAL ACCESSORIES FOUND

Fence runs south and west from stone mound. Very large rock jack at corner. $\frac{1}{4}$ stone may be among these.

Very old location poster on nearby fence post, also a newer Oregon State Board of Forestry location poster.

No B.T.'s were set. Location is in open area.

DESCRIBE CORNER LOCATION RELATIVE TO NEAR-BY FEATURES, ALSO HOW TO REACH CORNER

Location is approx. 200 ft. south of road between Highway 395 and Log Spring - about 3.7 miles west of highway.

PHOTO IDENTIFICATION DATA

Photo No. _____

Filed At. _____

Object Ident. _____

Ident. By _____

Signature

PLANE COORDINATE POSITION DATA

State _____ Zone _____

X _____

Y _____

Estab. By _____

Agency

Signature

T, Hollamon

Title

Eng, Tech,

Division

Headquarters

S, O,

Date

5/10/74

7100-52-(3/68)

5

CORNER RECORD (PERPETUATION)

MONUMENT : DESCRIBE NEW MONUMENT SET, OR WORK DONE TO PRESERVE EXISTING MONUMENT

ACCESSORIES : DESCRIBE NEW BT's WITNESS OBJECTS ETC. ESTABLISHED, OR WORK DONE TO PRESERVE EXISTING EVIDENCE

Work Done By. _____ **Title** _____ **Date** _____ **State Registration No.** _____
or Agency _____

Certified Cor. Record Prepared ? Yes No **Filed At:** _____ **Date** _____

REMARKS

Index File No. _____ **T.** _____ **R.** _____ **M.** _____ **Tract or Surv. No.** _____ **Cor.** _____