

OREGON CORNER RESTORATION FORM

Section 4 Township 3N Range 29E  
 County Umatilla Date: 05-09-02

Corner Designation: 3N29A11

Condition Report Only  
 Not Found  
 Remonumented  
 Unrecorded  
 Surveyed In  
 Referenced Out

Previous Renewals / Surveys, etc.

Survey 95-60-B records setting a brass cap here.

Monument and Accessories Found: ( condition and source )

Found brass capped monument above in good condition stamped as shown in the diagram.

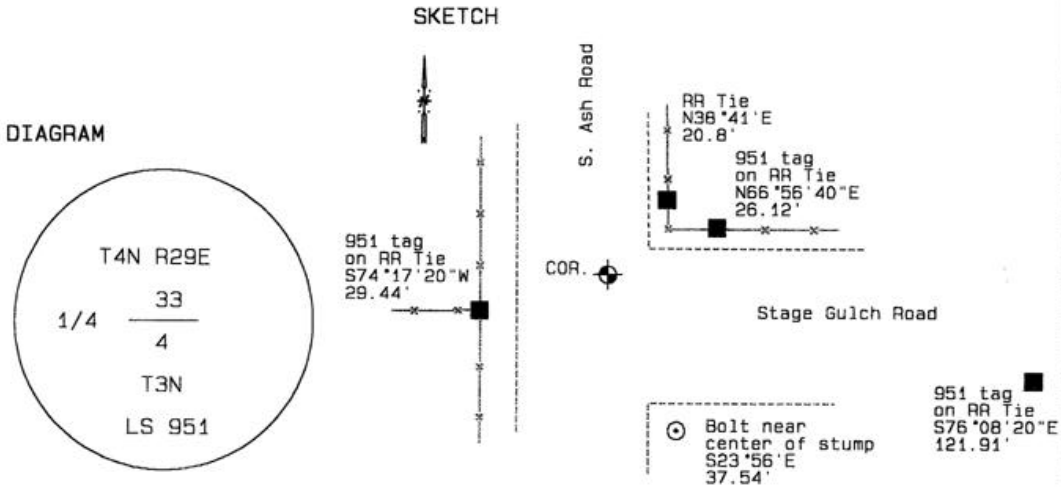

MONUMENT (S) AND ACCESSORIES SET (Procedures and Description)

None.

REFERENCES SET:

None.

Made GPS tie to TRI Station Echo.	Oregon State Plane Coord. - North Zone
Latitude 45°46'37.36274"N	Northing 772093.54
Longitude 119°11'41.06022"W	Easting 8535123.91
NAD 83(1991)	Ortho Height 650.02
	Ellipsoidal Height 580.48

Location and Comments

Compass Declination  
 20°E

Surveyors Seal

From Stanfiled, take Stage Gulch Road east to junction of South Ash Road. Monument is buried approximately 6" below the road surface.

REGISTERED  
 PROFESSIONAL  
 LAND SURVEYOR

RECEIVED BY:

Firm / Agency

*David L. Haddock*

Date: 6-03  
 Rec'd By: KE  
 No. 02-167-9

Haddock Surveying  
 P. O. Box 1574  
 Pendleton, OR 97801  
 (541) 276-2174

OREGON  
 JULY 12, 1968  
 DAVID L. HADDOCK  
 852

RENEWS 6-30-03