

# OREGON CORNER RESTORATION FORM

SECTION 26 TOWNSHIP 4 NORTH RANGE 29 EAST V-21  
 COUNTY : UMATILLA DATE 8-98

CORNER DESIGNATION

SE CORNER

- CONDITION REPORT ONLY
- NOT FOUND
- RENEWED
- UNCOVERED
- SURVEYED IN
- REFERENCED

PREVIOUS RENEWALS / SURVEYS, ETC.

ORIGINALLY SURVEYED IN 1861 BY DAVENPORT UNDER CONTRACT #101. HE SET A POST IN A MOUND OF EARTH AND A CHARRED STAKE.

MONUMENTS AND ACCESSORIES FOUND: CONDITION AND SOURCE

NOTHING

SKETCH

MONUMENT DETAIL

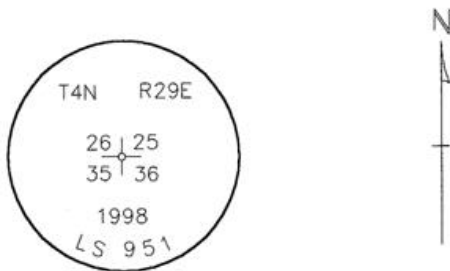

MONUMENT SET ( PROCEDURES AND DESCRIPTION )

BY PROPORTION NORTH AND SOUTH AND USING THE FENCE LINE FOR EASTINGS, (WHICH IS WITHIN A FOOT OF PROPORTION) I SET 1" X 30" IRON PIPE WITH A 2 3/8" BRASS CAP STAMPED AS ABOVE.

NEW ACCESSORIES FROM WHICH

AN ALUMINUM TAG #951 ON A ROUND GATE POST LIES N 0°.34'00" W, 53.22 FEET.  
 AN ALUMINUM TAG #951 ON A ROUND FENCE CORNER LIES N 0°.40'30" W, 32.66 FEET.  
 A T-POST FENCE POST WHICH IS 18" BELOW THE TOP WIRE AND PAINTED RED LIES N 31°.52'00" W, 38.42 FEET.  
 A 5/8" X 30" IRON REBAR WITH PLASTIC CAP #951 LIES N 3°.28'02" E, 33.07 FEET.

LOCATION AND COMMENTS

COMPASS DEC.

SURVEYOR'S SEAL

FIRM/AGENCY  
 EDWARDS SURVEYING  
 P.O. BOX 763  
 HERMISTON, OREGON 97838  
 97838

PARTY CHIEF  
 D. EDWARDS

NOTES

WITNESS  
 CURTIS J. FAVOREL

RECEIVED BY  
 Umatilla County Surveyor  
 Date 10-98  
 Rec'd By JK  
 No. 98-213-C

REGISTERED  
 PROFESSIONAL  
 LAND SURVEYOR

*G. Dennis Edwards*

OREGON  
 JULY 16, 1971  
 G. DENNIS EDWARDS  
 951  
 RENEWS 12/31/99