

OREGON CORNER RESTORATION FORM

SECTION 27,26 TOWNSHIP 4 NORTH RANGE 29 EAST T-17
 COUNTY : UMATILLA DATE 11/01

CORNER DESIGNATION

1/4 CORNER

CONDITION REPORT ONLY
 NOT FOUND
 RENEWED
 UNCOVERED
 SURVEYED IN
 REFERENCED

PREVIOUS RENEWALS / SURVEYS, ETC.

ORIGINALLY SURVEYED IN 1861 BY DAVENPORT UNDER CONTRACT #101. HE SET A POST IN A MOUND OF EARTH AND A CHARRED STAKE.
 IN 1998 EDWARDS SET A 5/8" x 24" IRON ROD WITH A 2" ALUM. CAP.

MONUMENTS AND ACCESSORIES FOUND: CONDITION AND SOURCE

AN ALUMINUM TAG #951 ON A R x R TIE GATE POST LIES N 87°43'20" E, 18.68 FEET.
 AN ALUMINUM TAG #951 ON A POWER POLE LIES S 39°59'40" W, 25.84 FEET.
 AN ALUMINUM TAG #951 ON A TELEPHONE POLE LIES S 39°56'35" E, 28.32 FEET.

MONUMENT DETAIL

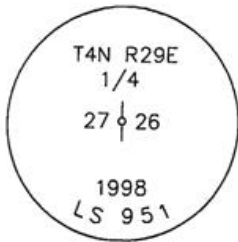

NAD 83/91
 OREGON STATE PLANE
 INTERNATIONAL FEET

780251.0423
 8542890.2221

SKETCH

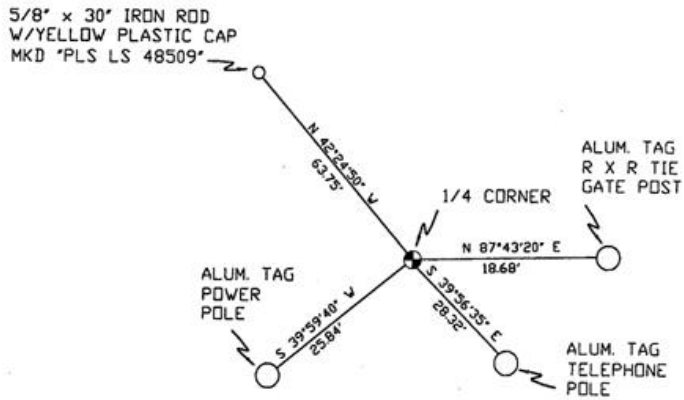

MONUMENT SET (PROCEDURES AND DESCRIPTION)

NEW ACCESSORIES FROM WHICH

A 5/8" x 30" IRON ROD WITH A YELLOW PLASTIC CAP MKD "PLS LS 48509" LIES N 42°24'50" W, 63.75 FEET.

LOCATION AND COMMENTS

FROM INTERSECTION OF FEEDVILLE ROAD WITH LOOP ROAD GO 1/2 MILE SOUTH AND 1/2 MILE WEST TO CORNER.

COMPASS DEC.

FIRM/AGENCY
 PRIMM LAND SURVEYING
 P.O. BOX 1322
 HERMISTON, OREGON 97838

SURVEYOR'S SEAL

REGISTERED
 PROFESSIONAL
 LAND SURVEYOR

PARTY CHIEF
 KEITH P. PRIMM

RECEIVED BY

BRIT L. PRIMM
 OREGON
 JULY 13, 1999
 BRIT L. PRIMM
 48509

NOTES

Umatilla County Surveyor

WITNESS

Date 12-01
 By KE

EXPIRATION DATE: 12/31/02

BRIT L. PRIMM

No. 01-213-9