

OREGON CORNER RESTORATION FORM

Section 3 Township 3N Range 28E
 County Umatilla Date: 06-14-02

Corner Designation: 3N28A13

<input checked="" type="checkbox"/> <u> </u> <input type="checkbox"/> <u> </u> <input type="checkbox"/> <u> </u> <input type="checkbox"/> <u> </u> <input type="checkbox"/> <u> </u>	Condition Report Only Not Found Remonumented Unrecorded Surveyed In Referenced Out
---	---

Previous Renewals / Surveys, etc.
 Survey S-156-C reported setting a brass capped monument here.

Monument and Accessories Found: (condition and source)
 Found the monument loose on the ground about 50 feet southwest of a fence corner near an irrigation structure. The area is subject to blowing sand erosion.

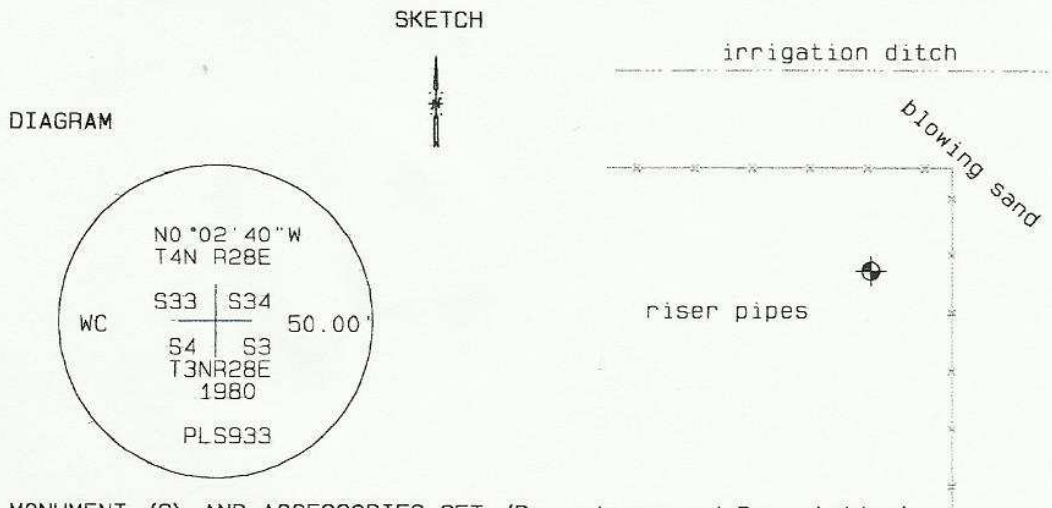

MONUMENT (S) AND ACCESSORIES SET (Procedures and Description)

None.

REFERENCES SET:

None.
 Made GPS tie to TRI Station
 No tie made. Could not determine correct corner location.

Location and Comments Compass Declination

From the junction of I84 and Highway 207, go ^{20°E} south 0.6 miles. Take a road through a stock yard east 0.1 mile and cross the ditch. Follow a circle road northeasterly 0.3 mile to a fence. Cross the fence to the east and go about N30°E to a fence corner. The blown out corner was here somewhere.

Surveyors Seal

REGISTERED
 PROFESSIONAL
 LAND SURVEYOR

David L. Haddock

OREGON
 JULY 12, 1968
 DAVID L. HADDOCK
 852

RECEIVED BY:

Date: 7-02
 Rec'd By: KE
 No. 02-185-9

Firm / Agency

Haddock Surveying
 P. O. Box 1574
 Pendleton, OR 97801
 (541) 276-2174