

CERTIFIED RECORD OF LAND CORNER MONUMENTATION

T 4N, R 37E., W.M.

Corner Code No. Z-13

Note: Monument marked as shown below

History of original corner establishment:

This corner was originally established by George S. Pershin, U.S. Deputy Surveyor, under Contract No. 304, dated September 19, 1878.

The original notes state:

Set Fir post on level for corner to Sections 3, 4, 33, and 34 from which:

- A tamarack 12 in. diam. brs N 34° E 54 lks. dist.
- A tamarack 11 in. diam. brs S 46° E 20 lks. dist.
- A fir 18 in. diam. brs S 52° W 43 lks. dist.
- A tamarack 14 in. diam. brs N 62° W 31 lks. dist.

In 1978, Douglas M. Ferguson recovered a 24" by 10" by 4" stone set 14" in the ground and after making a thorough search of the area, determined the stone to be a perpetuation of the original corner location. See corner certificate G-737.

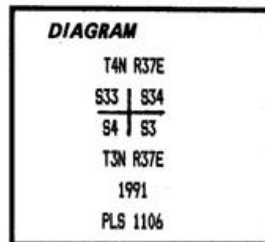

Corner No.
Compass Declination: 18.0°

Description of corner evidence found:

Found 24" by 10" by 4" painted stone, set 14" in the ground.

I searched for original bearing tree evidence for approximately 1 1/4 hours without success, and accept the found stone as a perpetuation of the original corner location.

Description of monument and accessories I established to perpetuate the original location of this corner:

At the position of the center of the found stone, set a 2 1/2" brass cap on a 1 1/4" by 30" galvanized iron pipe 24" in ground, and surrounded with a mound of earth. Placed found stone in the new mound on the East side of the new monument.

Marked four new bearing trees:

- A 5" western larch bears N 09 1/2° E 40.2' scribed "X" at breast height and "BT" at base of tree.
- A 12" alpine fir bears S 29 1/2° E, 75.1', scribed T3N R37E S3 BT.
- A 6" white fir bears S 35° W, 14.2', scribed T3N R37E S4 BT.
- A 15" western larch bears N 73 1/2° W, 29.6', scribed T4N R37E S33 BT.

Placed bearing object signs on each of the new bearing trees.

Set steel fence post North of corner and attached a witness corner sign.

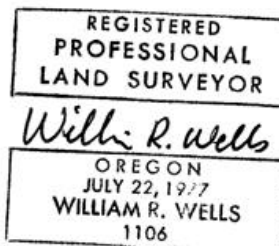

Office of..... County of.....
State of....., I hereby certify that the within instrument was filed in this office
for record on the..... day of....., 19.....

..... by
(COUNTY OFFICIAL) (DEPUTY)

Form R6-7100-57 (9/71)

RECEIVED BY

☆ GPO—798-276

Umatilla County Surveyor

Date 9-91

Rec'd By KE

No. 91-25-C