

OREGON CORNER RESTORATION FORM

Section 31 Township 3N Range 33E
 County Umatilla Date: May 5, 2001

Corner Designation: 3N33X3

The center 1/4 corner to section 31, T3N, R33E,
 W.M., Umatilla County, Oregon.

Previous Renewals / Surveys, etc.

John Kimbrell reports setting a temporary corner here in surveys filed in Book 1 of the record of private surveys at pages 526 and 542. He does not say he ever set a permanent corner mark.

Monument and Accessories found: (condition and source)
 None.

Condition Report Only
 Not found
 Remonumented
 Unrecorded
 Surveyed in
 Referenced out

DIAGRAM

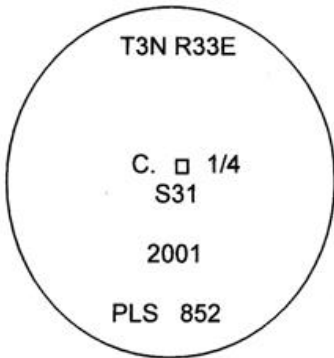

SKETCH

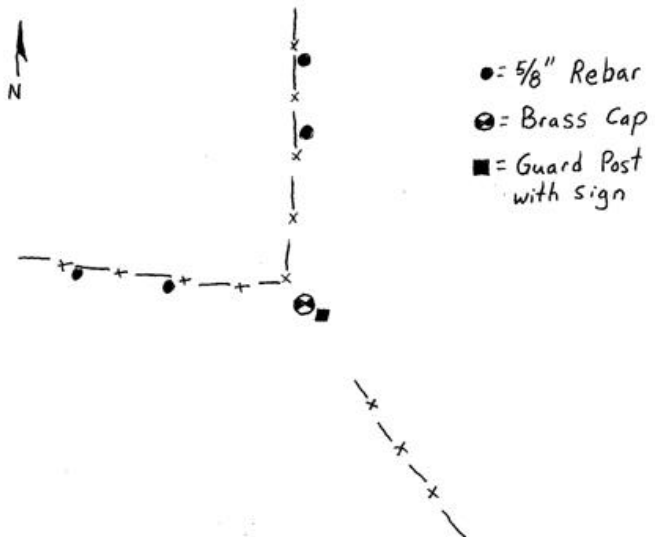

MONUMENT (S) AND ACCESSORIES SET (Procedures and Description)

Set a 1 1/2" x 30" galvanized iron pipe with a 2 1/4" brass cap stamped as shown in the diagram above at the true corner point. Raised a mound of stone with a 2 1/2 foot base by 1 foot high around the monument. Set a 6 foot steel post with a County monument sign attached along side.

For references, I set four, 5/8" by 24" rebars with 1.25" red plastic caps stamped ORLS 852 and WAL5 13922 as described below:

- an iron rebar bears N2°06'36"W, 74.81 feet under the existing fence;
- an iron rebar bears N1°33'46"W, 40.02 feet under the existing fence;
- an iron rebar bears N86°40'32"W, 71.73 feet under the existing fence;
- an iron rebar bears N85°16'54"W, 43.82 feet under the existing fence;

The monument and references were tied using a LIECA system 300 RTK GPS.

Location and comments

Compass Declination

Surveyors Seal

RECEIVED BY:
 Umatilla County Surveyor
 Date: 6-01
 Rec'd By: RF
 No. 01-81-C

Firm / Agency
 Haddock Surveying
 Address
 P.O. Box 1574
 Pendleton, Or. 97801
 Party Chief
 Stephen K, Haddock

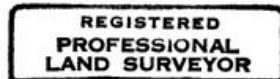

David L. Haddock

