

**OREGON CORNER RECORATION FORM**

Section 27 Township 3N Range 32E  
 County Umatilla Date: September 30, 2006

Corner Designation: 3N32V13

Corner to sections 27, 28, 33, and 34, T3N, R32E,  
 W.M., Umatilla County, Oregon.

Condition Report Only  
 Not found  
 Remonumented  
 Unrecorded  
 Surveyed in  
 Referenced out

Previous Renewals / Surveys, etc.

Corner originally set by Daniel Chaplin under contract No. 107 dated September 21, 1864. His record reads: Set post for corner to Secs. 33, 34, 27 & 28 in mound of earth with charred stake, pits &c as per instructions.

Monument and Accessories found: ( condition and source )  
 None. The position falls in the asphalt of State Highway 37.

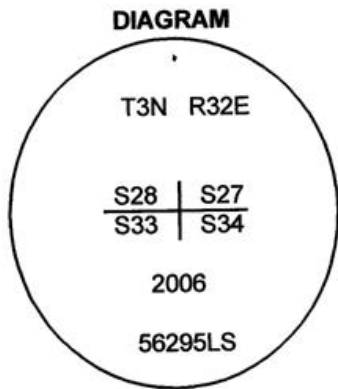

○ = Rail Road Spike  
 ● = Rebar Reference

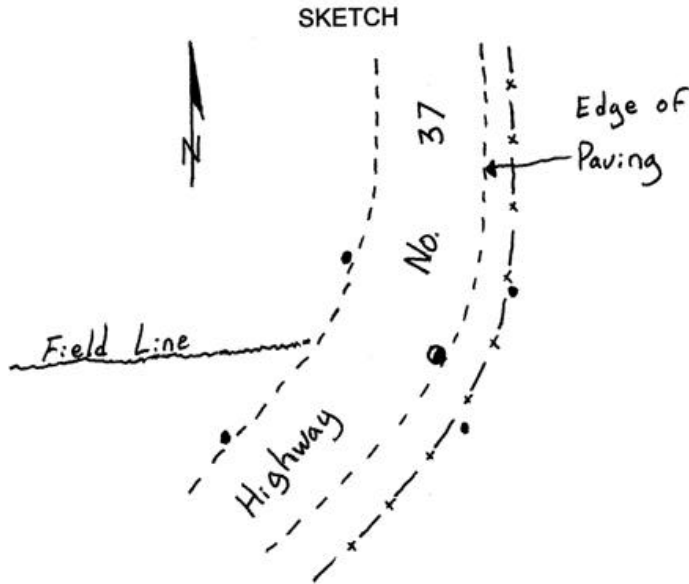

**MONUMENT (S) AND ACCESSORIES SET (Procedures and Description)**

At the intersection of the State Highway centerline from the north and the field lines to the west I set a railroad spike in the asphalt stamped with an "+" and the section numbers.

For references, I set four, 5/8" by 24" rebars with 1 1/8" orange plastic caps attached, stamped WTS and 56295LS as described below:

- an iron rebar bears N27°23'19"W, 65.44 feet;
- an iron rebar bears N32°02'51"E, 35.64 feet;
- an iron rebar bears S16°54'51"E, 35.88 feet;
- an iron rebar bears S47°52'24"W, 57.33 feet;

The monument and references were tied using a Trimble R7/R8 RTK GPS.

Location and comments

Compass Declination

Firm / Agency  
 Witness Tree Surveying  
 Address  
 P.O. Box G  
 Pilot Rock, Or. 97868  
 Party Chief  
 Stephen K, Haddock

RECEIVED BY:  
Umatilla County Surveyor  
 Date: 12-06  
 Rec'd By: \_\_\_\_\_  
 No. 06-606c

Surveyors Seal

REGISTERED  
 PROFESSIONAL  
 LAND SURVEYOR

*Stephen K. Haddock*

OREGON  
 JULY 9, 2001  
 STEPHEN K. HADDOCK  
 56295LS

RENEWAL DATE 6-30-07