

**OREGON CORNER RESTORATION FORM**

Section 13 Township 3N Range 32E  
 County Umatilla Date: October 10, 2006

Corner Designation: 3N32J23

Quarter corner to sections 12 and 13, T3N, R32E,  
 W.M., Umatilla County, Oregon.

Previous Renewals / Surveys, etc.

Corner originally set by Daniel Chaplin under contract No. 107 dated September 21, 1864. His record reads: Set post for 1/4 Sec. cor. in mound of earth with charred stake, pits &c as per instructions.

Monument and Accessories found: ( condition and source )

A decayed wooden post at the corner of a three way fence intersection with fences running east, west and south. The berms under the fences indicate that the fences have been in this location for a long time.

Condition Report Only  
 Not found  
 Remonumented  
 Unrecorded  
 Surveyed in  
 Referenced out

**DIAGRAM**

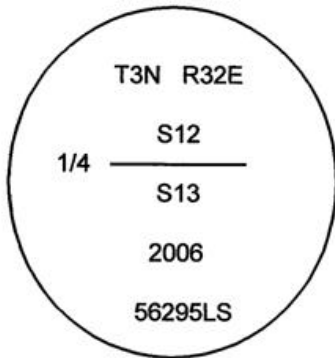

**SKETCH**

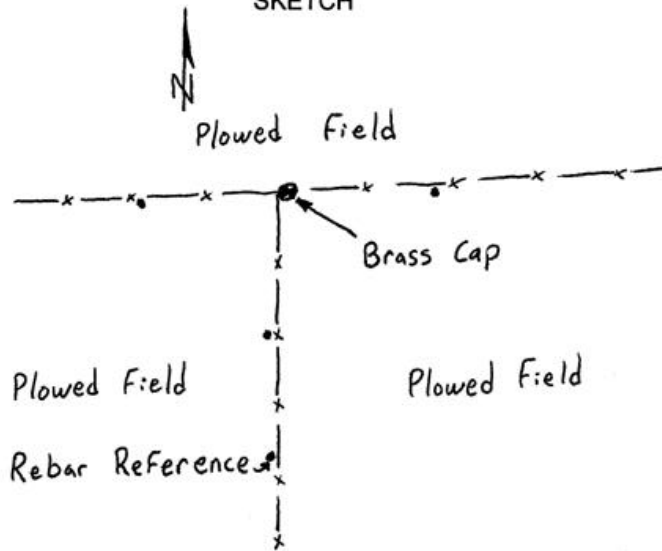

**MONUMENT (S) AND ACCESSORIES SET (Procedures and Description)**

I set a 1 1/4" x 30" galvanized iron pipe with a 2 3/8" brass cap stamped as shown in the diagram above in the decayed post at the existing fence corner.

For references, I set four 5/8" by 18" rebars with 1 1/8" orange plastic caps stamped WTS and 56295LS 18" below the surface as described below:

- an iron rebar bears S87°35'34"W, 25.96 feet;
- an iron rebar bears N89°12'32"E, 58.82 feet;
- an iron rebar bears S02°51'01"W, 27.86 feet;
- an iron rebar bears S01°12'07"W, 64.61 feet;

The monument and references were tied using a Trimble R7/R8 RTK GPS.

Location and comments

Compass Declination

Firm / Agency  
 Witness Tree Surveying  
 Address  
 P.O. Box G  
 Pilot Rock, Or. 97868  
 Party Chief  
 Stephen K, Haddock

RECEIVED BY:  
Umatilla County Surveyor  
 Date: 12-06  
 Rec'd By: \_\_\_\_\_  
 No. 06-606-C

Surveyors Seal

REGISTERED  
 PROFESSIONAL  
 LAND SURVEYOR

*Stephen K. Haddock*

OREGON  
 JULY 9, 2001  
 STEPHEN K. HADDOCK  
 56295LS

RENEWAL DATE 6-30-07