

OREGON CORNER RESTORATION FORM

COUNTY: Umatilla DATE: 04/19/06

CORNER DESIGNATION: 3N31, R-23, The South One-Quarter Corner of Section 24.

PREVIOUS RENEWALS/SURVEYS ETC.: Corner originally established by D.S. Payne, under Contract No. 100, dated August 1, 1861. Record states: Set charred stake with mound, trench and pits as per insts. for qr. sec. corner.

MONUMENT AND ACCESSORIES FOUND: None.

MONUMENT MARKING DETAIL:

T3N R31E
1 S24
4 S25
2006
PLS 1106

MONUMENT SET:

Re-established corner by single proportionate measure between the reestablished Southwest and Southeast corners of Section 24. At reestablished corner point, set a 2 3/8" brass cap on 1 1/4" x 30" galvanized iron pipe with cap 15" below ground level. Monument marked as shown in monument marking detail.

From which:

- A silver Deep-1 magnet buried 22" below ground level bears North 16 1/2° East, 35.6 feet.
 - A blue Deep-1 magnet buried 22" below ground level bears South 75° East, 35.4 feet.
 - A purple Deep-1 magnet buried 22" below ground level bears South 11 1/2° West, 36.8 feet.
 - An orange Deep-1 magnet buried 22" below ground level bears North 72° West, 35.0 feet.
- Buried bearing object signs with magnets.

LOCATION AND COMMENTS: Corner is located in a actively farmed field. No other features nearby.

OREGON STATE PLANE COORDINATE, North Zone, NAD 83(91), International Feet:

N = 752067.47
E = 8615498.26

FIRM: William R. Wells, PLS
P.O. Box 1696
Pendleton, OR 97801

COMPASS DECLINATION: 18° East

Surveyor's Seal

Witnesses: Jason Wells, LSIT

/3N31R23

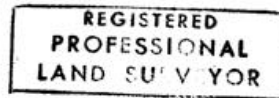

William R. Wells

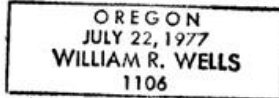

renews 6-30-08