

**OREGON CORNER RESTORATION FORM**

Section 23 Township 3N  
County Umatilla Date: 09/30/09

Range 29E

Corner Designation: 3N29R1

1/4 corner common to sections 23 and 26, T3NR29E.

- Condition Report Only
- Not Found
- Remonumented
- Unrecorded
- Surveyed In
- Referenced Out

**Previous Renewals / Surveys, etc.**

Originally Surveyed by Gates in 1859. He set a post in a mound of earth. Krumbein set a 2 1/2" Brass cap in 1972.

**Monuments and Accessories Found: (Condition and Source)**

A 2 1/2" Brass cap witness corner lies West, 30.00 feet.  
A 2 1/2" Brass cap witness corner lies East, 30.00 feet.

Diagram

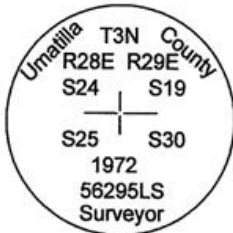

Sketch

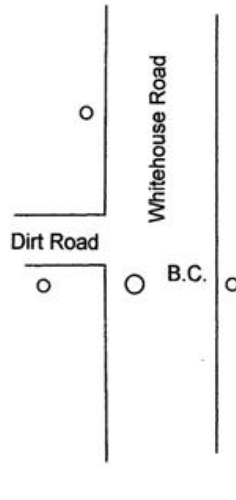

NAD 83/91  
OREGON STATE PLANE NORTH  
INTERNATIONAL FEET

N750503.57  
E8521751.04

LAT - 45° 43' 06.32236" N  
LON - 119° 14' 54.43797" W

**Monument (s) Set (Procedures and Description)**

None.

**References Set:**

A 5/8" Iron rebar w/ypc #43406 under the fence lies N 5°00' W, 80.13'.  
A pk nail w/ brass washer #43406 on a power pole lies S 23°15' E, 104.14'.

**Location and Comments**

From the intersection of Hwy. 320 and Whitehouse Road, go .5 miles South.

**Compass Declination**  
17° E

**Surveyors Seal**

REGISTERED  
PROFESSIONAL  
LAND SURVEYOR

*Robert Douglas English*  
OREGON  
JANUARY 11, 2005  
ROBERT DOUGLAS ENGLISH  
43406LS

**RECEIVED BY:**

**Firm / Agency**

Date: 1-11  
Rec'd By: KK  
No. 11-12-R

Survey One, LLC.  
P.O. Box 382  
Pendleton, OR 97801  
(541) 276-2055

RENEWAL DATE: 12/31/09