

OREGON CORNER RESTORATION FORM

Section 23 Township 3N
County Umatilla Date: 09/30/09

Range 29E

Corner Designation: 3N29R14

1/4 corner common to sections 23 and 26, T3NR29E.

- Condition Report Only
- Not Found
- Remonumented
- Unrecorded
- Surveyed In
- Referenced Out

Previous Renewals / Surveys, etc.

Originally Surveyed by Gates in 1859. He set a post in a mound of earth. Krumbain set a 2 1/2" Brass cap in 1972.

Monuments and Accessories Found: (Condition and Source)

A 2 1/2" Brass cap witness corner lies West, 30.00 feet.
A 2 1/2" Brass cap witness corner lies East, 30.00 feet.

Diagram

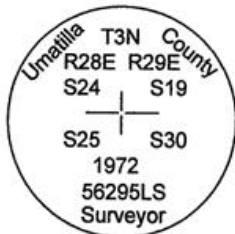

Sketch

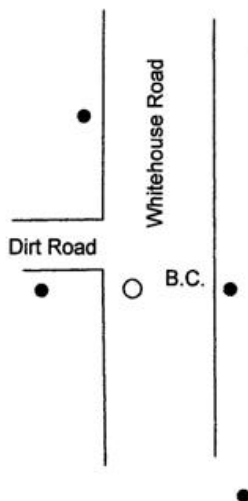

NAD 83/91
OREGON STATE PLANE NORTH
INTERNATIONAL FEET

N758499.05
E8521609.88

LAT - 45° 44' 25.56897" N
LON - 119° 14' 54.67499" W

Monument (s) Set (Procedures and Description)

None.

References Set:

A 5/8" Iron rebar w/ypc #43406 under the fence lies N 5°00' W, 80.13'.
A pk nail w/ brass washer #43406 on a power pole lies S 23°15' E, 104.14'.

Location and Comments

From the intersection of Hwy. 320 and Whitehouse Road, go .5 miles South along Whitehouse Road..

Compass Declination

17° E

Surveyors Seal

REGISTERED
PROFESSIONAL
LAND SURVEYOR

Robert D. English
OREGON
JANUARY 11, 2005
ROBERT DOUGLAS ENGLISH
43406LS

RECEIVED BY:

Date: 10-09
Rec'd By: KE
No. 09-146-R

Firm / Agency

Survey One, LLC.
P.O. Box 382
Pendleton, OR 97801
(541) 276-2055

RENEWAL DATE: 12/31/09