

# OREGON CORNER RESTORATION FORM

Section 6 Township 3N Range 29E  
 County Umatilla Date: 05-09-02

Corner Designation: 3N29A3

	Condition Report Only
	Not Found
	Remonumented
	Unrecorded
X	Surveyed In
	Referenced Out

**Previous Renewals / Surveys, etc.**

Surveys S-158-C and 88-57-B both record they set a brass cap at this corner. Survey 95-60-B records finding this brass cap.

**Monument and Accessories Found: ( condition and source )**

Found a brass capped monument stamped as shown in the diagram. Also found a railroad spike as shown in the drawing.

SKETCH

DIAGRAM

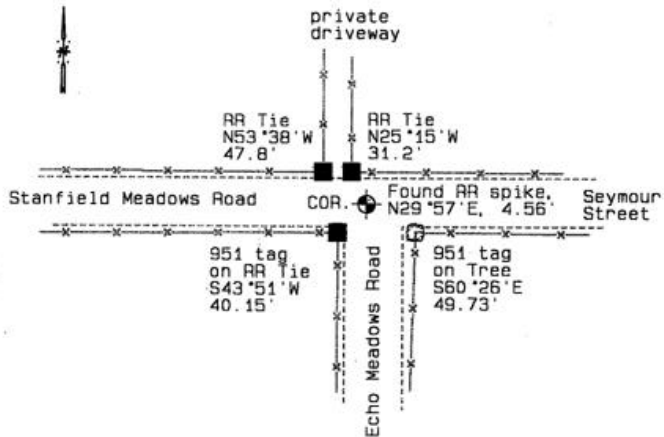
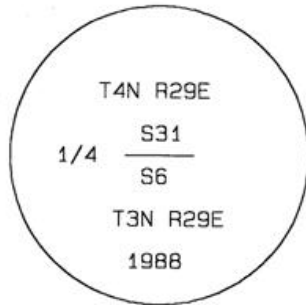

**MONUMENT (S) AND ACCESSORIES SET (Procedures and Description)**

None.

**REFERENCES SET:**

None.

Made GPS tie to TRI Station Echo.	Oregon State Plane Coord. - North Zone
Latitude 45°46'36.75848"N	Northing 771865.13
Longitude 119°14'09.44102"W	Easting 8524609.67
NAD 83(1991)	Ortho Height 586.74
	Ellipsoidal Height 517.01

Location and Comments	Compass Declination	Surveyors Seal
	20 °E	

From the stop light in Stanfield, go west on Seymour Street. Cross the river to the point where the road heads west. From this point, go west approximately 0.4 miles. The corner monument is in the center of the junction with the Echo Meadow Road.

REGISTERED  
 PROFESSIONAL  
 LAND SURVEYOR

RECEIVED BY: \_\_\_\_\_ Firm / Agency

*David L. Haddock*

Date: 6-02  
 Rec'd By: [Signature]  
 No. 02-169-9

Haddock Surveying  
 P. O. Box 1574  
 Pendleton, OR 97801  
 (541) 276-2174

OREGON  
 JULY 12, 1968  
 DAVID L. HADDOCK  
 852