

OREGON CORNER RESTORATION FORM

Section 1
County Umatilla

Township 3N
Date: 12/31/08

Range 29E

Corner Designation: 3N29A25

Section corner common to sections 36, T4NR29E, 1, T3NR29E, 32, T4NR30E, 6, T3NR30E.

- Condition Report Only
- Not Found
- Remonumented
- Unrecorded
- Surveyed In
- Referenced Out

Previous Renewals / Surveys, etc.

Originally Surveyed by Gates in 1859. He set a post in a mound of earth.
In 1998 Edwards set a 1"x30" Iron pipe with a 2 3/8" B.C. by single proportion.
In 2001 Primm found a 2 3/8" B.C.
In 2002 Haddock found a 2 1/2" B.C.

Monuments and Accessories Found: (Condition and Source)

A 2 3/8" B.C.
An aluminum tag #951 and nail on a power pole lies N 45°00' W, 54.37'.
A 2" ALC #951 lies N 00°00' E, 137.00'
A 5/8" IR w/ypc #951 lies S 66°00' W, 43.33'.
An aluminum tag #952 and nail on a power pole lies S 71°00' W, 43.58'.

Diagram

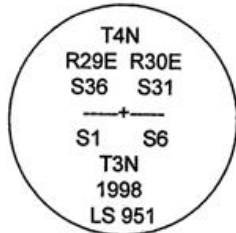

Alum. tag/nail
Power pole
N 45°00' W
54.37'

Alum. tag/nail
Power pole
S 71°00' W
43.58'

Sketch

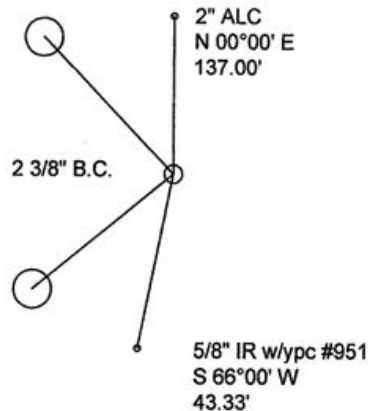

NAD 83/91
OREGON STATE PLANE NORTH
INTERNATIONAL FEET

N772526.75
E8553647.02

LAT - 45° 46' 38.60250" N LON - 119° 07' 19.64604" W

Monument (s) Set (Procedures and Description)

None.

References Set:

None.

Location and Comments

The corner lies 3.5 miles east from the intersection of S. Ash Rd. and Stage Gulch Rd. in Stanfield.

Compass Declination
17° E

Surveyors Seal

REGISTERED
PROFESSIONAL
LAND SURVEYOR

Robert D. English
OREGON
JANUARY 11, 2005
ROBERT DOUGLAS ENGLISH
43406LS

RENEWAL DATE: 12/31/09

RECEIVED BY:

Firm / Agency

Date: 1-11
Rec'd By: KS
No. 11-08-R

Survey One, LLC.
P.O. Box 382
Pendleton, OR 97801
(541) 276-2055